

22135 Yamaha MT-09/Tracer 9 Belly Pan Fitting Instructions

QTY	ID	Description	
1X	1,2,3	Mouldings (left, right and centre)	***
4X	4	Original Yamaha Bolt	***
1X	5	90° Square Bracket	***
1X	6	Left Fixing Bracket	***
2X	7	Right Fixing Bracket	***
4X	8	M6 x 20mm Bolt	***
4X	9	M5 x 15m Bolt	***
4X	10	M5 Nut	***
4X	11	M5 Washer	***
1X	12	M6 Clip Nut	***
4X	13	Rubber Silent Block	***
2X	14	190 x 80mm Metal Grid	***
2X	15	M5 Bolt	CBOLM50005
2X	16	M5 Washer	CWASM50001
2X	17	M5 Nut	CNUTM50002

Notes before fitting: If you would like to fit the metal grids supplied (ID.14) - use a pair of tin snips/heavy duty scissors and glue into place using a glue gun.

ID 15,16 & 17 are supplied for those who would like to mechanically fit the centre panel to the side panels - we recommend drilling two 5mm holes at the top edges of the centre panel in this instance.

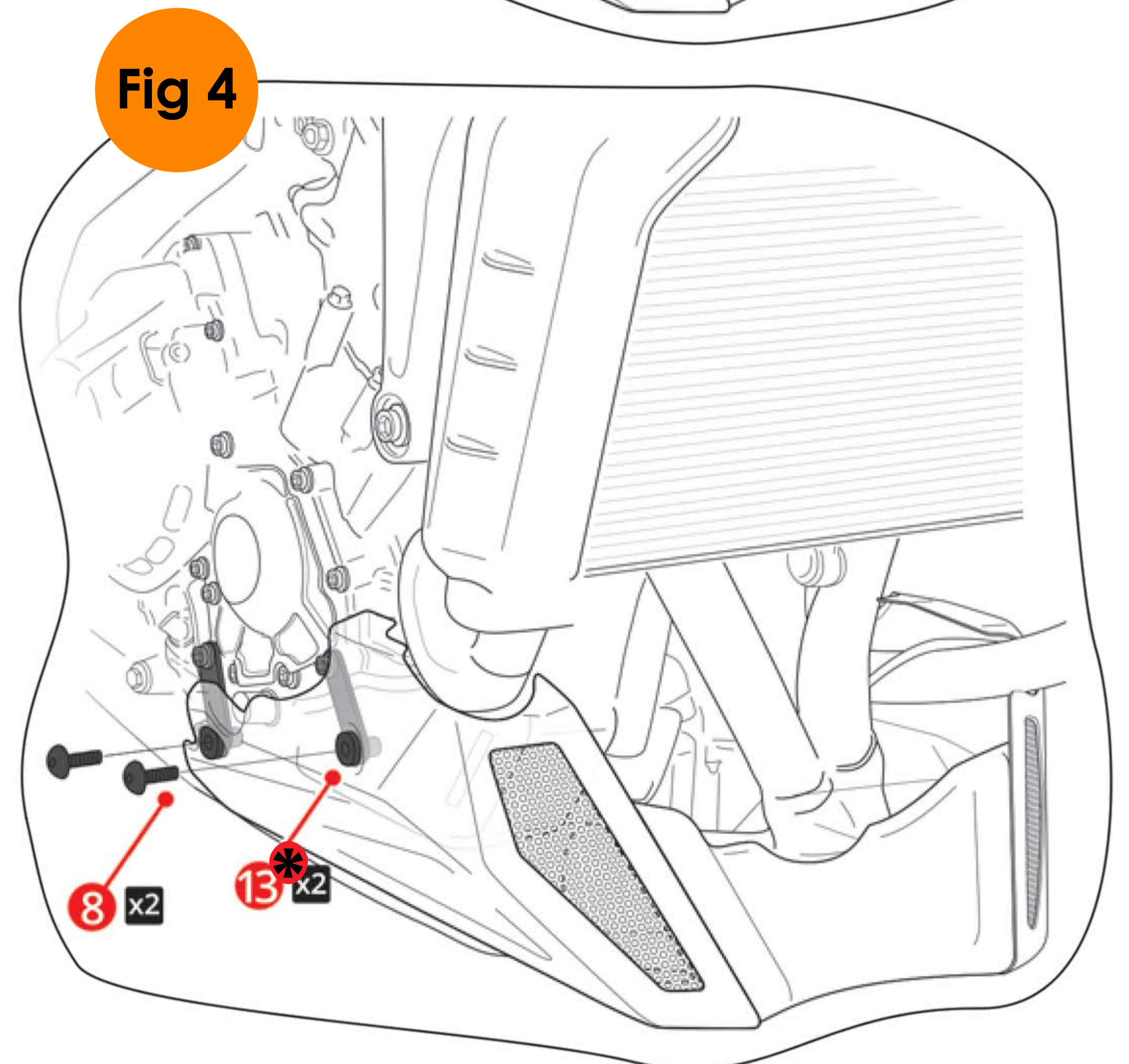
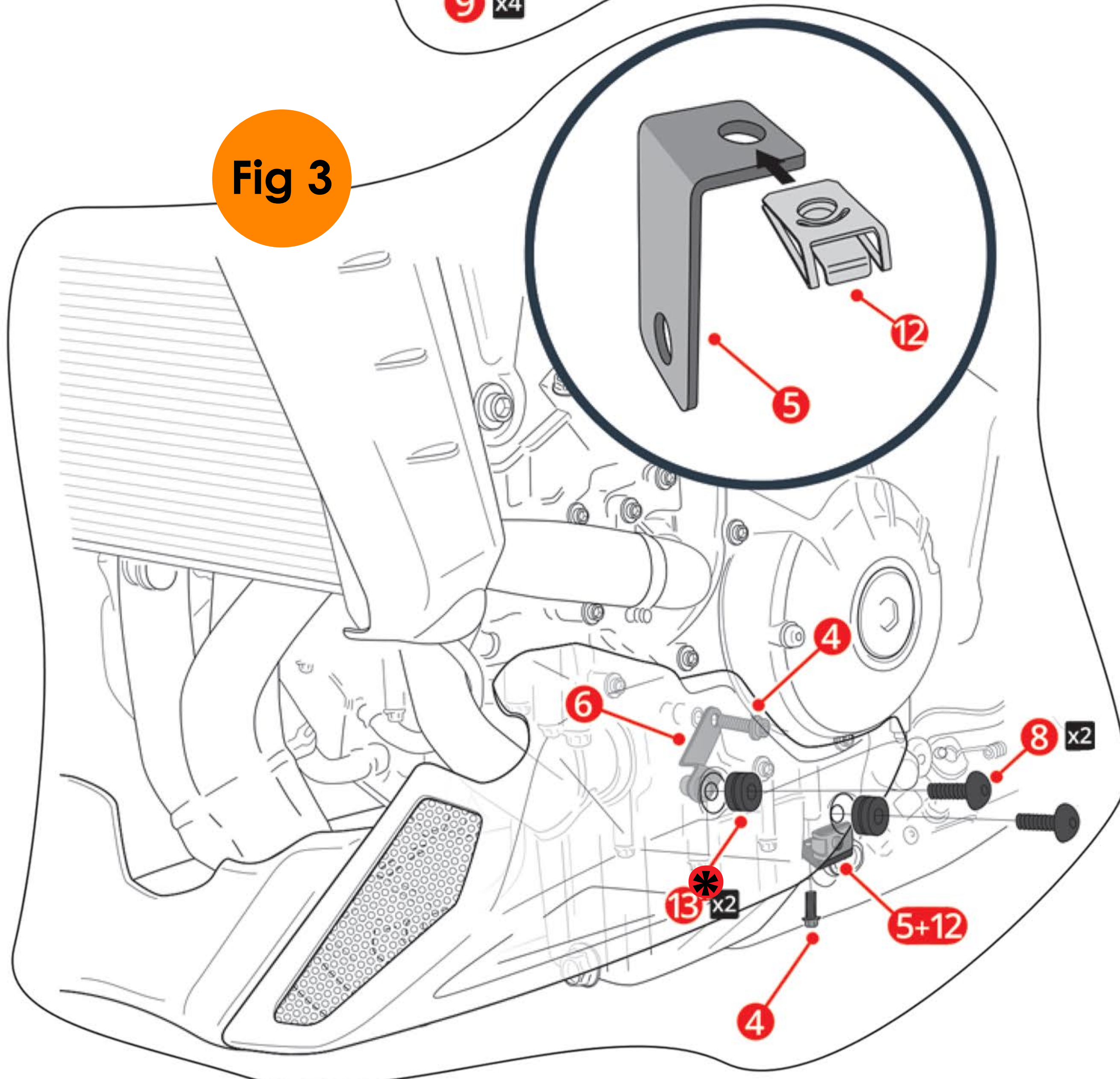
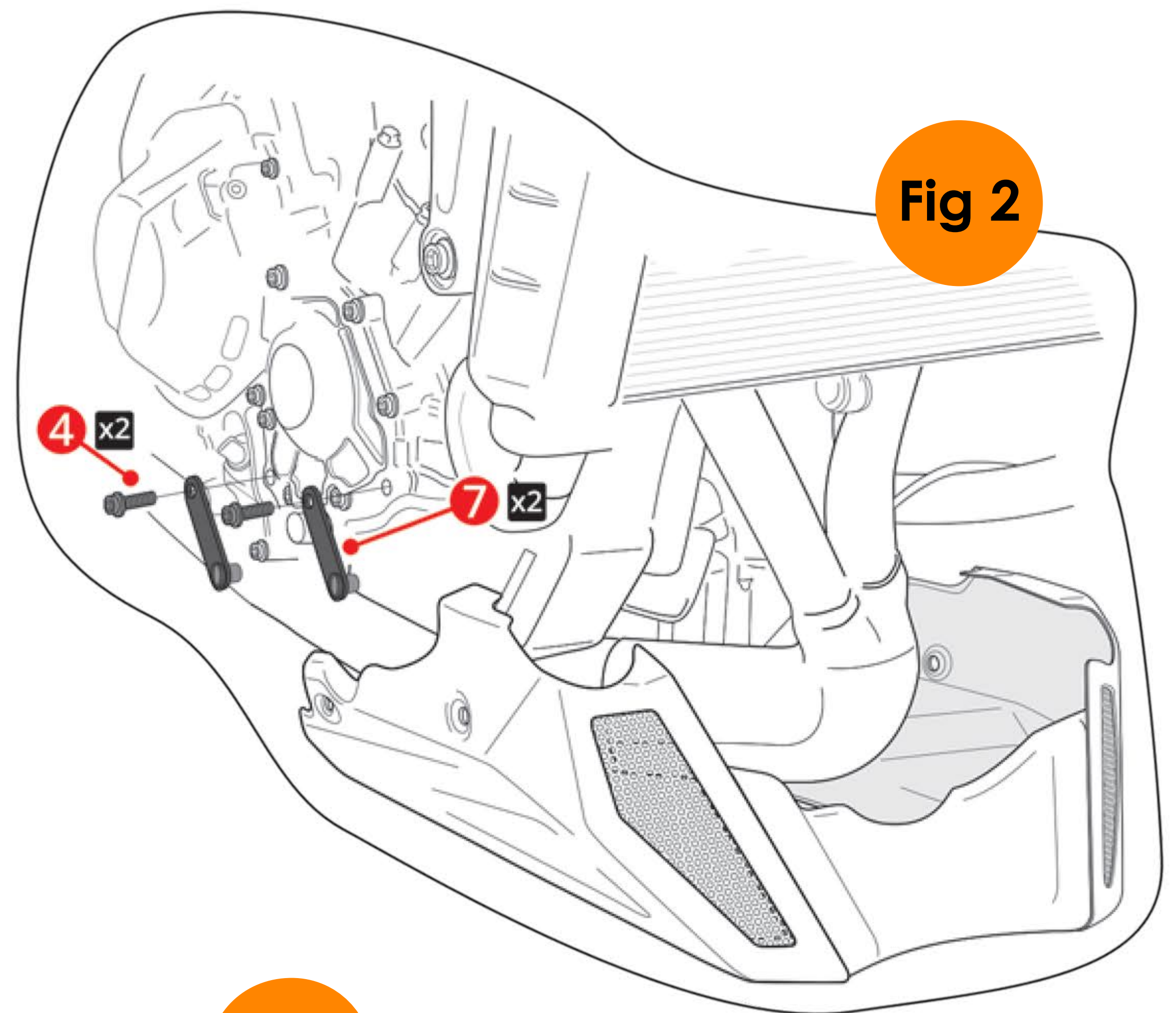
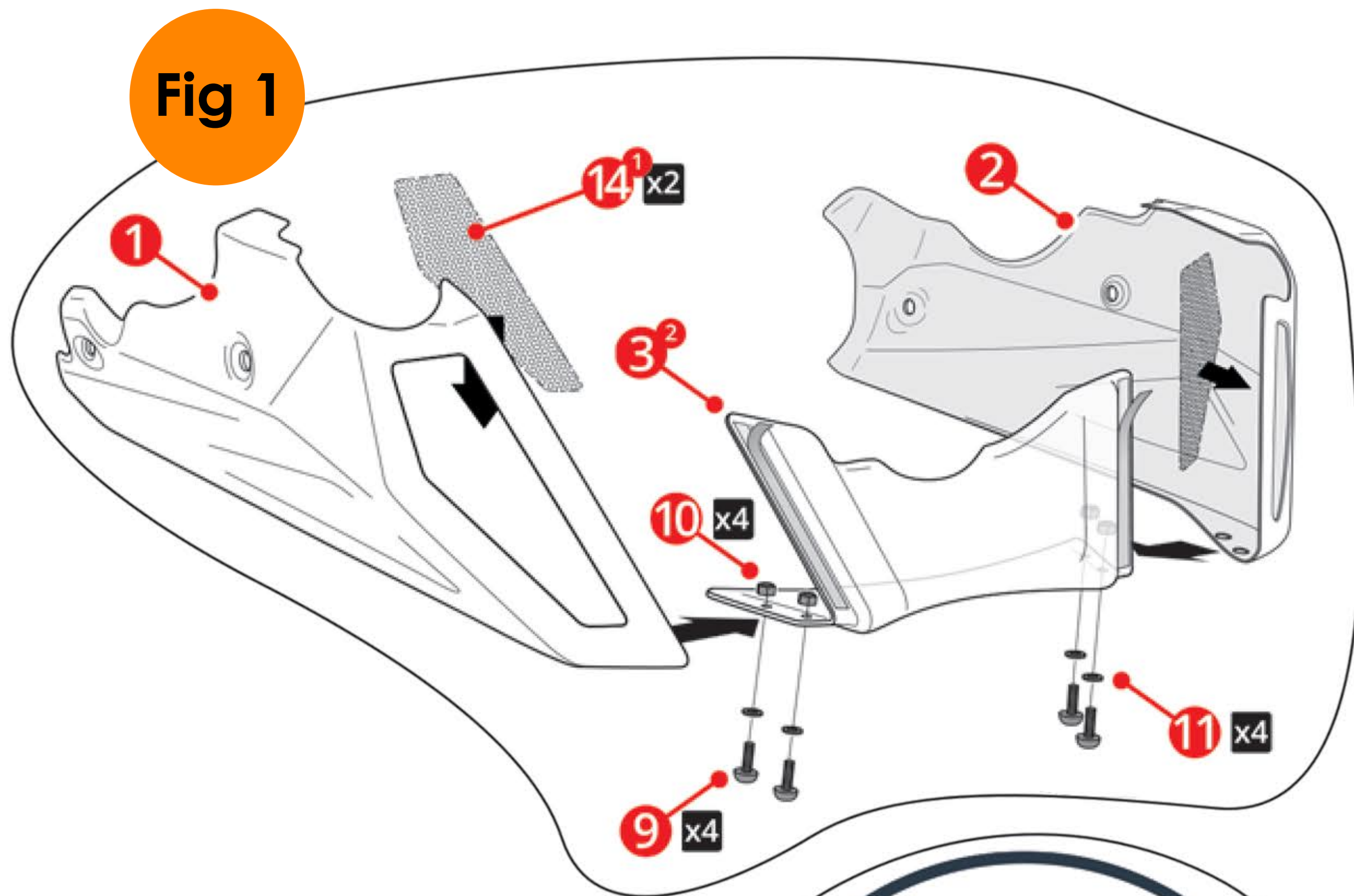

* = metal washer on outside of product

Any questions?
sales@pyramid-plastics.co.uk
 +44 (0)1427 677990
www.pyramid-plastics.co.uk



Follow us on social media and feel free to leave us a review!