



08026 Honda CRF1100L Africa Twin Wind Deflector Fitting Instructions

Kit Includes:

2X M6 X 20 _{mm} Bolts	CBOLM60009
2X Spacers	CSPAM60011
4X Plastic Washers	CWASM60003

- Remove the OEM bolts from the places shown below (see diagram).
Re-fit using the same mounting points with the fittings provided.

Please note: the part will flex slightly when fully tightend at the forward mounting points - this isn't an issue and will not damage the product.

Disclaimer: This material is not petrol resistant and will discolour if petrol comes into contact with the product.

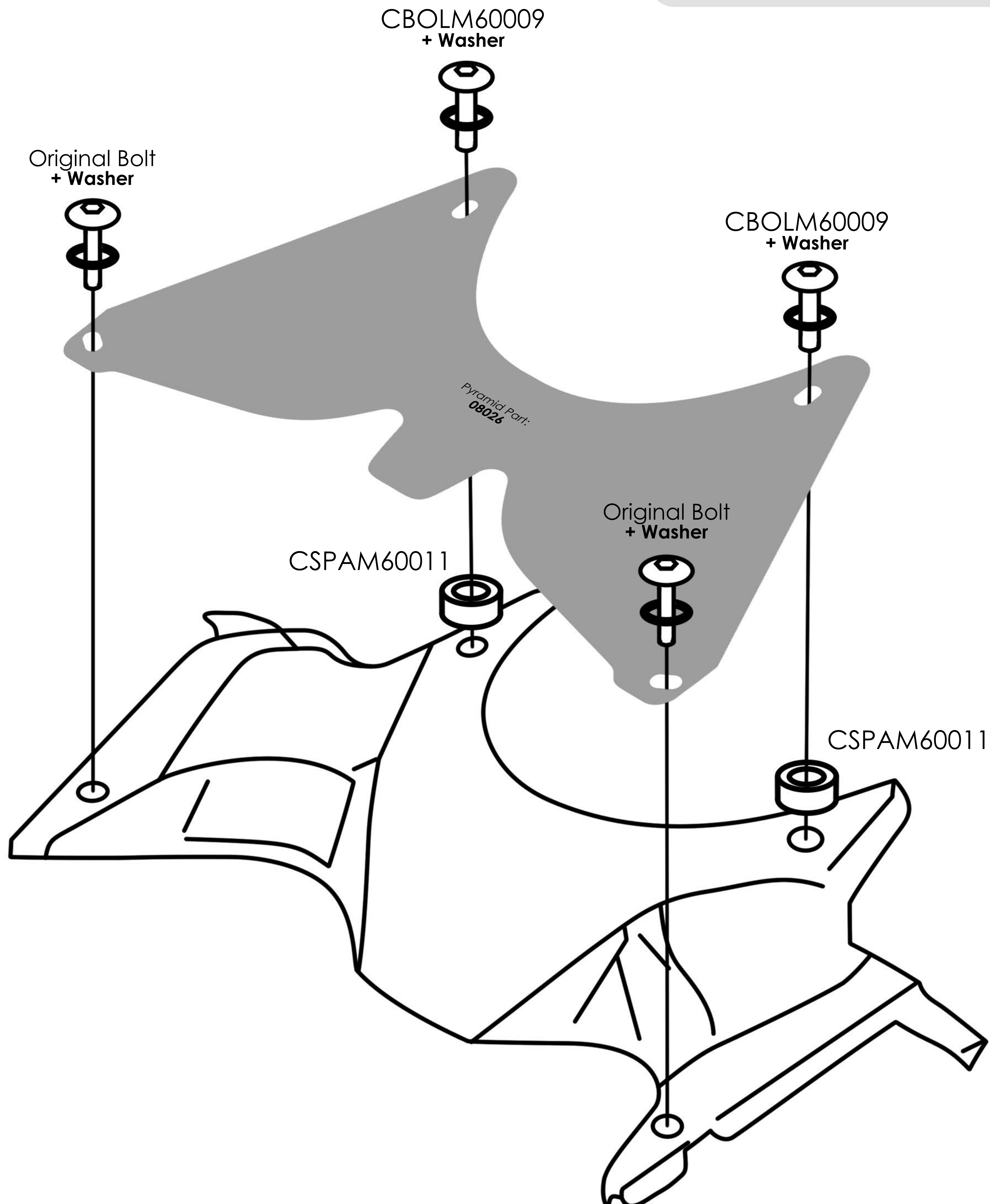

Contact us:
sales@pyramid-plastics.co.uk - +44 (0)1427 677990 - www.pyramid-plastics.co.uk

Follow us on social media and feel free to leave us a review!

