

# PYRAMID



## 073925 Kawasaki H2 SX Hugger Fitting Instructions

Kit Includes:

1X Hugger	C073925
1X Rubber Cover	CRUB073925
2X M6 Plastic Washer	CWASM60003
1X M6 X 12mm Bolts	CBOLM60007
1X Spacer	CSPAM60009

- The Pyramid hugger is a direct replacement of the original hugger.
- Remove the original hugger from the five mounting points (shown below).
- The rubber cover (CRUB073925) supplied is fitted using the original bolt, 1X CWASM60003 & 1X CSPAM60009 (shown below).
- The Pyramid hugger is fitted at points A, B & E. Point E uses the CBOLM60007 supplied and the extra CWASM60003 supplied is used at point A.
- Be sure to check fixings periodically.

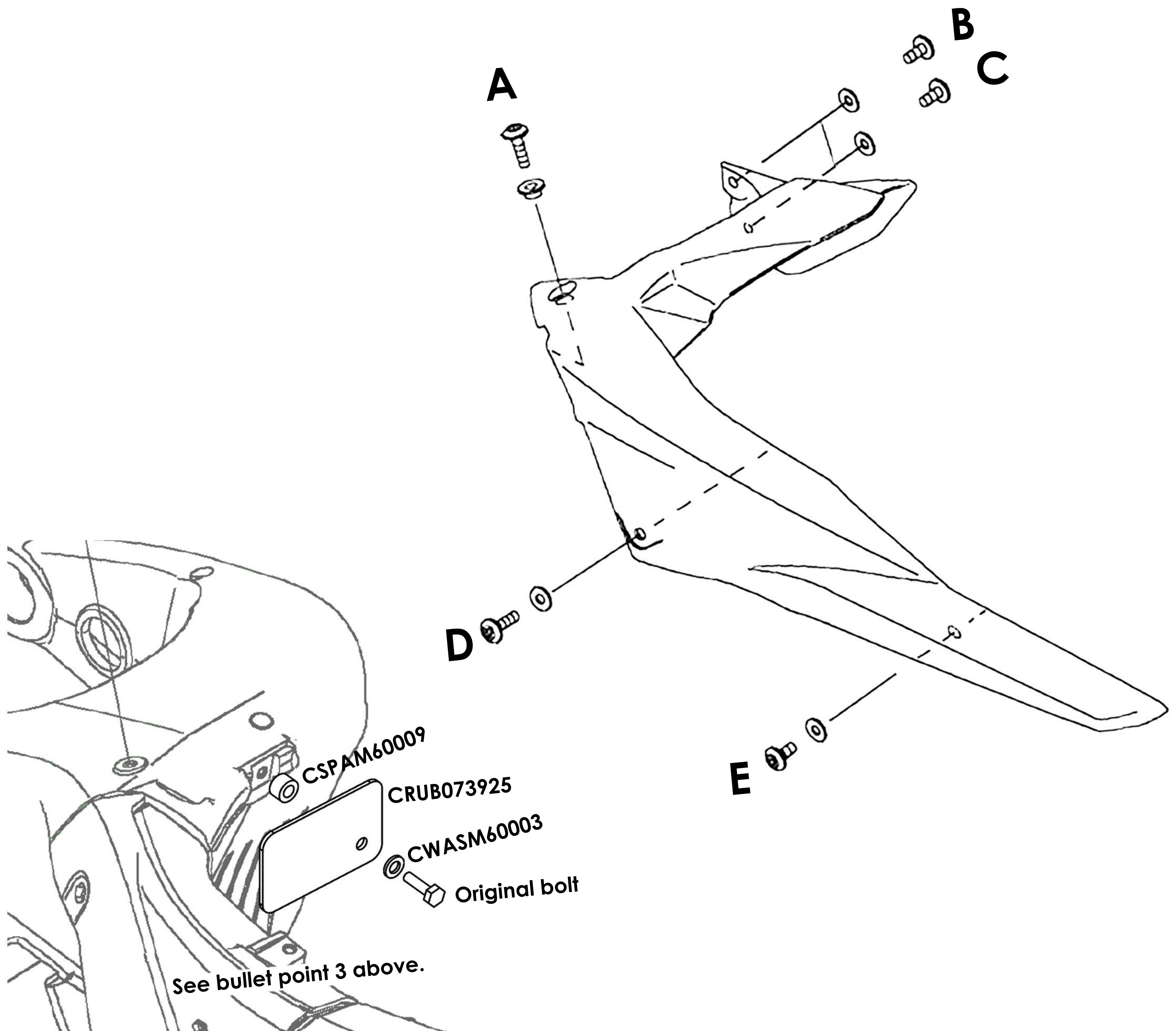

Any questions?  
sales@pyramid-plastics.co.uk  
+44 (0)1427 677990  
www.pyramid-plastics.co.uk

Follow us on social media and feel free to leave us a review!

