

073850 Kawasaki Versys 650 Hugger Instructions

Kit Includes:

3X M6 X 20mm Flanged Button Head Bolts	CBOLM60009
3X 13mm Grommet	CGROM60001
2X 8mm Steel Collar	CSPAM60004
1X 12mm Steel Collar	CSPAM60005

- Start by fitting **all Grommets & Steel Collars** supplied to the mounting points (follow **Fig 1** diagram)
- Remove the OEM chainguard already fitted to the bike (If the bike is 2016 or older you will need to remove the brake hose/ABS clip too).
- If the bike is 2017 or newer, you will need to unscrew/remove the small plastic cap on the swing arm just behind the shock mount. The mounting point that is revealed is crucial for fitment of the Pyramid Hugger (shown in **Fig 2**).
- Loosen (**but DO NOT remove**) the single bolt holding the brake hose/ABS retaining bracket on the right-hand side of the bike. This makes it easier to position the Pyramid Hugger in the correct place. (**Be sure that the brake hose/ABS retaining bracket mentioned above is re-fitted to its original state once you fit the Pyramid Hugger in the final step**).
- Slide the Pyramid Hugger over the rear wheel ensuring that the slot in the hugger (shown in **Fig 3**) fits onto the bolt loosened in the 4th bullet point.
- Loosely fit the Pyramid Hugger to the 3 remaining mounting points using the **3 M6 X 20mm Flanged Button Head Bolts** supplied (shown in **Fig 4**).

Note: Check alignment of the Pyramid Hugger whilst tightening at all 4 mounting points.

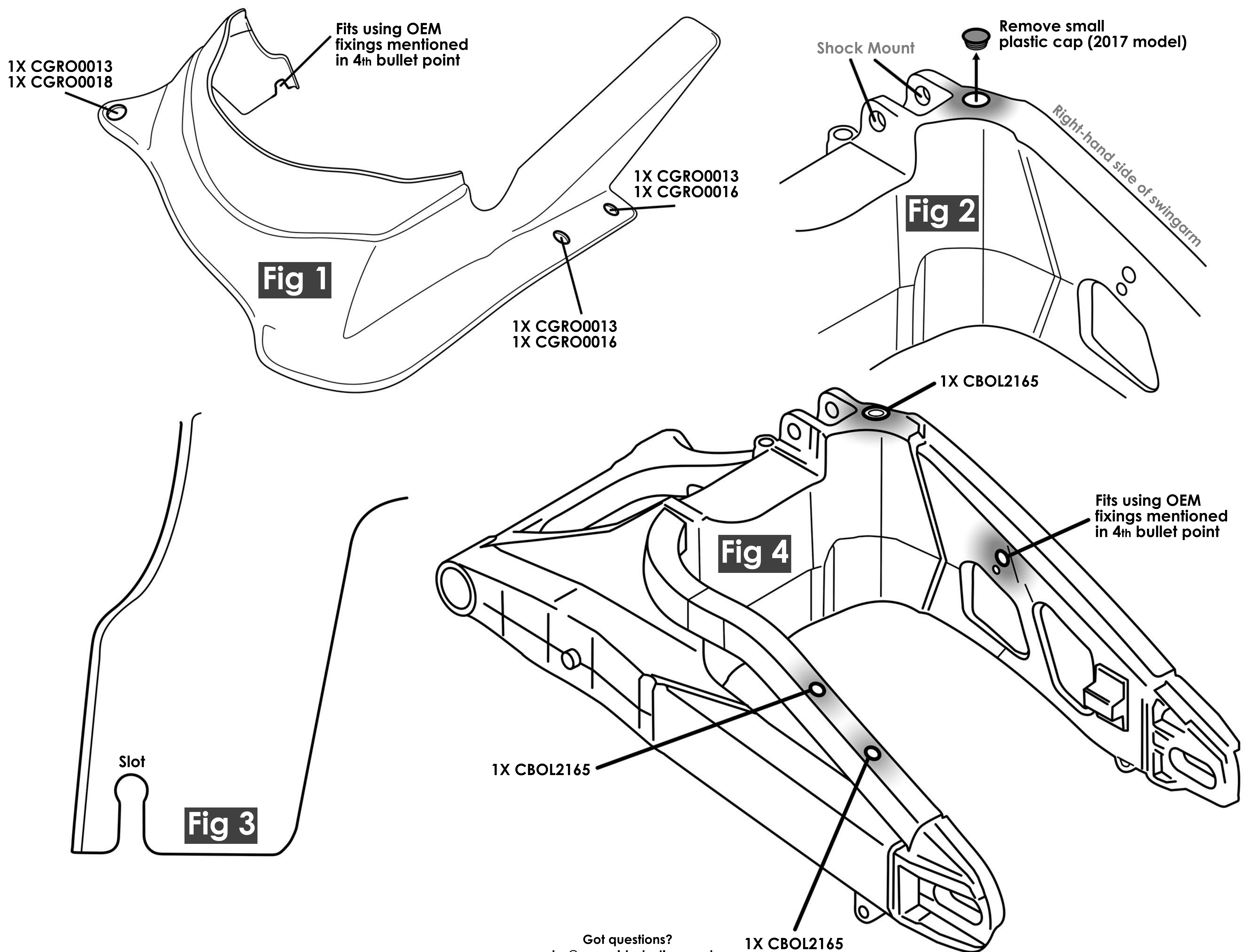

Got questions?
sales@pyramid-plastics.co.uk
+44 (0)1427 677990
www.pyramid-plastics.co.uk

Follow us on social media and feel free to leave us a review!

