

072438 & 072442 Yamaha MT-07 & Tracer 700 Hugger Fitting Instructions

No additional fittings required.

- Remove the OEM Yamaha Hugger at points **A**, **B**, **C** & **D** (Shown in **Fig 1**). Bolts removed at points **C** & **D** are **required to fit the Pyramid Hugger** - but you **will not need** the steel collars removed from these points (See ✱ below **Fig 1**). Push-rivets removed at points **A** & **B** are not required to fit the Pyramid Hugger.
- The small bracket at point **E** needs to be temporarily removed in preparation to fit the Pyramid Hugger - keep all fittings (Shown in **Fig 1**).
- Position the Pyramid Hugger over the rear wheel over points **C**, **D** & **E** (Shown in **Fig 2**).
- Make sure the small bracket marked in **RED** is above the Pyramid Hugger tab at point **E** (Shown in **Fig 2** & **Fig 3**). Pyramid Hugger shown in **GREY** in **Fig 3**.
- Finally, fit remaining OEM fittings on the chain guard side - check all fixings periodically.

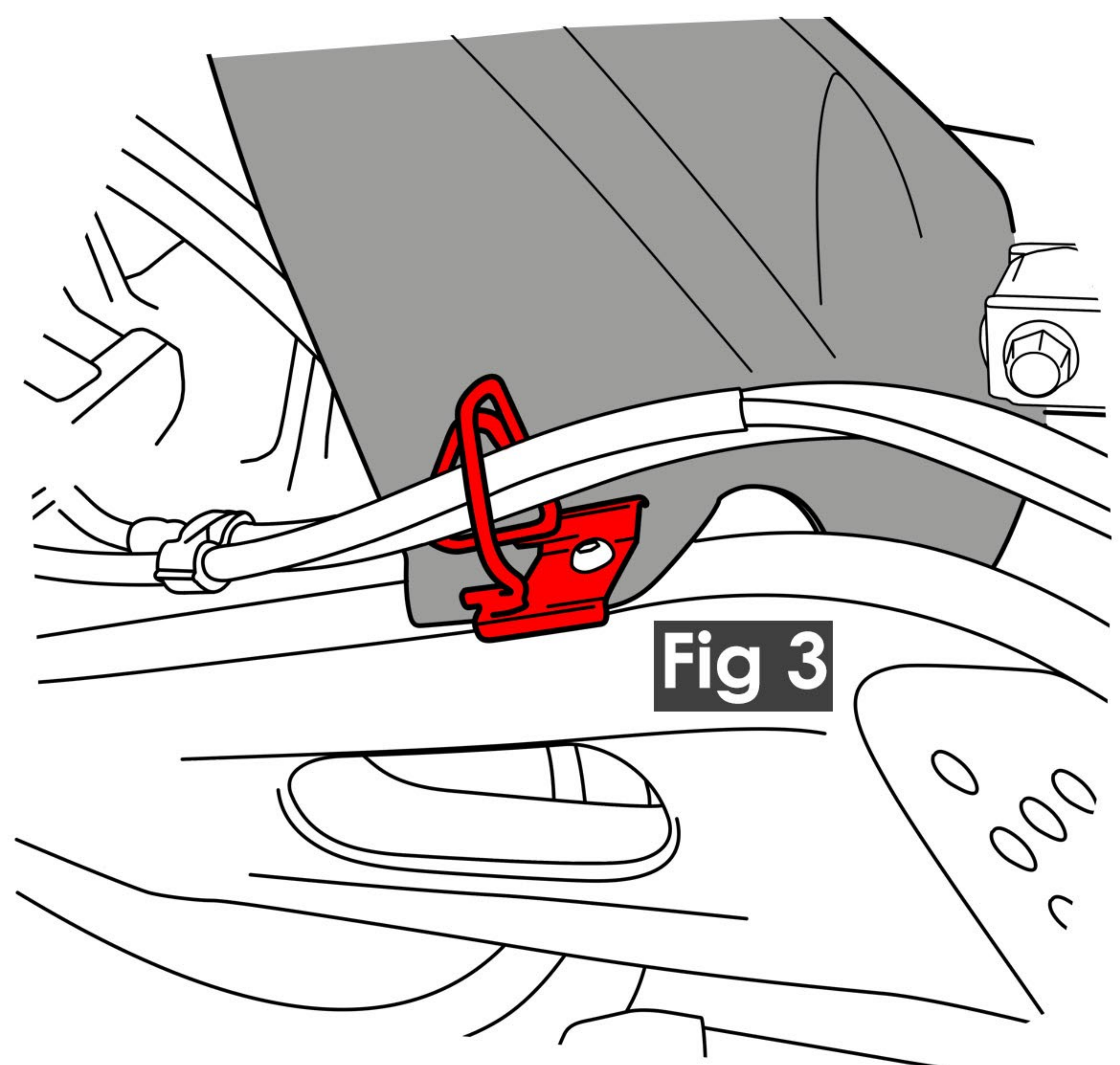
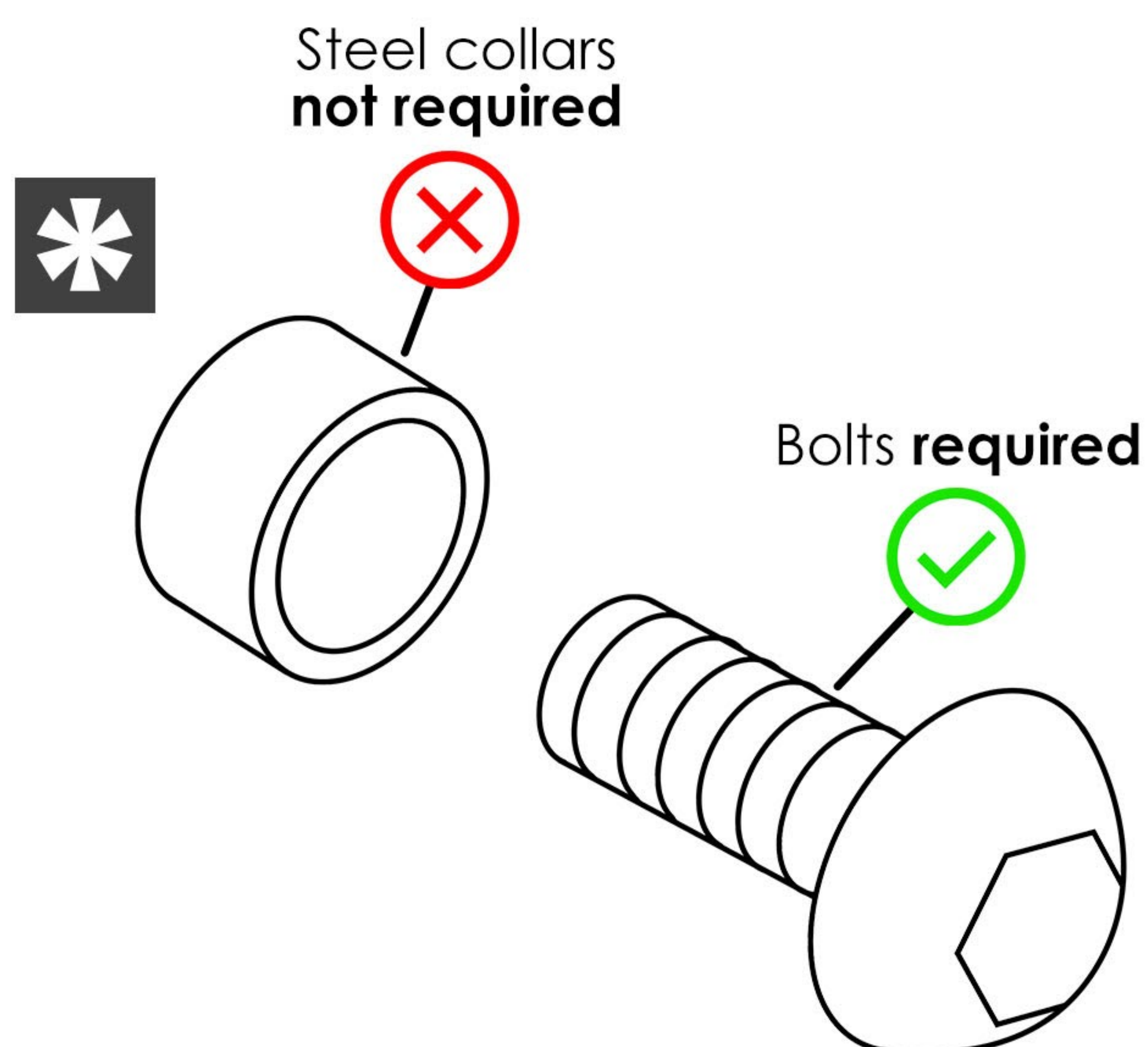
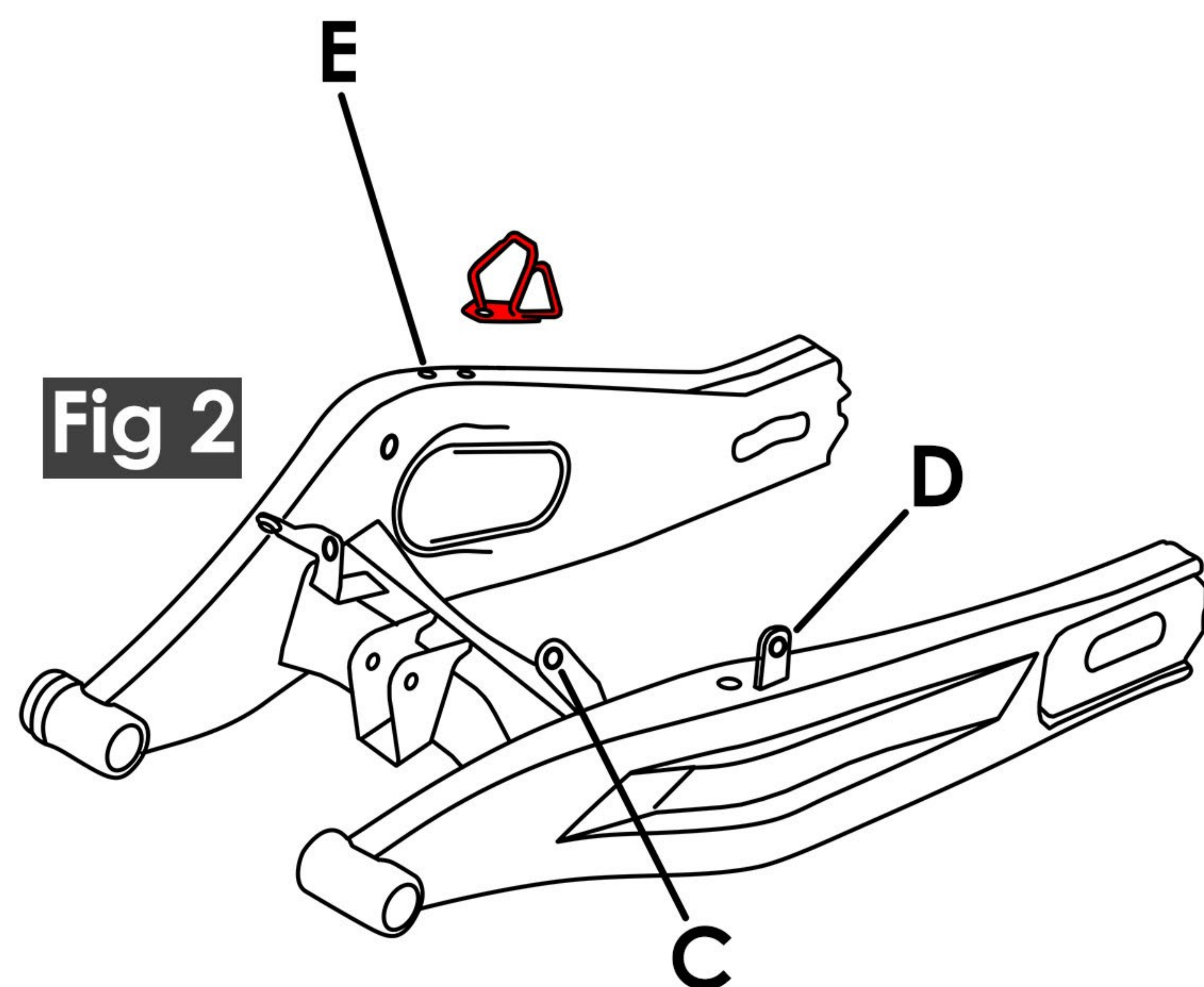
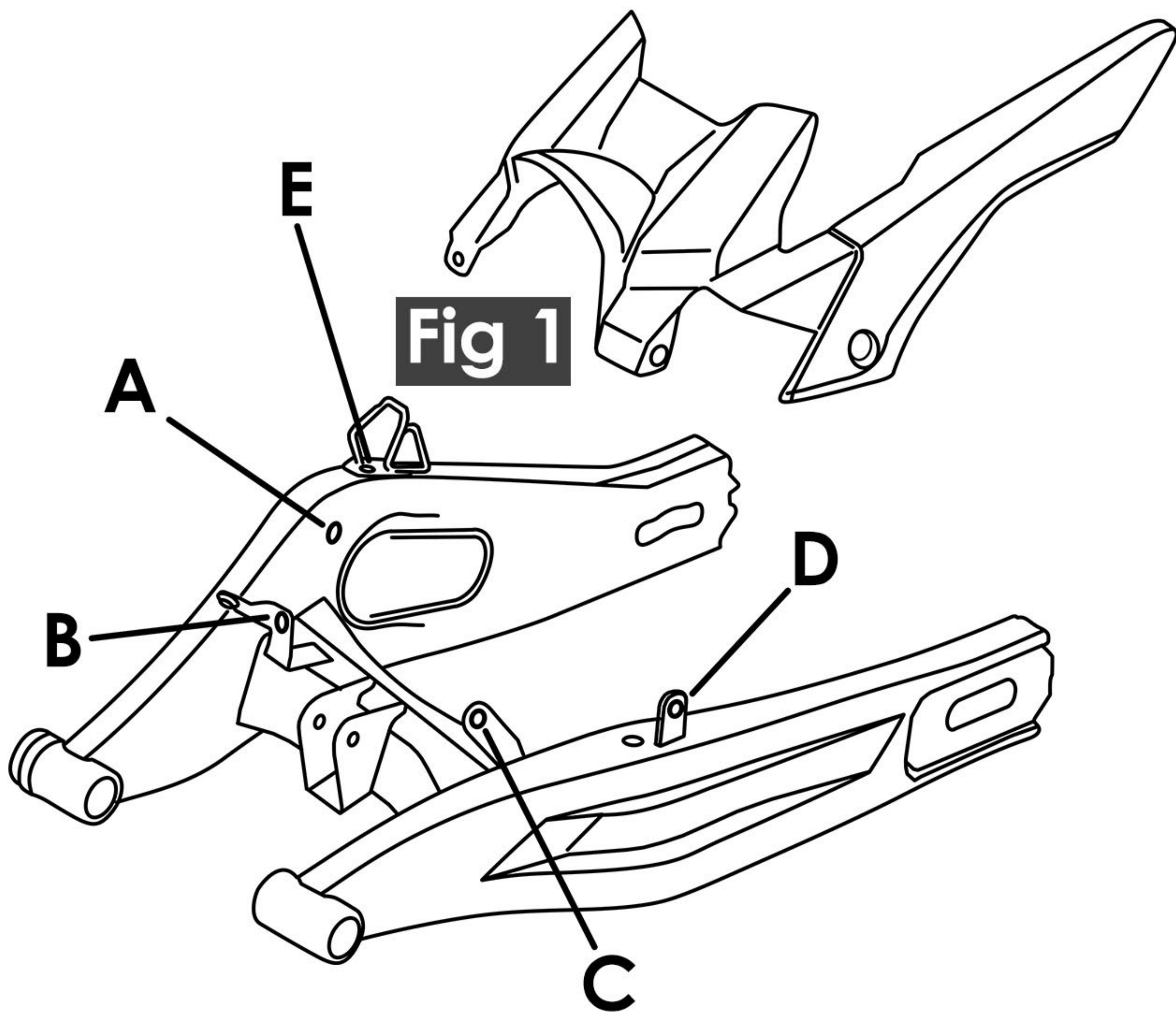

Got questions? We can help:
sales@pyramid-plastics.co.uk
+44 (0)1427 677990
www.pyramid-plastics.co.uk

Follow us on social media and feel free to leave us a review!

