

## 071921 Honda NT1100 Hugger Fitting Instructions

### Kit Includes:

1X	C071921	Moulding
1X	CFK071921	Bracket - right-hand side
1X	CFK071921A	Bracket - left-hand side
5X	CBOLM60008	M6 x 16mm Bolt
5X	CWASM60003	M6 Washer
1X	CRUB0010	Rubber Strip (120mm length)
1X	CBOLM40001	Pre-fitted by Pyramid M4 x 10mm Bolt
2X	CPNUT0001	Pre-fitted by Pyramid Aluminium Nut

**Fitting note:** attach fixings loosely at first - this aids alignment of the hole centres.

Remove the original chainguard. Remove the brake hose clip on the right hand side of the swingarm (retain the OEM posi-drive bolt from this mounting point). The brake hose clip can be discarded, as the profile of the hugger will keep the brake wire hose in position.

Attach the rubber strip to the left-hand side bracket as shown below in **Fig 1**.

Attach the right-hand side bracket to the hugger as shown in **Fig 2**.

Fit the hugger to the bike as shown in **Fig 2 & 3**.

**Fig 4** shows how the right-hand side bracket needs to be positioned to support the hugger once tightened - we advise the use of thread-locking fluid on this bolt.

Fully tighten all mounting points. Ensure fixings are checked periodically.

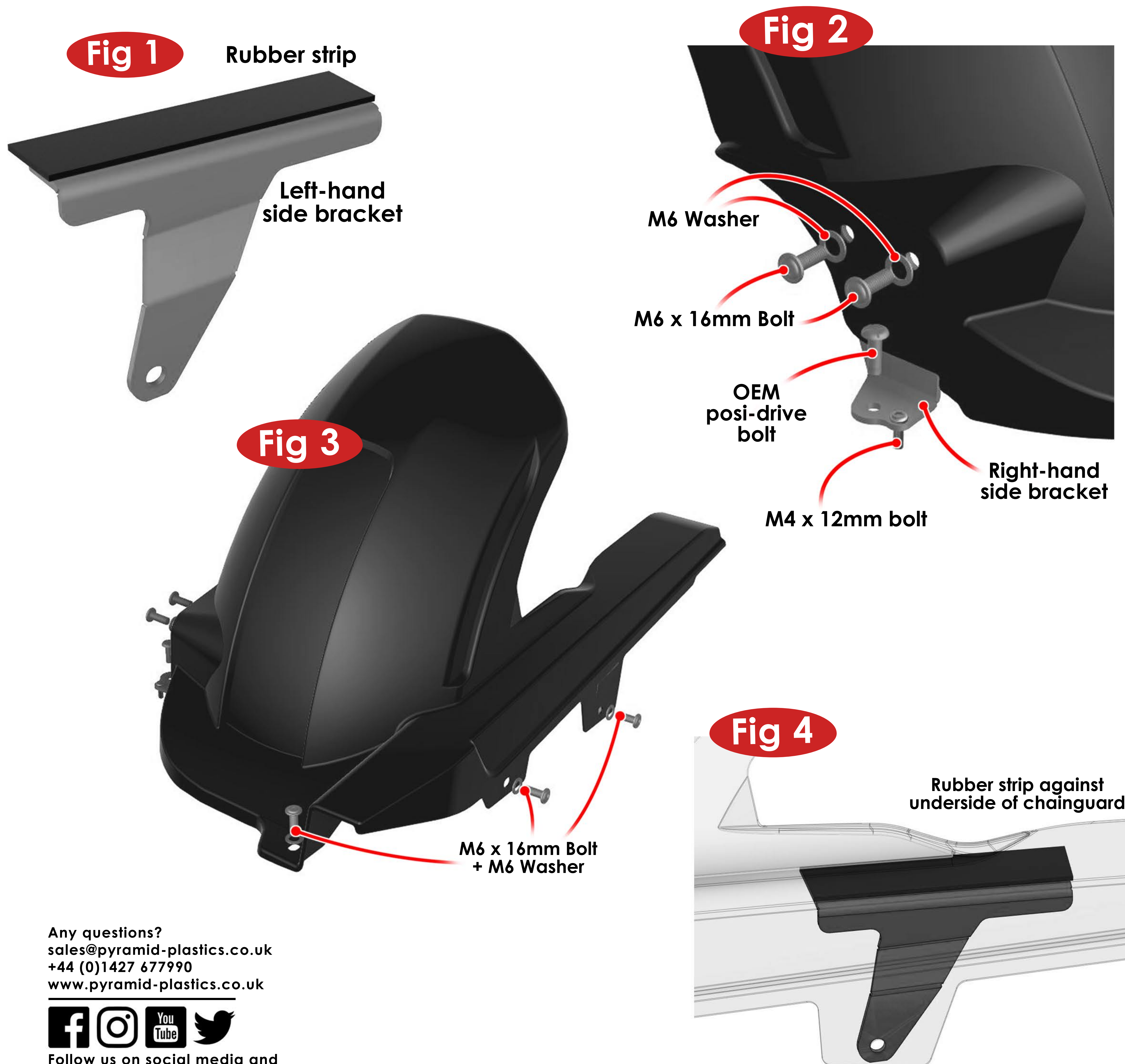

Any questions?  
[sales@pyramid-plastics.co.uk](mailto:sales@pyramid-plastics.co.uk)  
 +44 (0)1427 677990  
[www.pyramid-plastics.co.uk](http://www.pyramid-plastics.co.uk)



Follow us on social media and feel free to leave us a review!