

071150 Honda NC750 X/S, NC700 S Hugger 2012> Fitting Instructions

Kit Includes:

| | | | |
|-----|----|-------------|--------------------------------|
| 1. | X1 | C071150 | NC750/NC700 Hugger Moulding |
| 2. | X1 | CFK071150A | Mounting Bracket A - Front RHS |
| 3. | X1 | CFK071150B | Mounting Bracket B - Rear RHS |
| 4. | X1 | CFK071150C | Mounting Bracket C - Rear LHS |
| 5. | X6 | CGROM60001 | M6 Rubber Grommet |
| 6. | X6 | CSPAM60004 | M6 Steel Collar |
| 7. | X6 | CBOLM60009 | M6 x 20mm Flanged-Button Bolt |
| 8. | X2 | CWASM60001 | M6 Steel Washer |
| 9. | X2 | CNUTM60003 | M6 Nyloc Nut |
| 10. | X1 | CFOA0002 | Foam Strip (20mm) |
| 11. | X2 | CPNUTM60001 | M6 Locating Nut - Pre-fitted |

Please Note: The 2 x M6 locating nut are already pre-located on the supplied bracket, 'CFK071150A'.

OEM Parts (From the Bike):

| | | | |
|-----|----|---------------|-------------------------------|
| 12. | X1 | OEM NC750/700 | M5 x 25mm Flanged-Button Bolt |
| 13. | X1 | OEM NC750/700 | M8 x 50mm Flanged-Hex Bolt |

Assembly Instructions

Before proceeding with fitment of the hugger, you may find it easier to remove the exhaust cannister to access the mounting points on the 'RHS' of the motorcycle. This can be done at any point during the installation, so you don't need to worry about it just yet!

- Begin by installing the 6 x rubber grommets (Item 5) in all the pre-drilled holes in the hugger (Item 1). Once completed, insert the 6 x steel collars (Item 6) into the 6 x rubber grommets.
- Locate 'Mounting Bracket C' and insert 1x M6 bolt (Item 7) in the hole furthest back on the LHS of the hugger, securing with 1 x M6 washer (Item 8) and 1 x M6 nyloc nut (Item 9). Tighten so that the bracket is secure, but can still be moved.
- Continue the installation by mounting 'Bracket A' (Item 2) and 'Bracket B' (Item 3). See 'FIG. 3' for reference.
 - To fix 'Bracket A', you will need to loosen the OEM M5 bolt (Item 12) which secures the brake hose pipe and subsequently place the bracket between the clamp faces, before re-inserting and loosely fastening.
 - Before fitting 'Bracket B', please apply the foam strip (Item 10) to the underside face referenced in 'FIG. 1'. To mount 'Bracket B', you will need to remove the OEM M8 bolt (Item 13) from the rear brake caliper. **This is the stage where you may want to remove your exhaust cannister!** Re-insert the OEM M8 bolt, together with 'Bracket B' and loosely fasten to allow movement.
- Please remove the OEM chainguard from the LHS of the bike to provide access to the mounting points located on the swingarm. See 'FIG. 2' for reference.
- Proceed to slide the hugger over the rear wheel, ensuring the hugger encloses all mounting points and brackets internally. To secure 'Bracket B' to the hugger, please use 1 x M6 bolt, together with 1 x M6 washer and 1 x M6 nyloc nut. For all other fittings, please use the remaining 4 x M6 bolts.
- Once the hugger has been mounted in all locations, proceed to tighten all mounting points. Please avoid overtightening by stopping when sufficient resistance is encountered. For the OEM M8 bolt, please use a torque setting of 45Nm to re-tighten.

Any questions?
sales@pyramidmoto.co.uk
 +44 (0)1427 677990
www.pyramidmoto.co.uk



Follow us on social media and feel free to leave us a review!

Please Note: We advise that all fixings are checked periodically.

071150 Honda NC750 X/S, NC700 S Hugger 2012> Fitting Instructions

The images below will assist with identification and application of the components provided in the fitting kit.

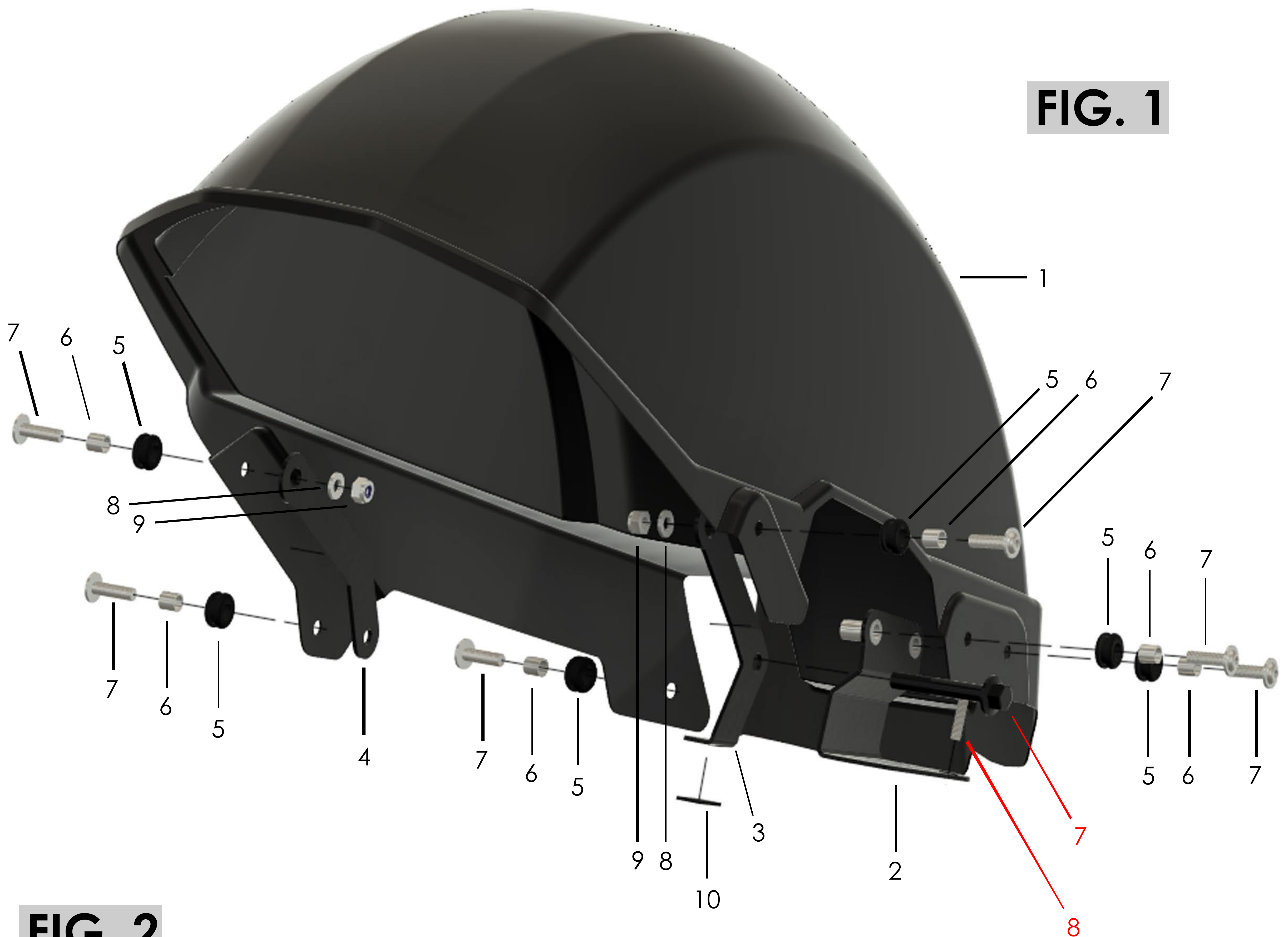

FIG. 1

FIG. 2

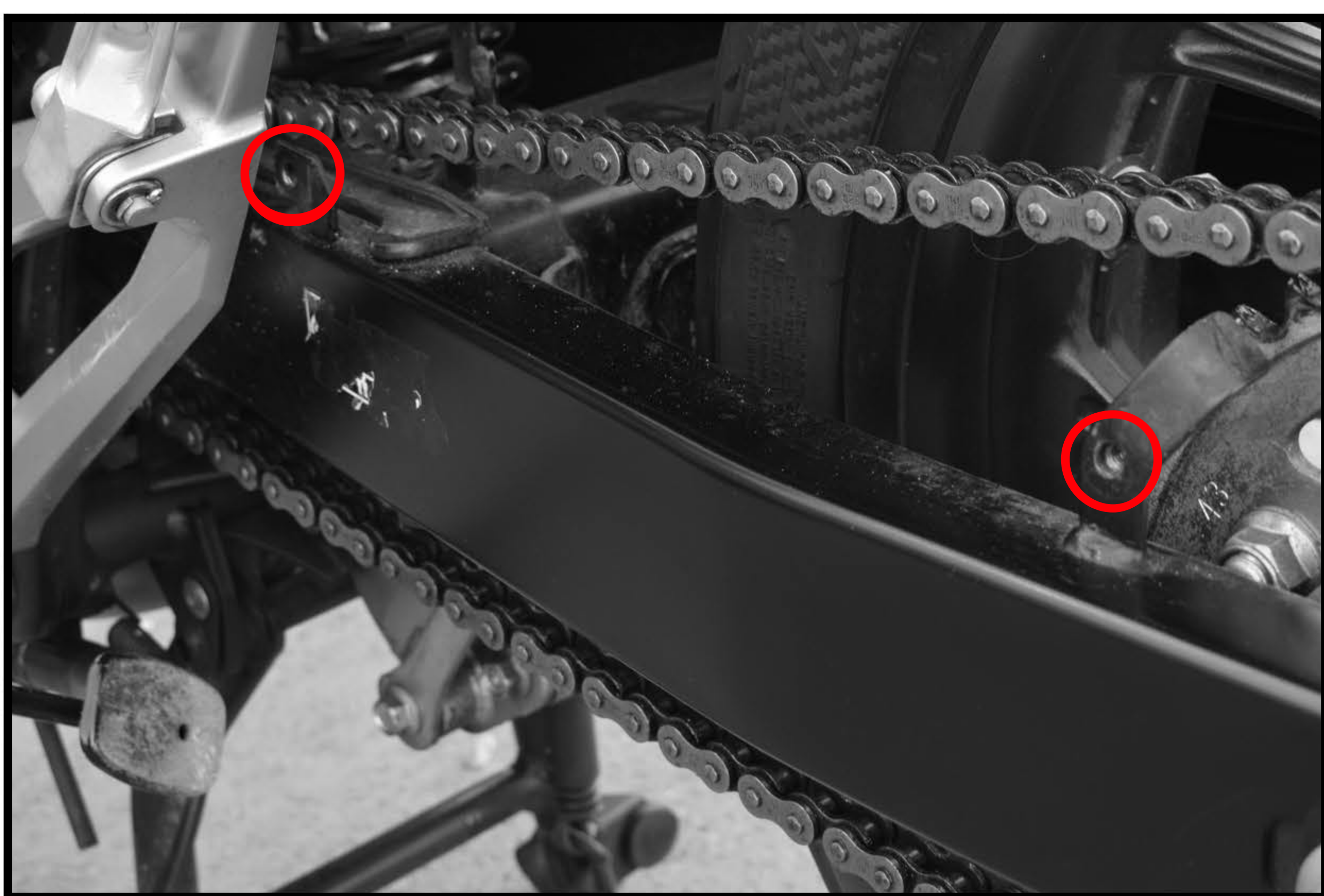
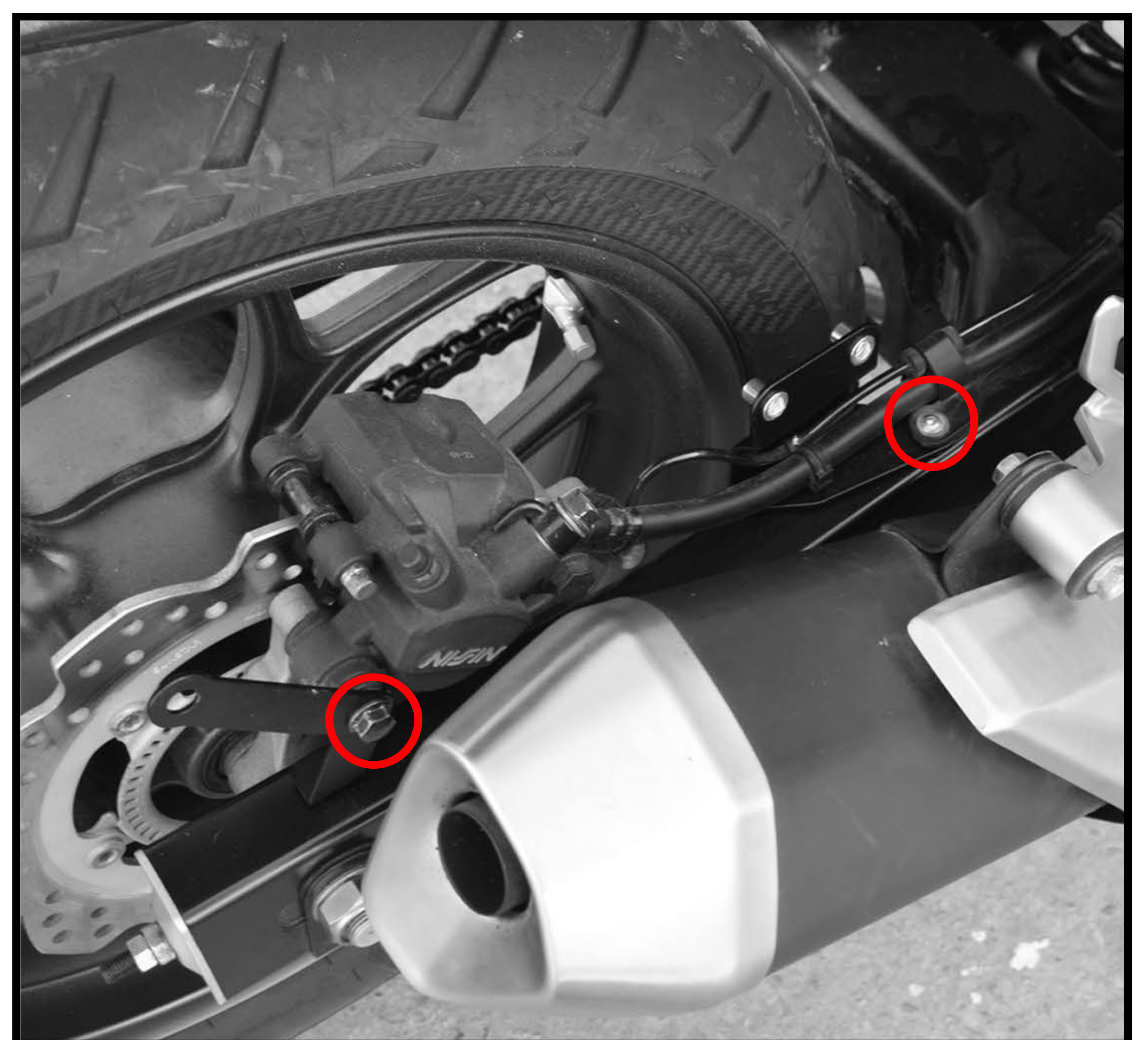

FIG. 3



Any questions?
sales@pyramid-plastics.co.uk
 +44 (0)1427 677990
www.pyramid-plastics.co.uk



Follow us on social media and feel free to leave us a review!