

054732M BMW R1300GS Extenda Fenda EXTRA 2023> Fitting Instructions

Kit Includes:

1.	X1	054732	Extenda Fenda EXTRA
2.	X1	CFK054732A	Mounting Bracket 'A' (RHS)
3.	X1	CFK054732B	Mounting Bracket 'B' (LHS)
4.	X4	CBOLM50005	M5 x 12mm Button-Head Bolt
5.	X8	CWASM50002	M5 Flat Steel Washer
6.	X4	CNUTM50002	M5 Nyloc Nut
7.	X1	CTAP0053	Adhesive Sticker Sheet
8.	X1	CWIP001	Adhesion Promoter Wipe

OEM Parts (From the Motorcycle):

9.	X4	OEM R1300GS	M10 x 60mm Torx Bolt
----	----	-------------	----------------------

Assembly Instructions

- Please ensure your front guard and the surrounding area are clean from dirt and debris. Soapy water will be sufficient for this purpose.
- Begin by loosely fitting the mounting brackets 'A' (Item 2) and 'B' (Item 3) to the Extenda Fenda EXTRA moulding (Item 1). Use 1 x M5 bolt (Item 4), 2 x M5 washers (Item 5) and 1 x M5 nyloc nut (Item 6) for each hole located on the moulding in the orientation shown. Please use 'FIG. 2' for reference. Tighten the M5 nyloc nuts **by hand only** at this stage, just enough to secure the brackets to the moulding.
- Place approximately 5 x stickers from the adhesive sticker set (Item 7) on the mounting surface of the Extenda EXTRA. Please ensure that all stickers are kept away from the edges and that they are all spaced equally apart from one another.
- Proceed by removing the 4 x M10 caliper bolts from the front brake calipers on the R1300GS. Before fitting the assembled Extenda EXTRA, use the adhesion promoter wipe (Item 8) on the inside of the guard. **Please ensure you keep the wipe well away from the external faces of the R1300GS front guard and the Pyramid Extenda EXTRA. The solution on the adhesion promoter wipe can react with the surface of any plastic it comes into contact with, resulting in staining to the plastic.**
- Slide the assembled Extenda EXTRA around the wheel, ensuring the brackets are resting on the calipers and the moulding profile is fitted around the R1300GS front guard. Once in position, press lightly on the moulding to secure it in place whilst you reinsert the brake caliper bolts. Please use 'FIG. 1' for reference.
- Thread the brake caliper bolts but do not fully tighten. Using a no.8 spanner and 3mm allen key, tighten the bolts 4 x fixings holding the brackets and moulding together. Tighten until sufficient resistance is felt and please avoid overtightening. Once in position, continue to fully tighten the brake caliper bolts. These have a torque rating of **38Nm**.
- As with all of our products, where appropriate, we recommend that customers should make use of the adhesive stickers and also clamp the relevant areas for a minimum of **12 hours**.
- Installation of the Pyramid Extenda Fenda EXTRA is now complete.

Any questions?
sales@pyramidmoto.co.uk
+44 (0)1427 677990
www.pyramidmoto.co.uk



Follow us on social media and
feel free to leave us a review!

Please Note: We advise that all fixings are checked periodically.

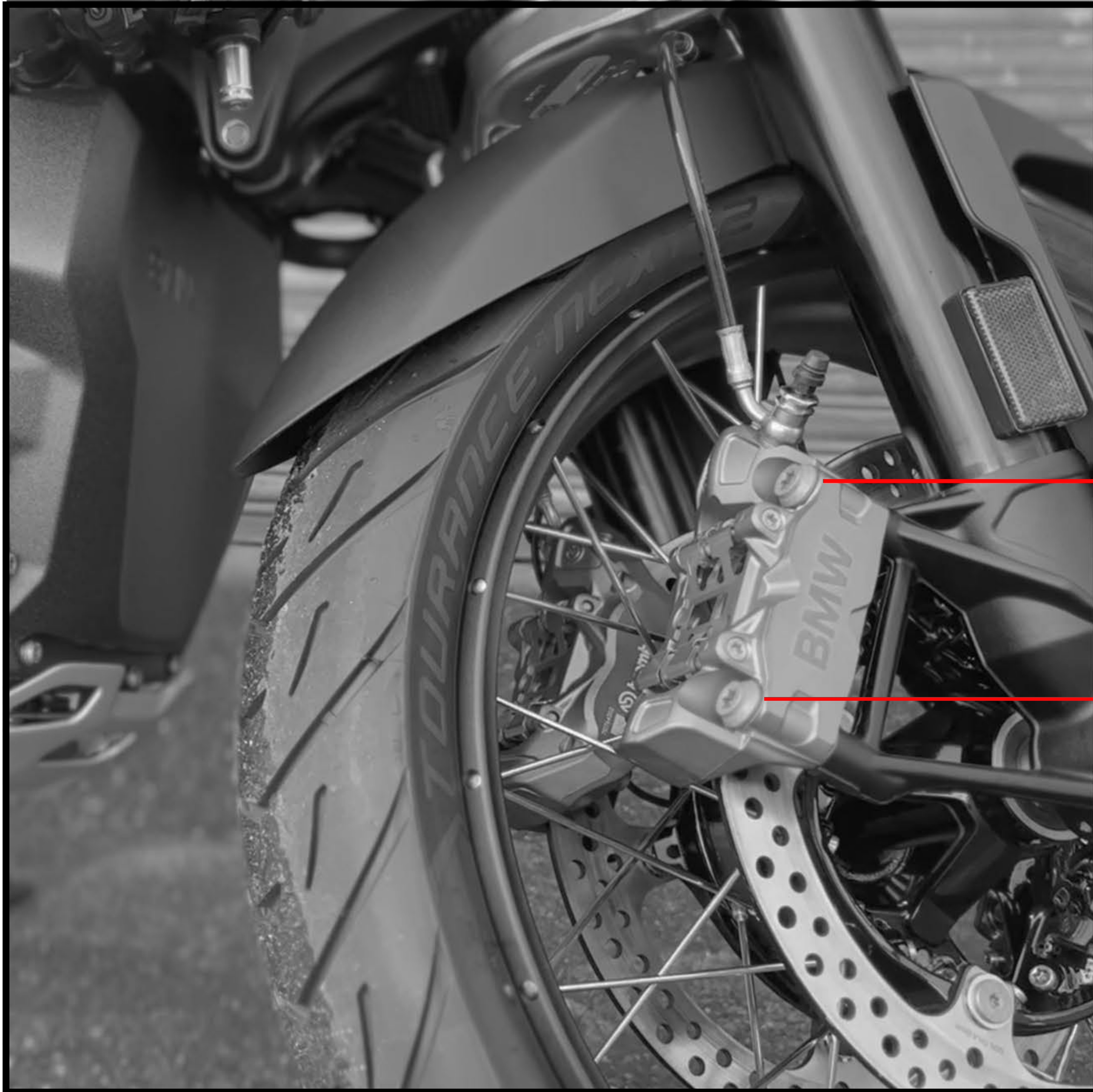

FIG. 1

Front brake caliper bolts: these should be removed from both front calipers prior to installation of the brackets. Once the brackets are in place, tighten the bolts to a torque rating of **38Nm**.

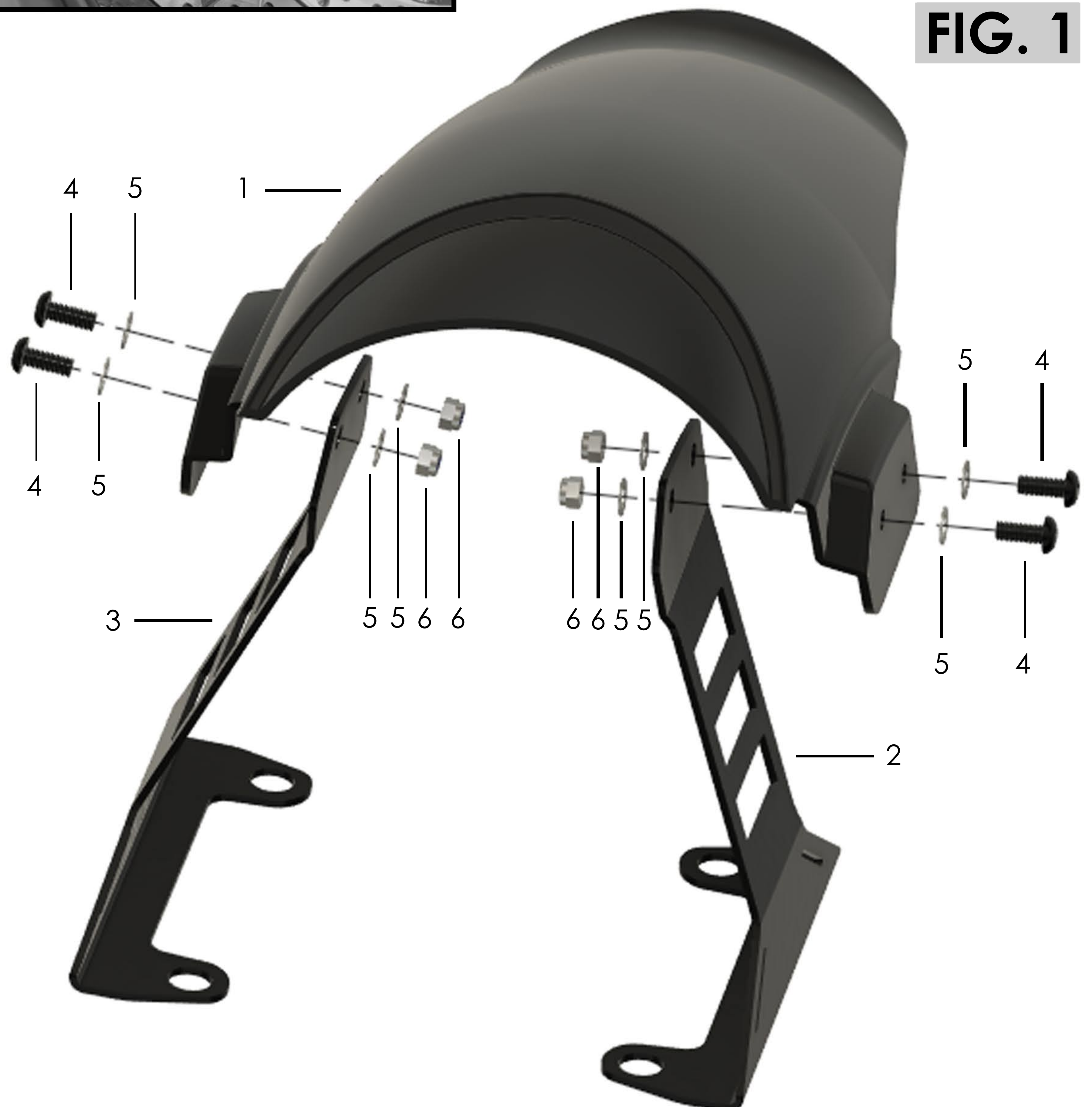

FIG. 1

Any questions?
sales@pyramidmoto.co.uk
+44 (0)1427 677990
www.pyramidmoto.co.uk



Follow us on social media and
feel free to leave us a review!