



Installation Guide



Rear Tube Step SP1105B

All Flatline Van Co products must be properly assembled and secured before attaching to your vehicle. Improper attachment could result in an automobile accident, and could cause serious bodily injury or death to you or to others involved. You are responsible for assembling and securing Flatline Van Co products to your vehicle, checking the mounting points and attachments prior to use, and regularly inspecting the products for wear and or damage. We always recommend you use a professional to install any aftermarket accessories to your vehicle. If you have no mechanical experience and are not thoroughly familiar with the installation procedures, you must have the product installed by a professional installer or other qualified persons. The responsibility is yours and must be taken seriously for everyone's safety.



thanks.

THANK YOU!

ARE YOU EXCITED ABOUT YOUR NEW REAR TUBE STEP? HERE ARE A FEW THINGS TO DO BEFORE BEGINNING THE INSTALLATION PROCESS--

- PLEASE INSPECT THE PRODUCT TO ENSURE THERE WAS NO DAMAGE INCURRED DURING SHIPPING.
- IF THERE IS DAMAGE TO REPORT, PLEASE CONTACT OUR CUSTOMER SERVICE DEPARTMENT AS SOON AS POSSIBLE.
- NEXT, USING THE "PACKAGE CONTENTS" PAGE, CHECK INVENTORY AND FAMILIARIZE YOURSELF WITH THE PARTS AND HARDWARE.
- GATHER ALL TOOLS REQUIRED FOR INSTALL.
 - 9/16 BOX WRENCH (RATCHET STYLE PREFERRED)
 - 16MM SOCKET
 - 19MM SOCKET
 - RATCHET

ESTIMATED INSTALL TIME- 30 MIN

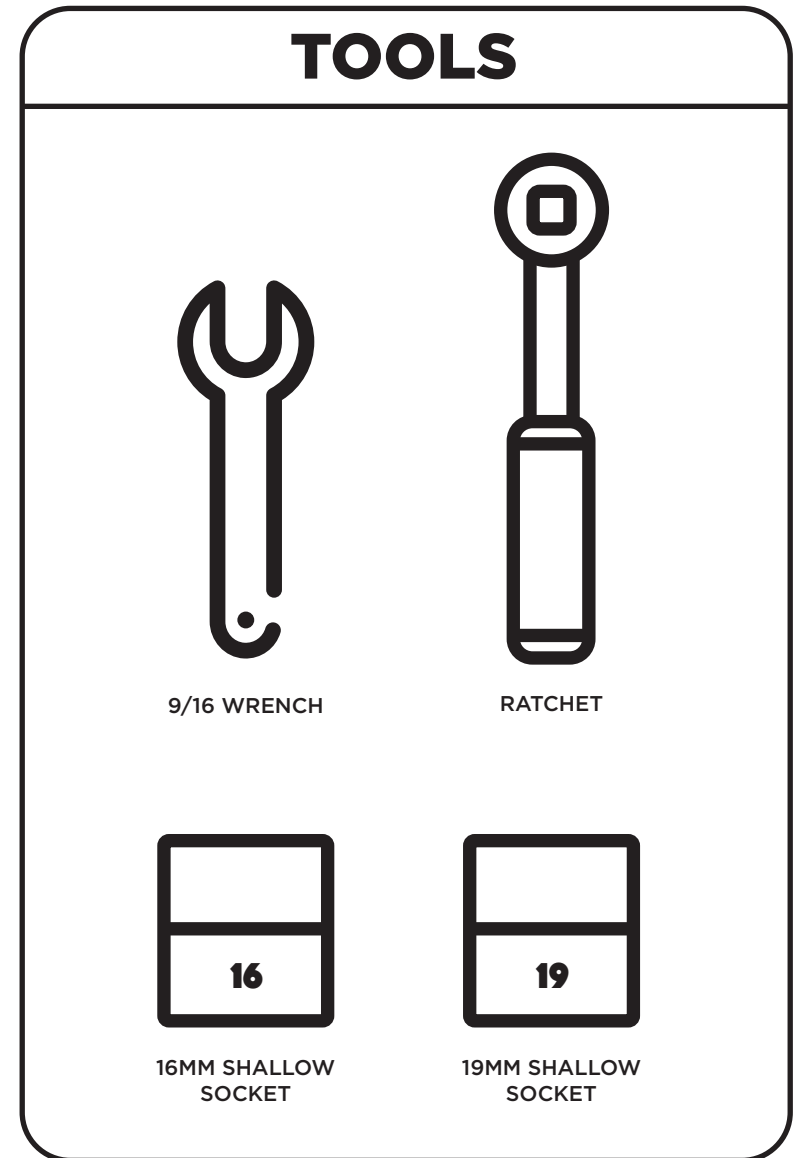

PACKAGE CONTENTS

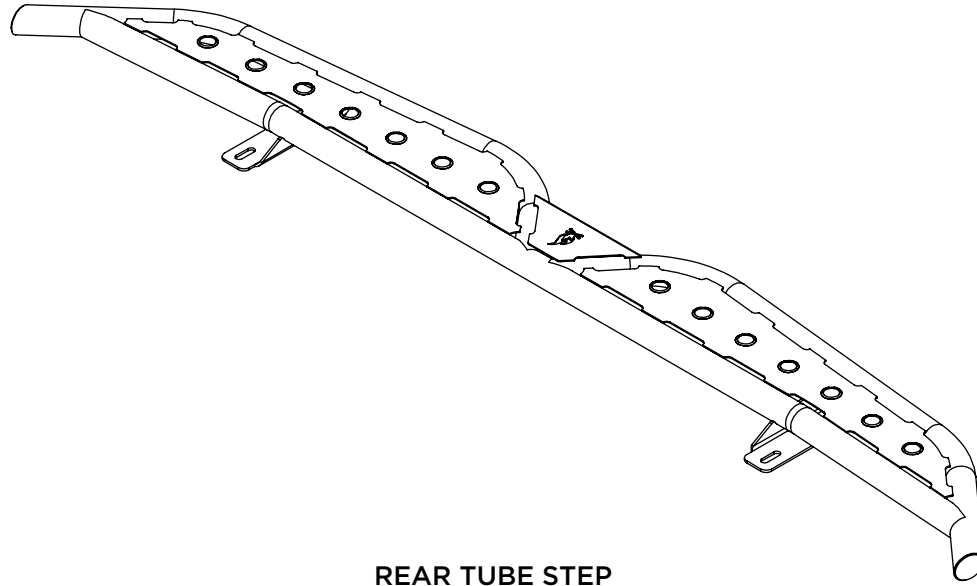

REAR TUBE STEP

QTY - 1

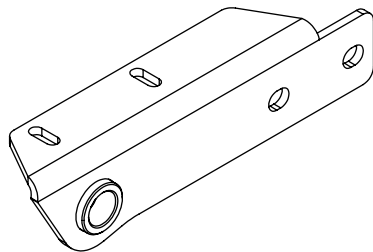

DRIVER SIDE BRACKET

QTY - 1

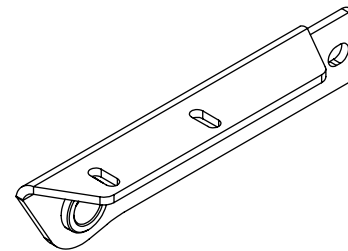

PASSENGER SIDE BRACKET

QTY - 1

HARDWARE

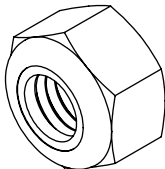

M12-1.75 NYLON INSERT
LOCKNUT

QTY - 4

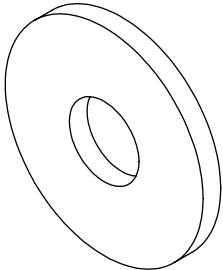

M12 SCREW X 37 O.D.
OVERSIZED FLAT WASHER

QTY - 4

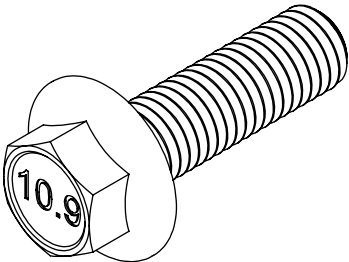

M12-1.75 X 40 FLANGED
HEX HEAD SCREW

QTY - 4

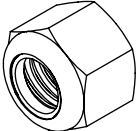

3/8-16 NYLON INSERT
LOCKNUT

QTY - 4

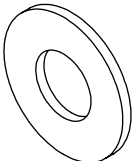

3/8 SCREW FLAT WASHER

QTY - 4

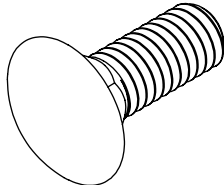

3/8-16 X 1 SQUARE NECK
CARRIAGE BOLT

QTY - 4

LET'S GET STARTED!

1. IF YOUR VAN IS EQUIPPED WITH A FACTORY STEP ON THE SIDE OF YOUR TOW HITCH YOU MUST REMOVE IT BEFORE INSTALLING YOUR NEW REAR TUBE STEP. IF YOU DON'T HAVE A FACTORY STEP, SKIP TO THE NEXT ASSEMBLY STEP.
2. GRAB BOTH THE PASSENGER AND DRIVER SIDE BRACKETS, M12-1.75 X 40 FLANGED HEX HEAD SCREWS, M12 WASHERS, AND M12-1.75 NYLON INSERT LOCKNUTS. THE BRACKET ATTACH THROUGH THE TWO HOLES ON EITHER SIDE OF THE FACTORY TOW HITCH AS SHOWN IN **DETAIL 1**. TIGHTEN THESE BOLTS DOWN.

NOTE- YOU'LL LIKELY NEED TO CLIP THE ZIP TIE THROUGH ONE OF THE MOUNT HOLES THAT HOLDS THE TRAILER WIRING. THIS CAN BE RELOCATED.

DETAIL 1



TIGHTEN DOWN

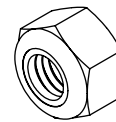
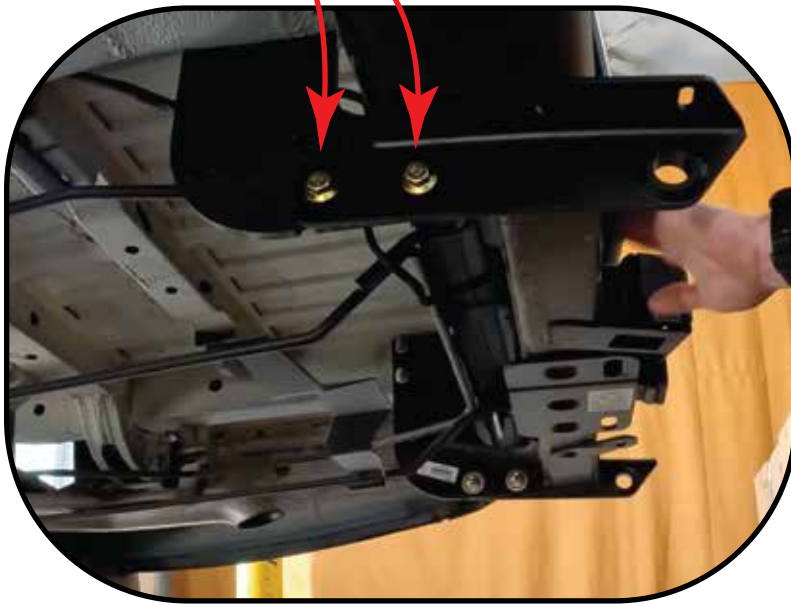

M12-1.75 NYLON INSERT
LOCKNUT

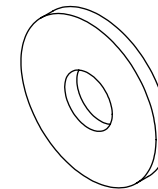

M12 SCREW X 37 O.D.
OVERSIZED FLAT WASHER

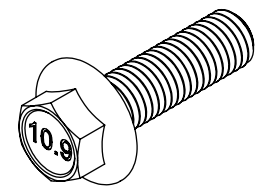

M12-1.75 X 40 FLANGED
HEX HEAD SCREW

3. NOW, GRAB THE **REAR TUBE STEP** AND REST IT ON TOP OF THE **BRACKETS** YOU JUST ATTACHED TO THE TOW HITCH. INSERT THE **3/8-16 X 1 SQUARE NECK CARRIAGE BOLTS** UP FROM THE BOTTOM AND THROUGH THE **ATTACHMENT BRACKETS** OF THE REAR TUBE STEP. PLACE A **3/8 WASHER** UNDERNEATH EACH **3/8-16 NYLON INSERT LOCKNUT** AND TIGHTEN DOWN BUT LEAVE THE HARDWARE LOOSE ENOUGH TO ALLOW MOVEMENT OF THE STEP.

NOTE- A RATCHETING BOX WRENCH COMES IN HANDY HERE FOR THOSE AWKWARD POSITIONS WHEN TIGHTENING THE HARDWARE.

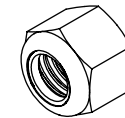
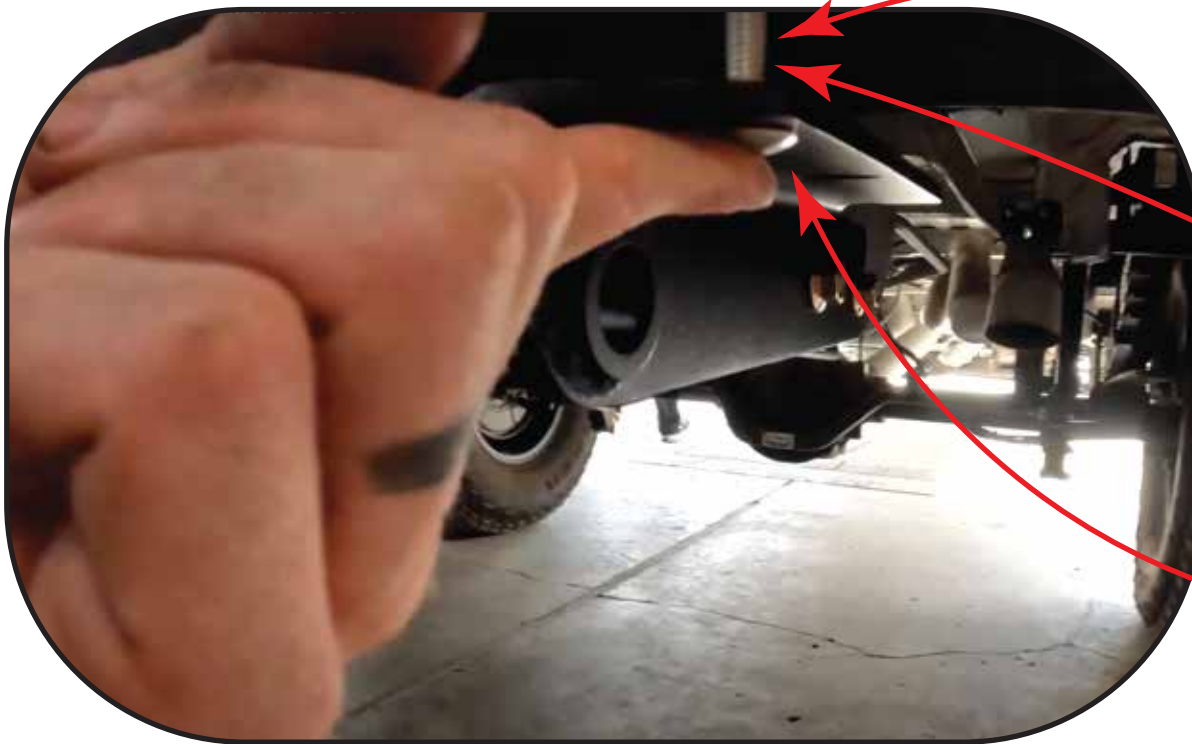
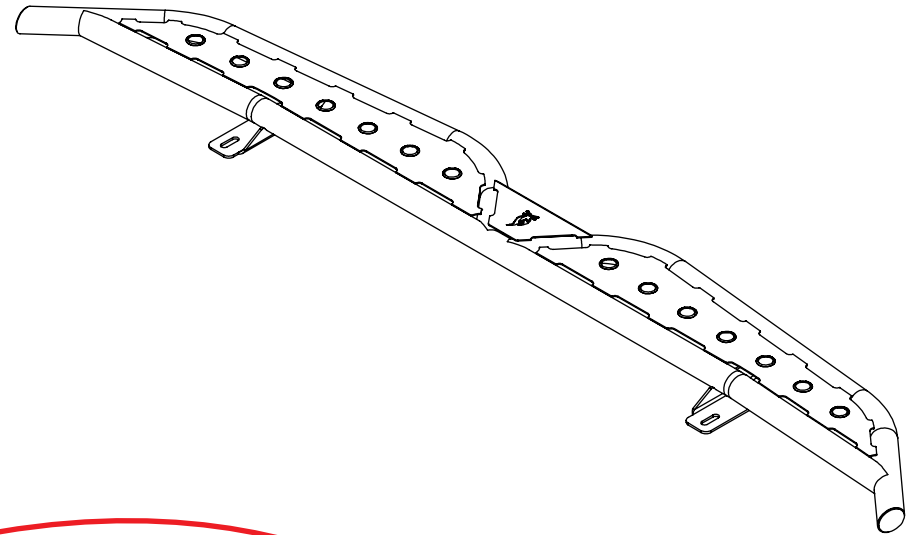

3/8-16 NYLON INSERT
LOCKNUT



3/8 SCREW FLAT WASHER

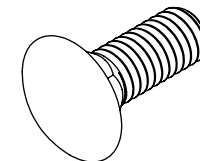

3/8-16 X 1 SQUARE NECK
CARRIAGE BOLT

4. NEXT, ALIGN THE REAR STEP WITH THE BUMPER OF YOUR VAN. ONCE SATISFIED WITH ALIGNMENT, TIGHTEN ALL OF THE FASTENERS. YOU ARE FINISHED!

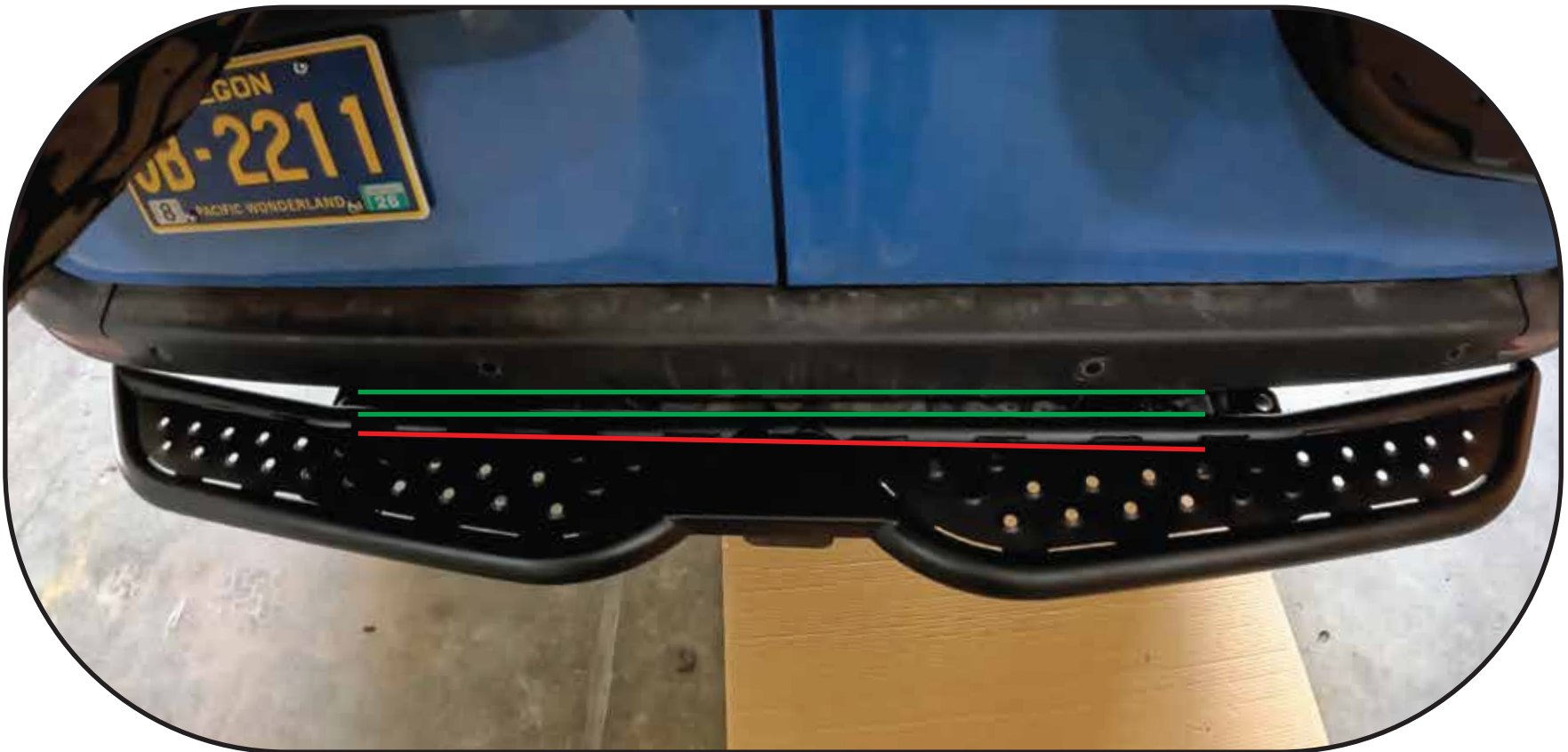

5. MOUNTING BOSSES ON THE REAR STEP ARE DESIGNED TO ACCEPT STANDARD 3/4 RECOVERY SHACKLES WITH A 7/8" PIN.
NOTE- WE PREFER TO USE RECOVERY SHACKLES THAT INCLUDE RUBBER WASHERS TO ELIMINATE ANY RATTLING.



GET OUT AND EXPLORE!

LEAVE US A REVIEW

Happy with your new FVC product? We would love to hear (and see) from you! Head to the product page and click "Leave Review." Add a short review and upload a few photos to be showcased on the product page.

SHARE YOUR PHOTOS WITH US

We love seeing how our customers use their FVC products and following along with your adventures. Tag us in your photos with @flatlinevanco or send them to us via email. We love posting customer pictures in our feed!

CUSTOMER SUPPORT

If you are having any issues with your product, please reach out, and we will make it right. FVC is a company of van and outdoor enthusiasts that design and use our own products, so we want you to be as stoked on your new parts as we are!



@flatlinevanco



facebook.com/flatlinevanco



youtube.com/c/flatlinevanco



support@flatlinevanco.com



thanks!