

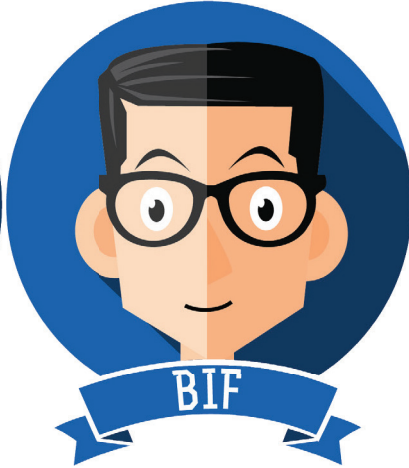

*"Your Number One Source for
Energy Efficient Lighting"*

MEET THE

RETROFIT BROTHERS



PERFECT LED RECESSED RETROFIT SOLUTIONS



Bolt On Board



Built in Frame

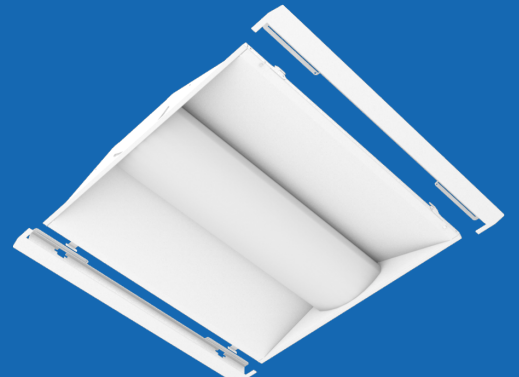

Latch & Close



| | |
|-----------------|---------------|
| Project Name: | |
| Catalog Number: | Fixture Type: |
| Volts/Watts: | Lamps/Board: |



BOB

LED - BOLT ON BOARD



Specifications:

- LED Board And Driver Kits For Recessed Lighting Applications
- ETL Listed LED Retrofit Kit (UL1598C) For 2x2, 2x4, & 1x4 Troffers
- 3000K, 3500K, 4000K, & 5000K Color Options
- Diffuse Light With Optional Frosted Sheet (Contact Factory)
- Multiple Light Outputs
- 0-10V Dimmable Drivers (100% - 5%)
- Philips LED Boards
- 5 Yr. Warranty
- All Necessary Hardware Included:
 - Ballast Disconnect
 - Self Tapping Screws
 - Jumper Wires
 - Power Wires
 - Ground Wires
 - Wire Nuts
 - Ground And Rating Labels
- DesignLights Consortium® Qualified Luminaire

Applications

- 2x2's
- 2x4's
- 1x4's
- Parabolic Louvers
- Prismatic Louvers

Performance Guide

| Part # | Wattage | Lumens | Lm/W | L70 | CRI | Replaces |
|------------------------|---------|--------|------|------|-----|----------|
| BOB-23WLED-2BD-UNIV-40 | 23 | 2,316 | 101 | >100 | >80 | 1T8 |
| BOB-31WLED-4BD-UNIV-40 | 31 | 3,781 | 122 | >100 | >80 | 1T8 |
| BOB-36WLED-4BD-UNIV-40 | 36 | 4,313 | 120 | >100 | >80 | 2T8 |
| BOB-45WLED-4BD-UNIV-40 | 45 | 5,297 | 117 | >100 | >80 | 3T8 |

Lm/W = Lumens Per Watt

Options

Accessories

| | |
|---------|--|
| ADH | Factory Installed Adhesive |
| PW | Pre-Wired And Assembled Kit From Factory |
| ILBCP05 | 5W LED Field Wired Battery Backup |
| ILBCP07 | 7W LED Field Wired Battery Backup |
| ILBCP10 | 10W LED Field Wired Battery Backup |
| ILBCP12 | 12W LED Field Wired Battery Backup |

ABOUT BOB

BOB is always the most analytical brother and is willing to work through any challenge. BOB believes that the most efficient way to convert an office fixture is to simply insert boards directly into the fixture. BOB asserts that this is the most environmentally friendly approach because it reduces the waste stream by retaining the fixture's existing lens or louver. BOB simply screws boards into the existing fixture while inserting the new driver under the cover with the old ballast (you can even leave the ballast in the fixture). The BOB approach is the most cost effective and has the least amount of waste. To reduce glare, BOB sometimes lays a frosted sheet over the prismatic lens or parabolic louver. It looks great, but you do lose a bit of the light!

INSTRUCTIONS FOR BOB - BOLT ON BOARD

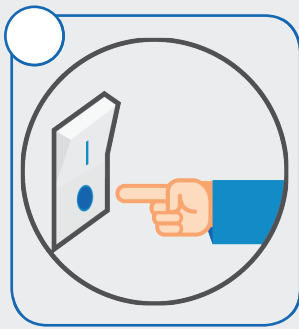

STEP 1

Shut off or disconnect power to the fixture.

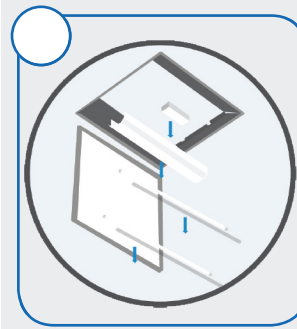

STEP 2

Remove existing fluorescent lamps and bypass the ballast.

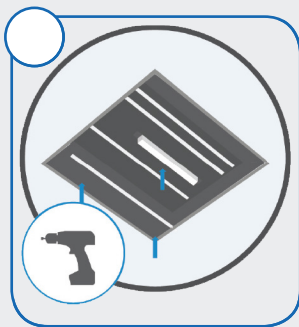

STEP 3

Install LED boards and driver.

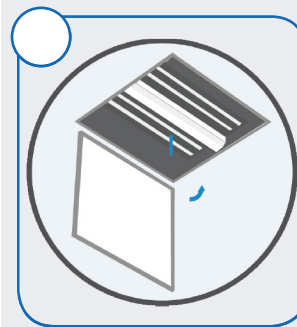

STEP 4

Reinstall original optic and ballast cover.

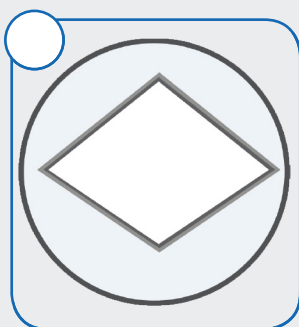

STEP 5

Install additional frosted sheet if ordered.

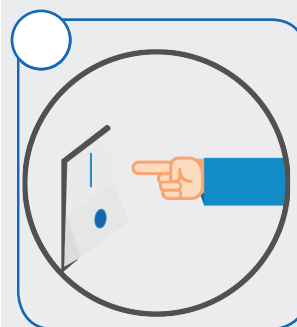

STEP 6

Turn on main power.

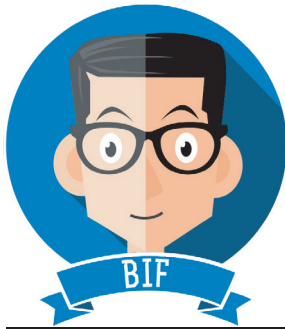

| | |
|-----------------|---------------|
| Project Name: | |
| Catalog Number: | Fixture Type: |
| Volts/Watts: | Lamps/Board: |



BIF

LED - BUILT IN FRAME

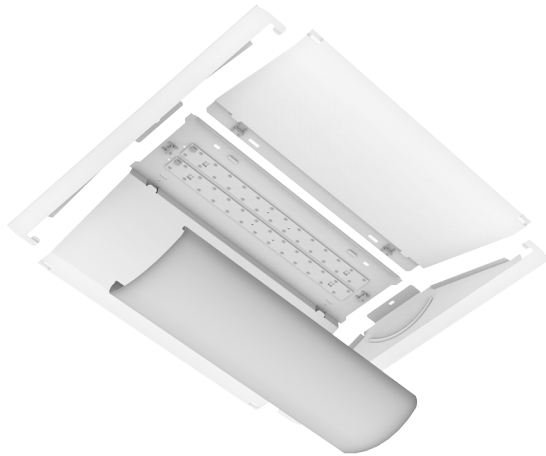

Specifications:

- Upgrade Any 2x2 or 2x4 Fluorescent Troffer To LED With Modern Architectural Styling
- 24 LEDs Per Module Spaced 3/4 Inch Apart Results In Low Pixilation
- No Tools Required For Easy Installation Into The Existing Fixture Housing
- Average Install Time: 5 Minutes
- 0-10V Dimmable Driver (100% - 10%)
- Available In 4000K
- 5 Yr. Warranty
- DesignLights Consortium® Qualified Luminaire

Applications

- 2x2's
- 2x4's
- Parabolic Louvers
- Prismatic Louvers



Performance Guide

| Part # | Wattage | Lumens | Lm/W | L70 | CRI | Replaces |
|----------------------|---------|--------|------|------|-----|----------|
| BIF22-25WLED-UNIV-40 | 24 | 2,760 | 115 | >100 | >80 | 2T8 |
| BIF22-30WLED-UNIV-40 | 30 | 3,600 | 120 | >100 | >80 | 3T8 |
| BIF24-30WLED-UNIV-40 | 30 | 3,600 | 120 | >100 | >80 | 2T8 |
| BIF24-37WLED-UNIV-40 | 36 | 4,500 | 125 | >100 | >80 | 2T8 |
| BIF24-43WLED-UNIV-40 | 44 | 5,160 | 117 | >100 | >80 | 3T8 |

Lm/W = Lumens Per Watt

Options

Accessories

- ILBCP05 5W LED Field Wired Battery Backup
- ILBCP07 7W LED Field Wired Battery Backup
- ILBCP10 10W LED Field Wired Battery Backup
- ILBCP12 12W LED Field Wired Battery Backup

ABOUT BIF

BIF is the stylish brother. He is all about fit, finish, and architectural appeal and will go to any length to ensure that a retrofit is indistinguishable from a new fixture. BIF does not want to see screws, or latches, or clasps. BIF wants to build the retrofit using the grid ceiling as the frame and then assemble the four sides with the fastening hardware under a beautiful rounded lens that hides the LEDs and has a warm glow. The seams are all tight and the result is a retrofit that looks like new.

INSTRUCTIONS FOR BIF - BUILT IN FRAME

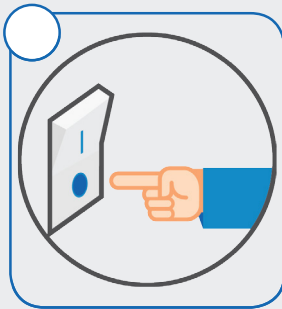

STEP 1

Shut off or disconnect power to the fixture.

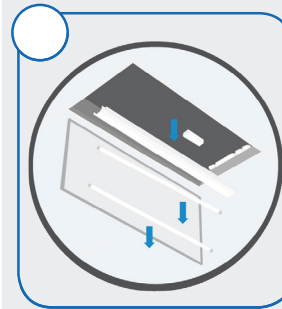

STEP 2

Remove existing fluorescent lamps and components, then disconnect existing connections to the fluorescent ballast.

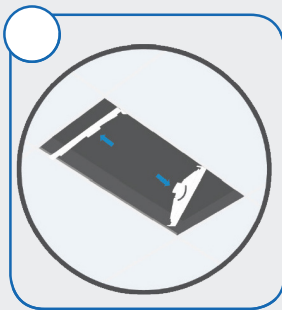

STEP 3

Gently lift the original housing and insert the brackets between the housing and the T-grid.

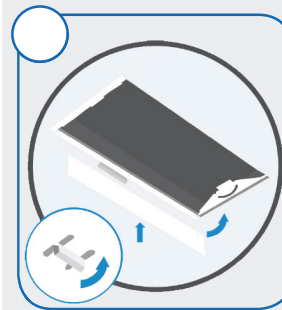

STEP 4

Install the gear panel by first hooking the slots into the respective tabs in the end panels. Rotate the fasteners to secure in place.

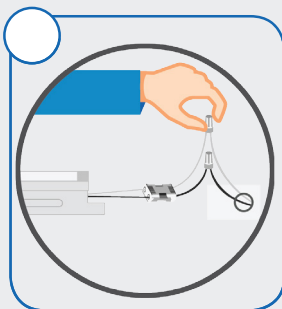

STEP 5

Connect the BIF to AC power and ground.

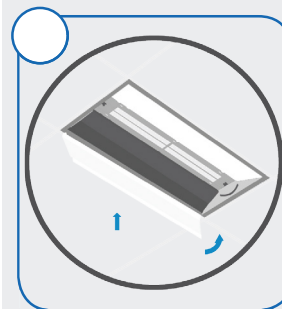

STEP 6

Install the side panel by first hooking the slots into the respective tabs in the end panels. Rotate the fasteners to secure in place.

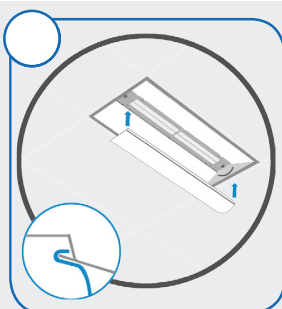

STEP 7

Install the lens by hooking onto the tabs on the gear panel and the side panel.

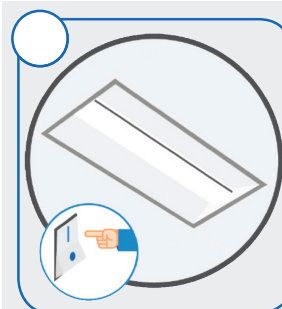

STEP 8

Turn on or reconnect power to the fixture to complete the installation.



| | |
|-----------------|---------------|
| Project Name: | |
| Catalog Number: | Fixture Type: |
| Volts/Watts: | Lamps/Board: |



LANCE 1'X4'

LED - LATCH AND CLOSE



Specifications:

- LED Retrofit Kit For Recessed Lighting Applications
- One-Piece Unit With Two Universal Mounting Brackets
- Universal Brackets Allow For Install In Grid Or Hard Lid Ceilings
- Multiple Lumen Outputs Available
- 3000K, 3500K, 4000K, And 5000K Color Options
- 0-10V Dimmable Driver (100% - 5%)
- EasySense Control Available
- Philips Light Engines
- 5 Yr. Warranty
- Average Install Time: Less Than 3 Minutes
- DesignLights Consortium® Qualified Luminaire

ILP Recommends a Test Install Be Performed Prior to Placing Order

Applications

- 1x4
- Parabolic Louvers
- Prismatic Lenses



Performance Guide

| Part # | Wattage | Lumens | Lm/W | L70 | CRI | Replaces |
|------------------------|---------|--------|------|-------|-----|----------|
| LANCE14-13WLED-UNIV-40 | 13 | 1,579 | 116 | >100K | >80 | 1T8 |
| LANCE14-22WLED-UNIV-40 | 22 | 2,705 | 122 | >100K | >80 | 1T8 |
| LANCE14-30WLED-UNIV-40 | 30 | 3,545 | 118 | >100K | >80 | 2T8 |
| LANCE14-35WLED-UNIV-40 | 35 | 4,042 | 114 | >100K | >80 | 1T5HO |
| LANCE14-42WLED-UNIV-40 | 42 | 4,765 | 112 | >100K | >80 | 3T8 |
| LANCE14-52WLED-UNIV-40 | 52 | 6,215 | 120 | >100K | >80 | 4T8 |
| LANCE14-59WLED-UNIV-40 | 59 | 6,904 | 117 | >100K | >80 | 2T5HO |

Lm/W = Lumens Per Watt

Options

Accessories

- POSTP Post Painted Aluminum
- FI/ILBCP05 5W LED Factory Wired Battery Backup
- FI/ILBCP07 7W LED Factory Wired Battery Backup
- FI/ILBCP10 10W LED Factory Wired Battery Backup
- FI/ILBCP12 12W LED Factory Wired Battery Backup
- SD347 347V Step Down Transformer

Controls

- ES EasySense Control
- ES/PCD Pre-Installed App On Controlled Device For Commissioning
- ES/WWS EasySense Wall Switch
- BLD Bi-Level Dim Driver (2 Hot Leads)
- SR DALI-Enabled Ballast Installed
- DIMxx Factory Set Custom Dim Level (xx=Max Watts)



| | |
|-----------------|---------------|
| Project Name: | |
| Catalog Number: | Fixture Type: |
| Volts/Watts: | Lamps/Board: |



LANCE 2'X2'

LED - LATCH AND CLOSE

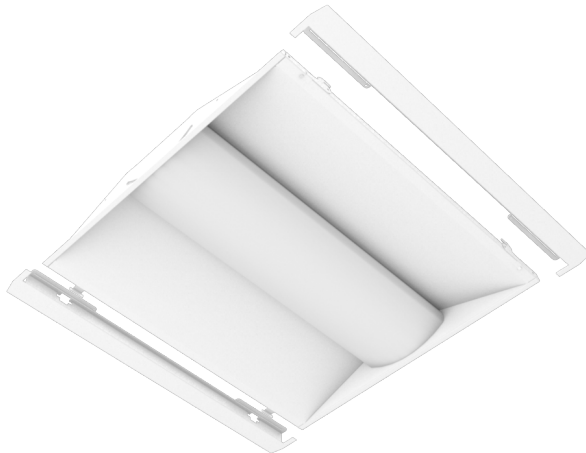

Specifications:

- LED Retrofit Kit For Recessed Lighting Applications
- One-Piece Unit With Two Universal Mounting Brackets
- Universal Brackets Allow For Install In Grid Or Hard Lid Ceilings
- Multiple Lumen Outputs Available
- 3000K, 3500K, 4000K, And 5000K Color Options
- Available in 90CRI (3500K And 4000K Color Options Only)
- 0-10V Dimmable Driver (100% - 5%)
- EasySense Control Available
- Philips Light Engines
- 5 Yr. Warranty
- Average Install Time: Less Than 3 Minutes
- DesignLights Consortium® Qualified Luminaire

ILP Recommends a Test Install Be Performed Prior to Placing Order

Applications

- 2x2
- Parabolic Louvers
- Prismatic Lenses



Performance Guide

| Part # | Wattage | Lumens | Lm/W | L70 | CRI | Replaces |
|------------------------|---------|--------|------|-------|-----|----------|
| LANCE22-16WLED-UNIV-40 | 16 | 1,884 | 116 | >100K | >80 | 2T8 |
| LANCE22-22WLED-UNIV-40 | 22 | 2,572 | 113 | >100K | >80 | 2T8 |
| LANCE22-30WLED-UNIV-40 | 30 | 3,261 | 108 | >100K | >80 | 3T8 |
| LANCE22-35WLED-UNIV-40 | 35 | 3,650 | 105 | >100K | >80 | 3T8 |
| LANCE22-42WLED-UNIV-40 | 42 | 4,766 | 112 | >100K | >80 | 4T8 |
| LANCE22-52WLED-UNIV-40 | 52 | 6,128 | 117 | >100K | >80 | 6T8 |

90CRI

| | | | | | | |
|------------------------------|----|-------|-----|-------|-----|-----|
| LANCE22-16WLED-UNIV-40-90CRI | 17 | 1,924 | 112 | >100K | >90 | 2T8 |
| LANCE22-22WLED-UNIV-40-90CRI | 22 | 2,501 | 112 | >100K | >90 | 2T8 |
| LANCE22-30WLED-UNIV-40-90CRI | 30 | 3,302 | 111 | >100K | >90 | 3T8 |
| LANCE22-35WLED-UNIV-40-90CRI | 35 | 3,769 | 109 | >100K | >90 | 3T8 |

Lm/W = Lumens Per Watt

Options

Accessories

| | |
|------------|--------------------------------------|
| POSTP | Post Painted Aluminum |
| FI/ILBCP05 | 5W LED Factory Wired Battery Backup |
| FI/ILBCP07 | 7W LED Factory Wired Battery Backup |
| FI/ILBCP10 | 10W LED Factory Wired Battery Backup |
| FI/ILBCP12 | 12W LED Factory Wired Battery Backup |
| SD347 | 347V Step Down Transformer |

Controls

| | |
|--------|--|
| ES | EasySense Control |
| ES/PCD | Pre-Installed App On Controlled Device For Commissioning |
| ES/WWS | EasySense Wall Switch |
| BLD | Bi-Level Dim Driver (2 Hot Leads) |
| SR | DALI-Enabled Ballast Installed |
| DIMxx | Factory Set Custom Dim Level (xx=Max Watts) |



| | |
|-----------------|---------------|
| Project Name: | |
| Catalog Number: | Fixture Type: |
| Volts/Watts: | Lamps/Board: |



LANCE 2'X4'

LED - LATCH AND CLOSE



Specifications:

- LED Retrofit Kit For Recessed Lighting Applications
- One-Piece Unit With Two Universal Mounting Brackets
- Universal Brackets Allow For Install In Grid Or Hard Lid Ceilings
- Multiple Lumen Outputs Available
- 3000K, 3500K, 4000K, And 5000K Color Options
- Available in 90CRI (3500K And 4000K Color Options Only)
- 0-10V Dimmable Driver (100% - 5%)
- EasySense Control Available
- Philips Light Engines
- 5 Yr. Warranty
- Average Install Time: Less Than 3 Minutes
- DesignLights Consortium® Qualified Luminaire

ILP Recommends a Test Install Be Performed Prior to Placing Order

Applications

- 2x4
- Parabolic Louvers
- Prismatic Lenses



Performance Guide

| Part # | Wattage | Lumens | Lm/W | L70 | CRI | DLC Premium | Replaces |
|------------------------|---------|--------|------|-------|-----|-------------|----------|
| LANCE24-22WLED-UNIV-40 | 22 | 2,950 | 127 | >100K | >80 | • | 1T8 |
| LANCE24-30WLED-UNIV-40 | 30 | 3,756 | 125 | >100K | >80 | • | 2T8 |
| LANCE24-35WLED-UNIV-40 | 35 | 4,256 | 121 | >100K | >80 | | 2T8 |
| LANCE24-42WLED-UNIV-40 | 42 | 4,960 | 116 | >100K | >80 | | 3T8 |
| LANCE24-52WLED-UNIV-40 | 52 | 6,454 | 121 | >100K | >80 | | 4T8 |
| LANCE24-59WLED-UNIV-40 | 59 | 7,265 | 123 | >100K | >80 | | 2T5HO |

90CRI

| Part # | Wattage | Lumens | Lm/W | L70 | CRI | Replaces |
|------------------------------|---------|--------|------|-------|-----|----------|
| LANCE24-30WLED-UNIV-40-90CRI | 29 | 3,281 | 111 | >100K | >90 | 1T8 |
| LANCE24-35WLED-UNIV-40-90CRI | 35 | 3,824 | 110 | >100K | >90 | 2T8 |
| LANCE24-42WLED-UNIV-40-90CRI | 42 | 4,539 | 109 | >100K | >90 | 3T8 |

Lm/W = Lumens Per Watt

Options

Accessories

- POSTP Post Painted Aluminum
- FI/ILBCP05 5W LED Factory Wired Battery Backup
- FI/ILBCP07 7W LED Factory Wired Battery Backup
- FI/ILBCP10 10W LED Factory Wired Battery Backup
- FI/ILBCP12 12W LED Factory Wired Battery Backup
- SD347 347V Step Down Transformer

Controls

- ES EasySense Control
- ES/PCD Pre-Installed App On Controlled Device For Commissioning
- ES/WWS EasySense Wall Switch
- BLD Bi-Level Dim Driver (2 Hot Leads)
- SR DALI-Enabled Ballast Installed
- DIMxx Factory Set Custom Dim Level (xx=Max Watts)



| | |
|-----------------|---------------|
| Project Name: | |
| Catalog Number: | Fixture Type: |
| Volts/Watts: | Lamps/Board: |



VALUE LANCE 2'X4'

LED - LATCH AND CLOSE

Specifications:

- LED Retrofit Kit For Recessed Lighting Applications
- One-Piece Unit With Two Universal Mounting Brackets
- Universal Brackets Allow For Install In Grid Or Hard Lid Ceilings
- Multiple Lumen Outputs Available
- 3500K, & 4000K Color Options
- 0-10V Dimmable Driver (100% - 5%)
- Use Part Number DIMxx To Set Specific Wattage
- EasySense Control Available (Dimmable Options Only)
- Philips Light Engines
- 5 Yr. Warranty
- Average Install Time: Less Than 3 Minutes
- DesignLights Consortium® Premium Qualified Luminaire

ILP Recommends a Test Install Be Performed Prior to Placing Order

Applications

- 2x4
- Parabolic Louvers
- Prismatic Lenses



Performance Guide

Non-Dimmable Options

| Part # | Wattage | Lumens | Lm/W | L70 | CRI | Replaces |
|-------------------------|---------|--------|------|-------|-----|----------|
| VLN24-23WLED-UNIV-40-ND | 19 | 2828 | 148 | >100K | >80 | 2T8 |
| VLN24-35WLED-UNIV-40-ND | 33 | 4634 | 140 | >100K | >80 | 3T8 |

Dimmable Options

| | | | | | | |
|----------------------|----|-------|-----|-------|-----|-----|
| VLN24-23WLED-UNIV-40 | 22 | 3,159 | 141 | >100K | >80 | 2T8 |
| VLN24-26WLED-UNIV-40 | 26 | 3,466 | 136 | >100K | >80 | 2T8 |
| VLN24-31WLED-UNIV-40 | 31 | 4,378 | 139 | >100K | >80 | 3T8 |
| VLN24-35WLED-UNIV-40 | 35 | 4,853 | 137 | >100K | >80 | 3T8 |
| VLN24-38WLED-UNIV-40 | 38 | 4,978 | 132 | >100K | >80 | 3T8 |
| VLN24-46WLED-UNIV-40 | 48 | 6,300 | 132 | >100K | >80 | 4T8 |

Lm/W = Lumens Per Watt

Options

Accessories

| | |
|------------|--------------------------------------|
| DIMXX* | Set Specific Wattage |
| POSTP | Post Painted Aluminum |
| FI/ILBCP05 | 5W LED Factory Wired Battery Backup |
| FI/ILBCP07 | 7W LED Factory Wired Battery Backup |
| FI/ILBCP10 | 10W LED Factory Wired Battery Backup |
| FI/ILBCP12 | 12W LED Factory Wired Battery Backup |
| SD347 | 347V Step Down Transformer |

www.ilp-inc.com

Controls

| | |
|---------|--|
| ES* | EasySense Control |
| ES/PCD* | Pre-Installed App On Controlled Device For Commissioning |
| ES/WWS* | EasySense Wall Switch |
| BLD* | Bi-Level Dim Driver (2 Hot Leads) |

*Incompatible With Non-Dimming Fixtures

ABOUT LANCE

LANCE always felt like the moderator between BIF and BOB. He likes a clean finish and a beautiful lens; however, he believes that installation time and serviceability are critical and worth the required up front investment. LANCE simply places a hinge and latch rail between the grid and the existing fixture, using that as a connection point for a complete unit that closes like a prismatic lens frame. The finish is clean with a high level of serviceability and extremely fast installation. The best part about LANCE is the wide range of options available. LANCE can accommodate sensors, air handling, and has a broad range of color options. LANCE is ARRA and NAFTA compliant.

INSTRUCTIONS FOR LANCE - LATCH AND CLOSE

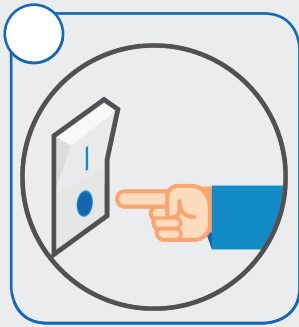

STEP 1

Shut off or disconnect power to the fixture.

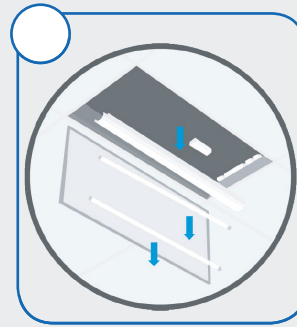

STEP 2

Remove existing fluorescent lamps and components, then disconnect existing connections to the fluorescent ballast.

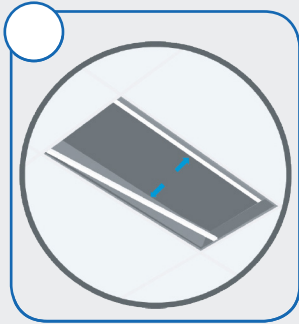

STEP 3

Gently lift the original housing and insert the brackets between the housing and the T-grid. Allow the housing to rest on the brackets, securing them in place.

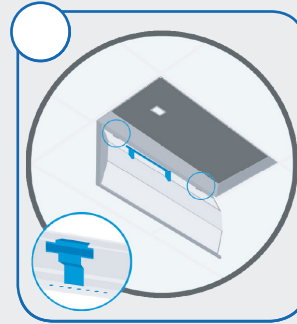

STEP 4

Hang the LANCE body by hooking the T-hinges into the respective slots in the brackets.

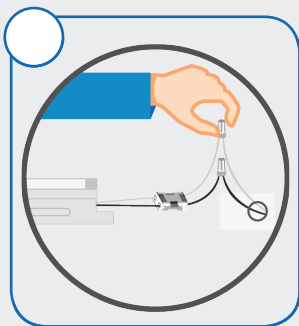

STEP 5

Connect the LANCE to AC power and ground.

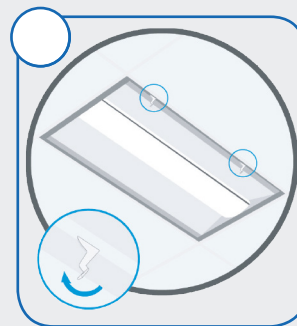

STEP 6

Rotate the LANCE body up into the fixture and close the latches. Turn on or reconnect power to the fixture to complete the installation.

TURBO LANCE

Retrofit Application



2x2 FLTR (No Rails)

2x4 LANCE (Air Handling)



Specifications

- LED Retrofit Kit For Recessed Lighting Applications
- Replaces Parabolics, Lensed Door Frames, & Air Handling Units w/ One Piece.
- Custom Kit Designed Per Application
- 1x4, 2x2, & 2x4 Retrofit Solutions
- Volumetric Or Flat Lens Options
- Pre-Painted Aluminum (Std.)
- Postpaint Option Available
- Connected Controls
 - EasySense
 - Enlighted
 - Magnum
- Battery Backup Options
- Bi-Level Dim Options
- Tool-less Access To Driver
- ETL Listed
- 5 Year Warranty
- DesignLights Consortium® Qualified Luminaire

Applications

- Office Buildings
- Schools
- Retail

Performance Options

- 13W - 59W (1,679lm - 7,265lm)

Process

1) Fill Out Form

2) Send Door Frame and/or Fixture to be Modeled

Job Name: _____

Qty of Fixtures: _____

Distributor/REP: _____

Phone Number: _____

Fixture Dimensions: Length: _____

Width: _____

Depth: _____

Door Frame Dimensions: Length: _____

Width: _____

Depth: _____

Desired Wattage: _____

Color Temperature: _____

Voltage: _____

Desired Lumens: _____

Sensor: _____

Dimming: _____

Air Handling:

Picture of Housing:

RETROFIT BROTHERS

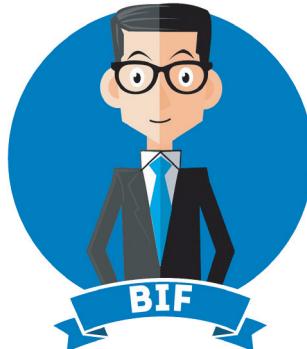

Three brothers who care deeply about the environment and saving energy, but could never agree on much else. Each has their own independent style and while BOB, BIF, and LANCE agree that all office lighting fixtures should be converted to LED, each has a unique approach.

WHY RETROFIT?

ESTIMATED SAVINGS / UNIT

LESS TIME

Time is money. On average it takes less than half the time to install a retrofit kit as a new fixture. A new fixture requires support and necessitates removal of adjacent tiles. Even after all the install effort, there is a big mess to clean up!

\$25

LESS WASTE

When retrofitting an existing fixture the only thing that you have to remove every time are the lamps and the lens or parabolic louver. The ballast, in most cases, can be left in the fixture. Even when you recycle parts of an entire fixture, the labor and disposal are still costly.

\$5

LOWER LABOR RATE

Replacing a new fixture always requires a licensed electrician. Retrofitting can often be done by a maintenance contractor at a lower hourly rate. Check with your local permitting office to see what your local laws allow.

\$25

LESS MATERIAL COST

Retrofit Kits are typically \$5 to \$15 less than a new fixture.

\$10

TOTAL ESTIMATED SAVING / UNIT :

\$65



Ph: 407-478-3759 Fax: 407-478-3760
519 Codisco Way, Sanford, FL 32771
www.ilp-inc.com

