

Infinity Tablet Stand

ASSEMBLY INSTRUCTIONS

BOX CONTENTS

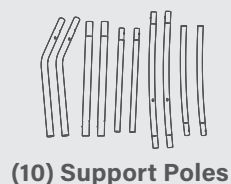

(10) Support Poles

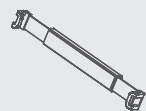

(1) Tablet Mount

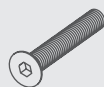

(1) Back Screw

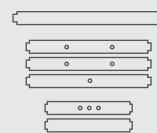

(6) Crossbars

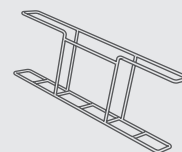

(2) Literature Racks



(2) End Poles



(4) Corner Poles

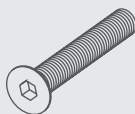

(8) Frame Screws



(4) Shelf Clips



(1) Display Graphic

BOX CONTENTS - TV MONITOR HARDWARE



(1) TV Mount



(2) TV Mount Brackets



(4) M5/M6 Washers



(4) Spacers



(4) M5 x 30mm



(4) M6 x 30mm



(4) M8 x 30mm

NOT FOR USE WITH DISPLAY



(6) Wall Anchors



(6) TV mount Screws



(6) M8 Washers

1 Assemble the Frame

Assemble the frame of the display by connecting each pole to its corresponding number. Attach the Cross bars with the Frame Screws.

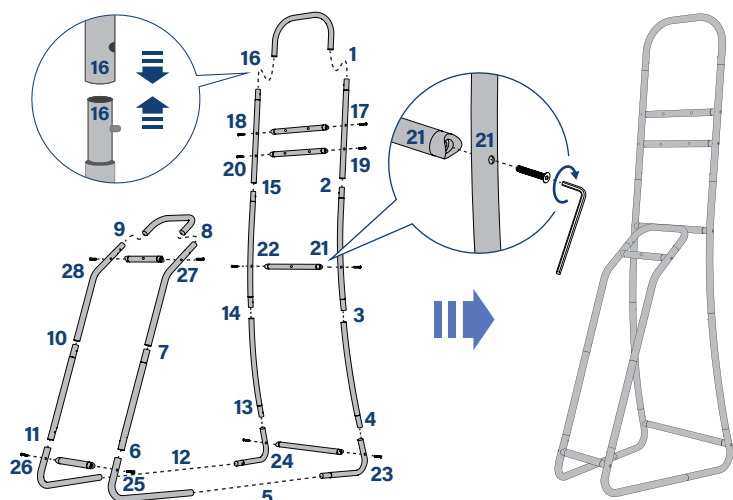

2 Install the Graphic

Carefully pull the graphic print over the frame, ensuring both sides are pulled down at the same time.

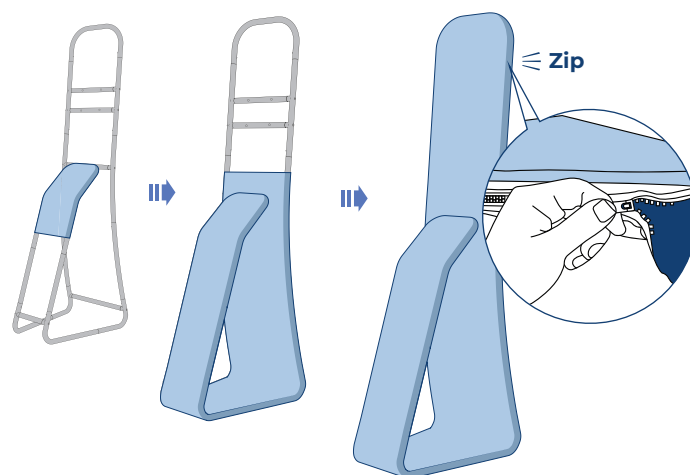

It helps to have a second person to pull the other side simultaneously.

3

Secure the Frame

Screw the front of the frame to the back using the Back Screw.

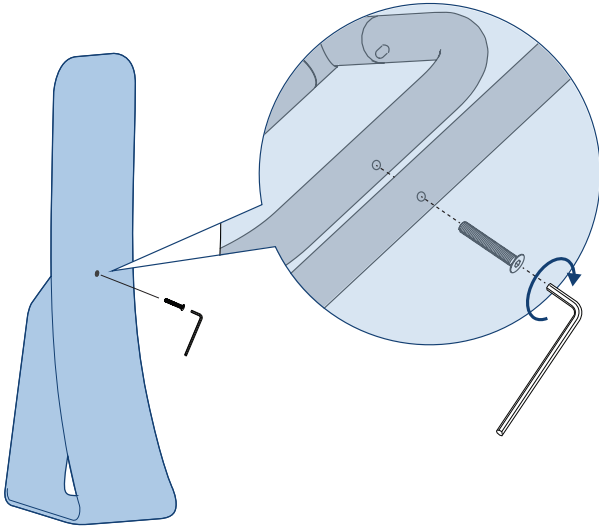

4

Attach the Shelving

Attach the Shelf Clips to the frame and then hook the Racks onto the Clips.

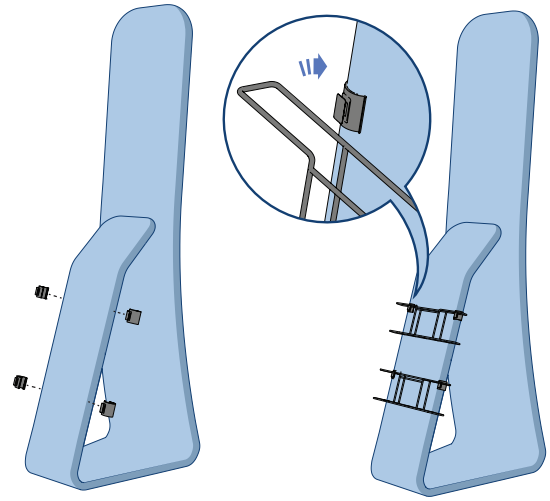

5

Attach the Tablet Mount

Place the Tablet mount in position on the front of the display and thread the large black hexagonal screws through the fabric and frame to meet.

Adjust the mount to fit your device and tighten the clamp screws until snug.

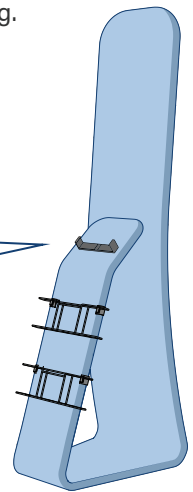
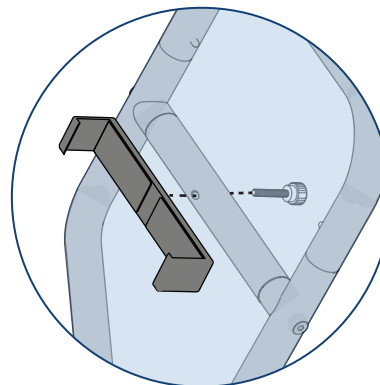
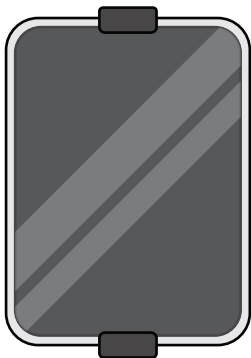

Screw the Mount in place from the back

6

Attach TV Mount

Screw the TV Mount on the Bridge using the M6 Screws and M6 Washers.

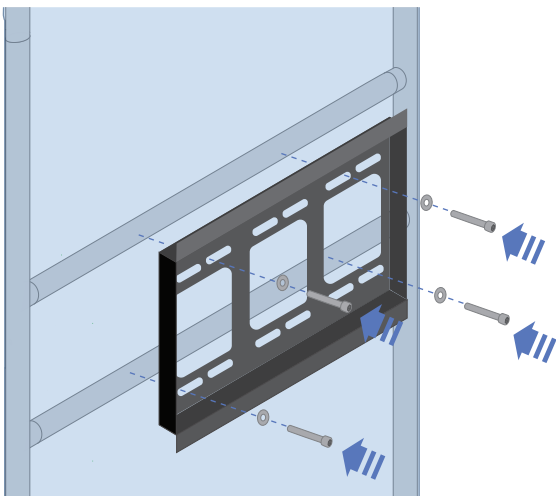

7

Attach Brackets to Monitor

Attach the brackets on your monitor using the 1" Thin Screws.

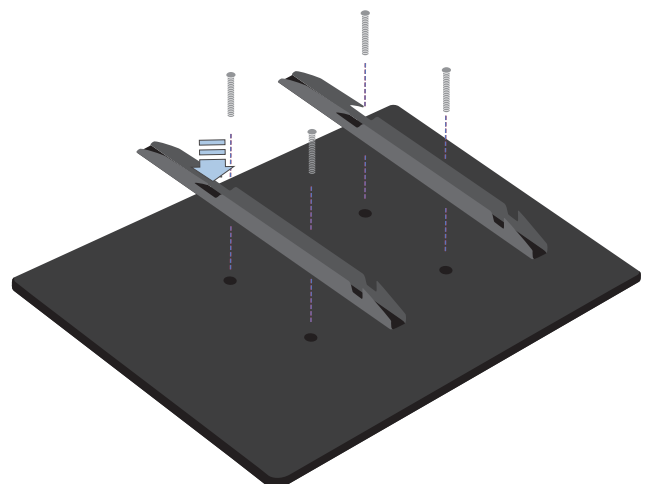

8

Mount the Monitor

Attach the monitor bracket hooks to the top of the monitor mount.

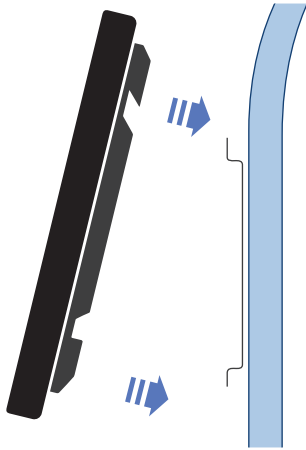

9

Secure the Brackets

Insert the 1.5" screws into the bottom holes of the brackets in order to safely secure the monitor to the mount.

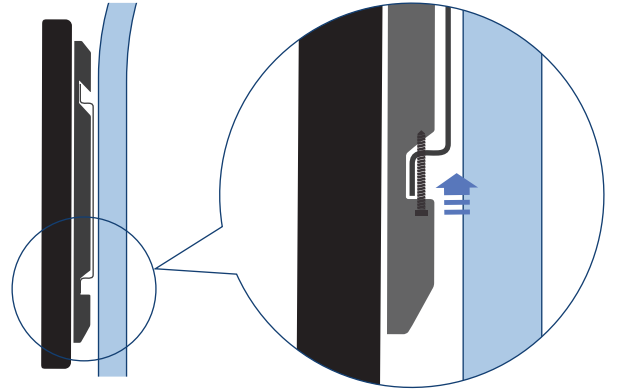

10

Example Configuration

