

QuickZip™ Merchandiser

ASSEMBLY INSTRUCTIONS

BOX CONTENTS

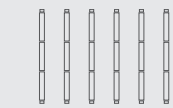

(6) Connected Poles

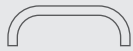

(1) End Pole

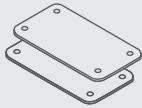

Countertop & Base

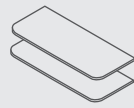

(2) Shelves

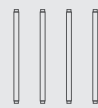

(4) Shelf Poles



(4) Shelving Mounts



(1) Backdrop Graphic
(Ships Separately)

1

Assemble the Frame

Connect the poles by matching up the poles to each other and the base of the frame.

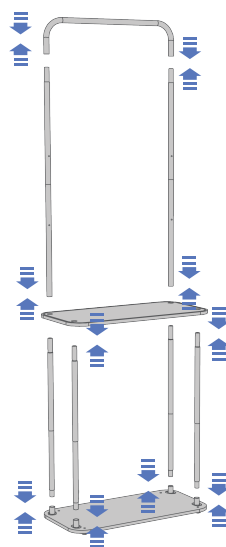

2

Install the Graphic

Carefully pull the graphic print over the frame, ensuring both sides are pulled down at the same time.

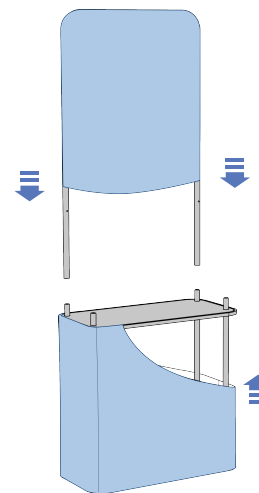

It helps to have a second person to pull the other side simultaneously.

3

Attach Shelves

Attach shelf poles and shelves onto countertop using shelving mounts as shown.

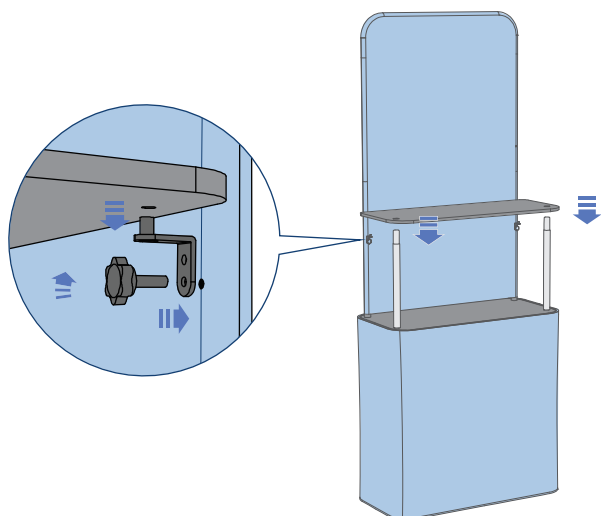

4

Align the Display

Stand up the frame and shift or wiggle the corners until it's aligned and standing straight.

