

lilitab Surface Pro Mount

Assembly Instructions

v3.0

TABLE OF CONTENTS

Assembly Preparation and Packing List	3
Features	4
Assembly Instructions	5
Bolt Down Installation	6

GOT QUESTIONS? WE'RE HERE TO HELP!

EMAIL support@lilitab.com **PHONE** 888.705.0190

MOUNT ASSEMBLY PREPARATION

FOR BASE PLATE INSTALLATION, YOU'LL NEED:

- ✓ Phillips screwdriver

FOR BOLT DOWN INSTALLATION, YOU'LL NEED:

- ✓ Powered drill/driver, preferably with impact action
- ✓ 4 x bolts or wood screws (m5, no.10, no.11, 3/16" or 13/64 diameter)

PACKING LIST

INCLUDED

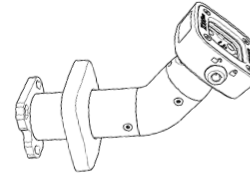

1 x Mount Post



2 x MagDOCK Keys



1 x Black L Key

INCLUDED IF YOU ORDERED COMPACT BASE PLATE



1 x Compact Base Plate



4 x 1/4-28 x 0.375 Compact Base Screws

FEATURES

Head unit shown for illustrative purposes only. Your head unit may vary depending upon your tablet choice. Please refer to your head unit owner manual for more details.

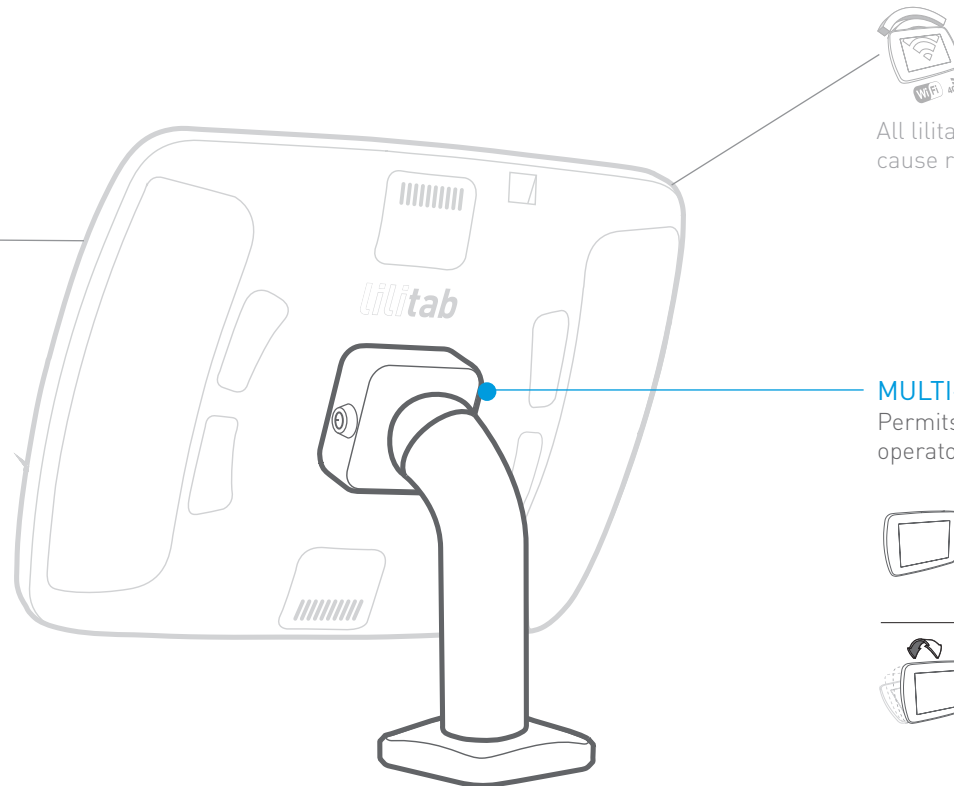

All lilitab head units do not cause radio interference.

MULTI-POSITION NECK JOINT

Permits tilt up/down. It has two operator configurable modes:



Fixed. The head unit can be set to any fixed angle between completely vertical and $\pm 22.5^\circ$.



Tilt. Can be configured to allow the user to tilt the head unit.

ASSEMBLY INSTRUCTIONS



- 1. Attach base plate.** Line up the bottom of the lilitab mount with the four screw holes in the base plate. Secure together using the **four (4) 1/4-28 x 0.375 Compact Base Screws**.



NOTE: You may need to hold the foot cover up and out of your way while securing.



- 2. Install the foot cover** by sliding the it gently down to pole to cover the screws (velcro will hold it in place once positioned).



- 3. Place your head unit onto the MagDOCK mount** in either landscape or portrait orientation. **Turn the key** to lock it in place.

WARNING: Not locking the MagDOCK will result in the unit falling off, possibly damaging the unit and/or the tablet. The lilitab Pro is designed to be operated with the lock closed.

Refer to your lilitab Head owner's manual for tablet installation instructions.



- 4. Tilt feature.** By default the lilitab head unit can be tilted by the user to suit. If you wish to disable tilt, position your head unit at the desired angle and tighten the bottom screw on the neck joint with the **Black L Key** provided.



BOLT DOWN INSTALLATION

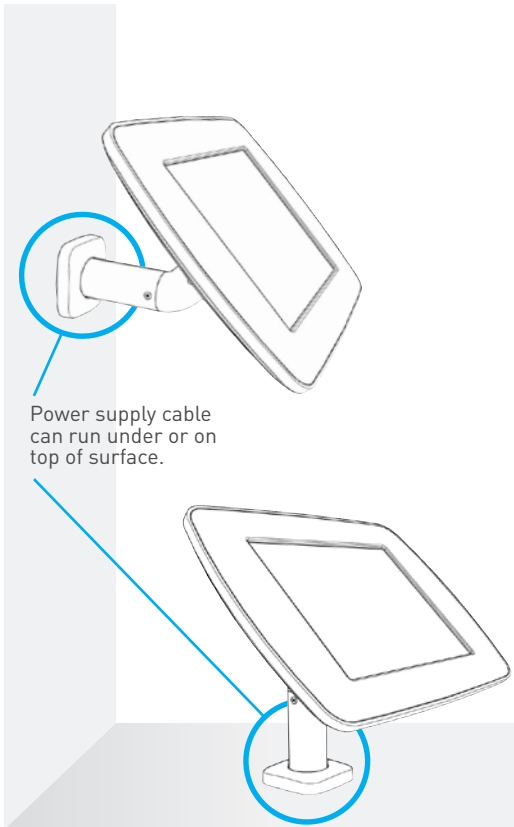

Power supply cable can run under or on top of surface.

The lilitab Surface Basic can be mounted horizontally or vertically to any hard surface using 2 x bolts, wood screws or other fastener suitable for your surface's substrate (m6, no.14 or 1/4" diameter). Use the mounting pattern to the right for proper alignment.

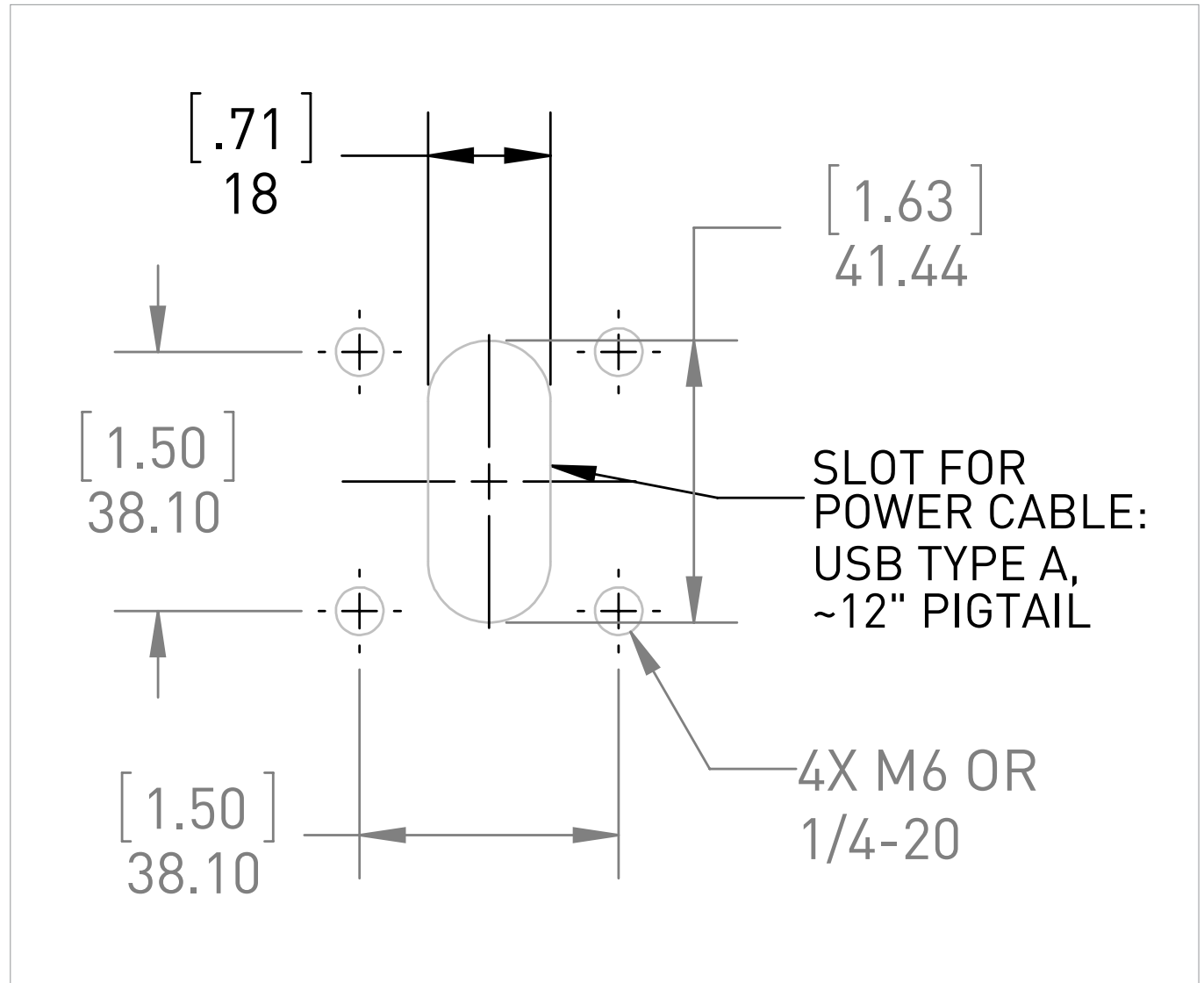

Mounting pattern