



# lilitab Counter Pro Mount

Assembly Instructions

v4.0

## TABLE OF CONTENTS

Assembly Preparation and Packing List . . . . .	3
Features . . . . .	4
Assembly Instructions . . . . .	5
Bolt Down Installation . . . . .	7

**GOT QUESTIONS? WE'RE HERE TO HELP!**

**EMAIL** [support@lilitab.com](mailto:support@lilitab.com)    **PHONE** 888.705.0190

## MOUNT ASSEMBLY PREPARATION

### FOR BASE PLATE INSTALLATION, YOU'LL NEED:

- ✓ Phillips screwdriver

### FOR BOLT DOWN INSTALLATION, YOU'LL NEED:

- ✓ Powered drill/driver, preferably with impact action
- ✓ 4 x bolts or wood screws (m5, no.10, no.11, 3/16" or 13/64 diameter)

## PACKING LIST

### INCLUDED

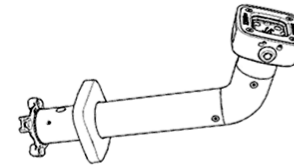

1 x Mount Post



2 x MagDOCK Keys



1 x Silver L Key



1 x Black L Key



3 x Screw Opening Caps

### INCLUDED IF YOU ORDERED COMPACT BASE PLATE



1 x Compact Base Plate



4 x 1/4-28 x 0.375 Compact Base Screws

# FEATURES

Head unit shown for illustrative purposes only. Your head unit may vary depending upon your tablet choice. Please refer to your head unit instructions for more details.

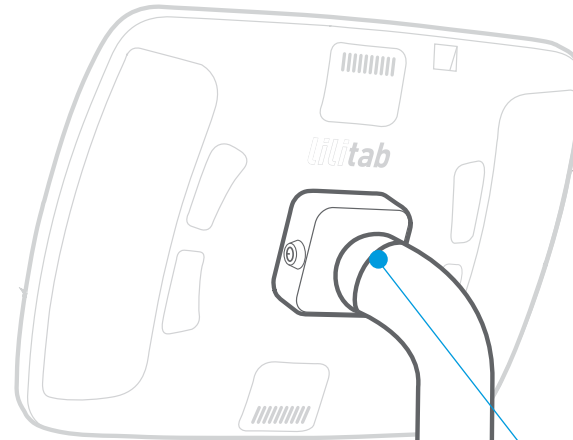
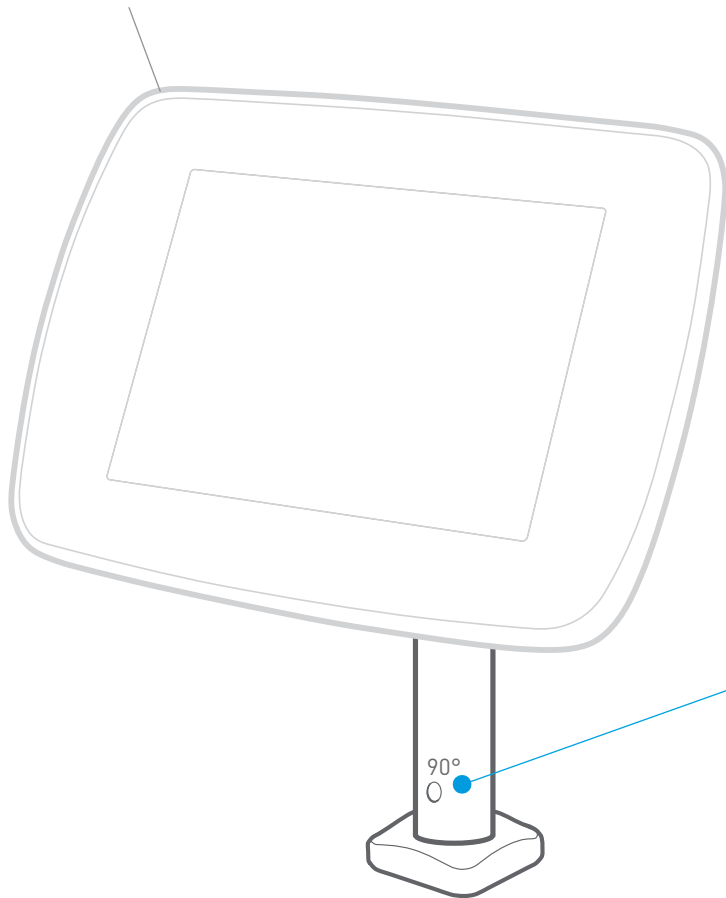

All lilitab head units do not cause radio interference.

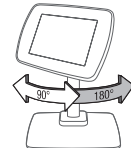

## ROTATE FEATURE

The lilitab Counter can be configured to allow 90°, 180° or no rotation. By default it is set to 180.°

**To disable rotation** (and/ or adjust rotation tension) tighten the screw in the upper rear opening of the vertical tube to the desired level.

**To switch from 180° to 90°** remove the lower screw visible through the lower rear facing opening in the tube using the short black L Key provided and insert it into the threaded opening visible through the lower front opening.

## MULTI-POSITION NECK JOINT

Permits tilt up/down. It has two operator configurable modes:



**Fixed.** The head unit can be set to any fixed angle between completely vertical and +/-22.5°



**Tilt.** Can be configured to allow the user to tilt the head unit.

# ASSEMBLY INSTRUCTIONS

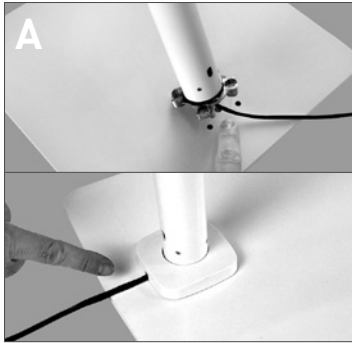

**1. Cable routing.** Choose your method of how you thread your USB cable that came with your tablet:

**A:** Exit out the back of the base cover.

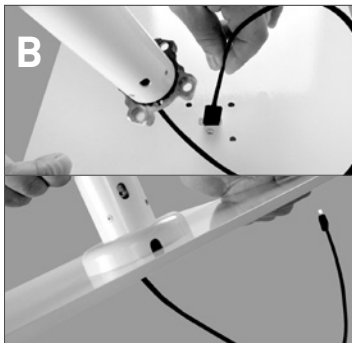

**B:** Exit through the compact base plate (no wire showing). This will require cable routing through your substrate.

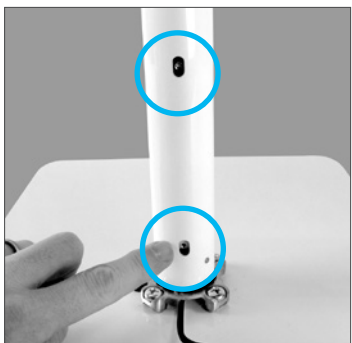

**2. Center your mount arm.** After you thread the USB cable through the bottom, pull the other side through the top and allow some give. Next, be sure the mount arm is positioned so that the center point of its rotation is located appropriately for your installation scenario. You can determine the center point by aligning the openings on the rear of the tube with the two screws visible through the openings, as pictured.

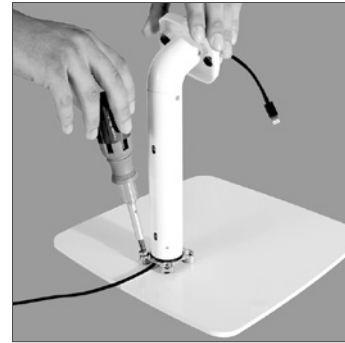

**3. Install mount post.** Line up the bottom of the lilitab mount with the four (4) screw holes in the base plate. Secure together using the **four (4) 1/4-28 x 0.375 Compact Base Screws.**



**NOTE:** You will need to hold the foot cover up and out of your way while securing.

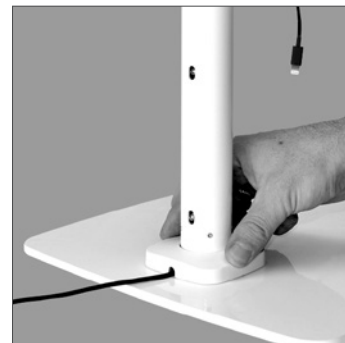

**4. Install the base cover** by sliding the it gently down to pole to cover the screws (velcro will hold it in place once positioned).

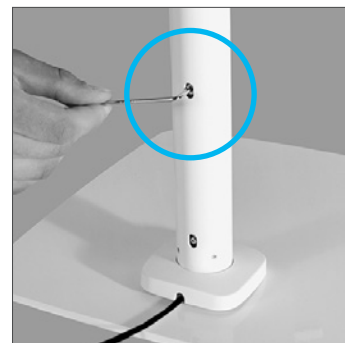

**5. Set rotation tension.** To disable rotation (and/ or adjust rotation tension) tighten the screw in the upper rear opening of the vertical tube to the desired level with the **Silver L Key** provided.



# ASSEMBLY INSTRUCTIONS

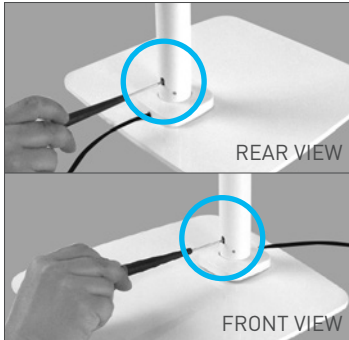

- 6. Set degree of rotation.** The lilitab Counter Pro can be configured to allow 90°, 180° or no rotation. By default it is set to 180°

To switch from 180° to 90° remove the **lower screw visible through the lower rear facing opening in the tube** using the **Black L Key** provided and insert it into the **threaded opening visible through the lower front opening**.



- 9. Tilt feature.** By default the lilitab head unit can be tilted by the user to suit. If you wish to disable tilt, position your head unit at the desired angle and tighten the bottom screw on the neck joint with the **Black L Key** provided.



- 7. Fit screw opening caps.** Once you have adjusted the tension and degree of rotation, insert the three **(3) Screw Opening Caps** to conceal the screw openings.



- 8. Place your head unit onto the MagDOCK mount** in either landscape or portrait orientation. **Turn the key** to lock it in place.

**WARNING:** Not locking the MagDOCK will result in the unit falling off, possibly damaging the unit and/or the tablet. The lilitab Pro is designed to be operated with the lock closed.

Refer to your lilitab Head owner's manual for tablet installation instructions.

## BOLT DOWN INSTALLATION

The lilitab Counter Pro can be mounted to any hard surface, see below.

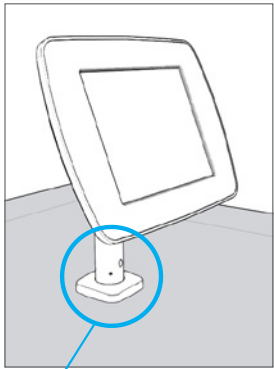

### BOLT DOWN

Use two (2) bolts, wood screws or other fastener suitable for your surface's substrate (m6, no.14 or 1/4" diameter). Use the mounting pattern to the right for proper alignment.

Power supply cable can run under or on top of surface.

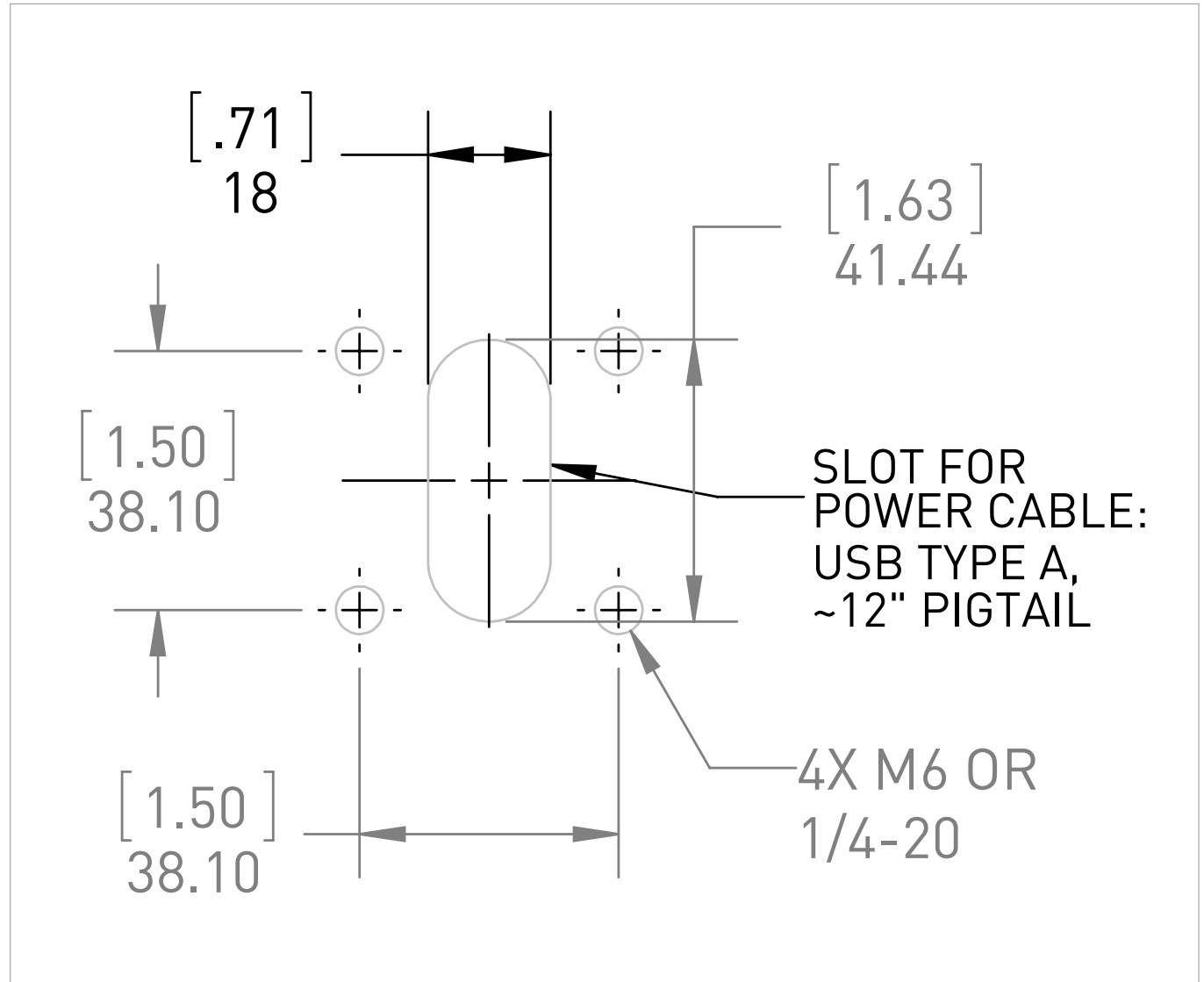

Mounting pattern