



lilitab Counter Basic Mount

Assembly Instructions

v3.0

TABLE OF CONTENTS

Assembly Preparation and Packing List	3
Features	4
Assembly Instructions	5
Bolt Down Installation	7

GOT QUESTIONS? WE'RE HERE TO HELP!

EMAIL support@lilitab.com **PHONE** 888.705.0190

MOUNT ASSEMBLY PREPARATION

FOR BASE PLATE INSTALLATION, YOU'LL NEED:

- ✓ Phillips screwdriver

FOR BOLT DOWN INSTALLATION, YOU'LL NEED:

- ✓ Powered drill/driver, preferably with impact action
- ✓ 4 x bolts or wood screws (m5, no.10, no.11, 3/16" or 13/64 diameter)

PACKING LIST

INCLUDED

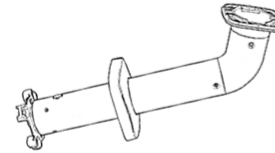

1 x Mount Post



4 x M3x7mm Head Mount Security Screws



2 x M3x10mm Neck Security Cover Screws



1 x Silver L Key



1 x Black L Key



3 x Screw Opening Caps

INCLUDED IF YOU ORDERED COMPACT BASE PLATE



1 x Compact Base Plate



4 x 1/4-28 x 0.375 Compact Base Screws

FEATURES

Head unit shown for illustrative purposes only. Your head unit may vary depending upon your tablet choice. Please refer to your head unit instructions for more details.

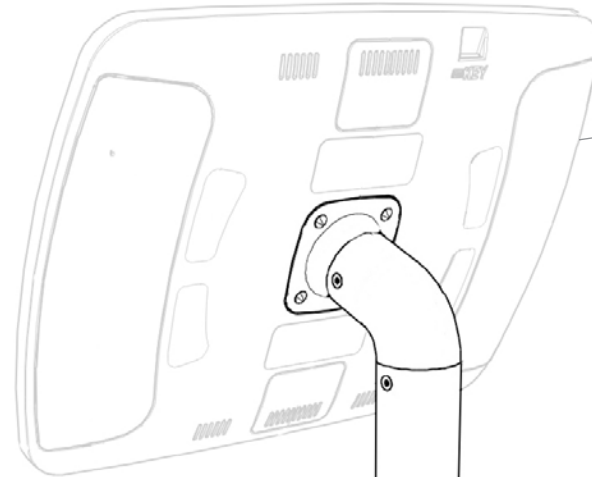
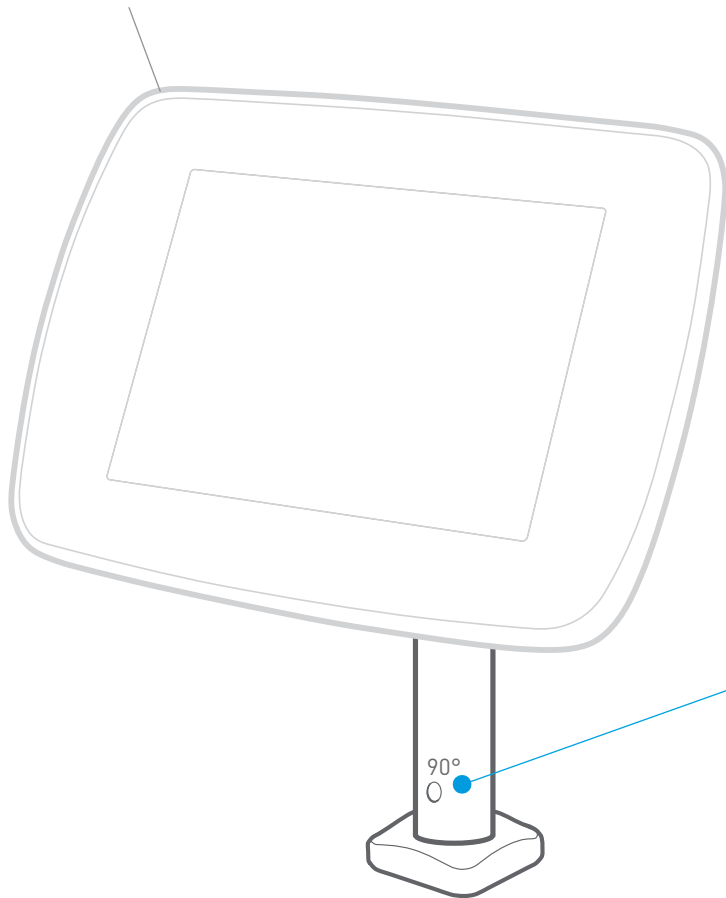

All lilitab head units do not cause radio interference.

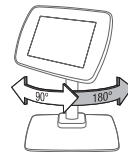

ROTATE FEATURE

The lilitab Counter can be configured to allow 90°, 180° or no rotation. By default it is set to 180.°

To disable rotation (and/ or adjust rotation tension) tighten the screw in the upper rear opening of the vertical tube to the desired level.

To switch from 180° to 90° remove the lower screw visible through the lower rear facing opening in the tube using the short black L Key provided and insert it into the threaded opening visible through the lower front opening.

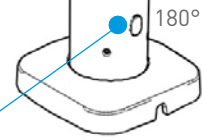

ASSEMBLY INSTRUCTIONS

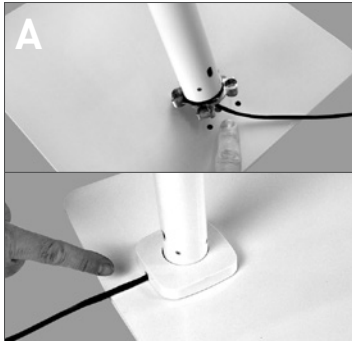

1. Cable routing. Choose your method of how you thread your USB cable that came with your tablet:

A: Exit out the back of the base cover.

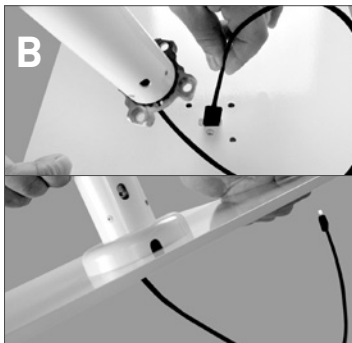

B: Exit through the compact base plate (no wire showing). This will require cable routing through your substrate.

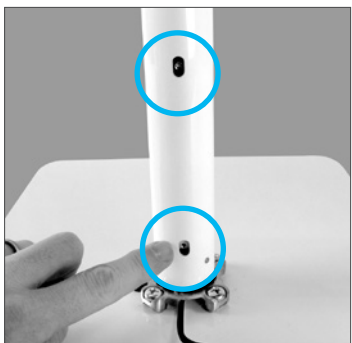

2. Center your mount arm. After you thread the USB cable through the bottom, pull the other side through the top and allow some give. Next, be sure the mount arm is positioned so that the center point of its rotation is located appropriately for your installation scenario. You can determine the center point by aligning the openings on the rear of the tube with the two screws visible through the openings, as pictured.



3. Install mount post. Line up the bottom of the lilitab mount with the four (4) screw holes in the base plate. Secure together using the **four (4) 1/4-28 x 0.375 Compact Base Screws.**



NOTE: You will need to hold the foot cover up and out of your way while securing.

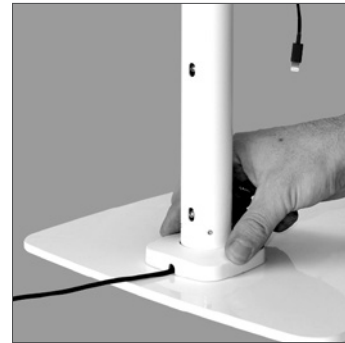

4. Install the base cover by sliding the it gently down to pole to cover the screws (velcro will hold it in place once positioned).

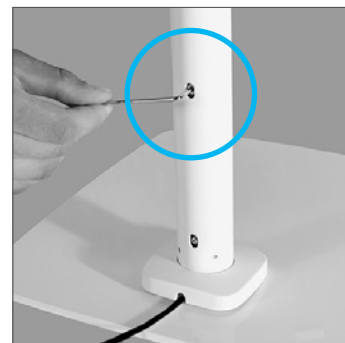

5. Set rotation tension. To disable rotation (and/ or adjust rotation tension) tighten the screw in the upper rear opening of the vertical tube to the desired level with the **Silver L Key** provided.



ASSEMBLY INSTRUCTIONS

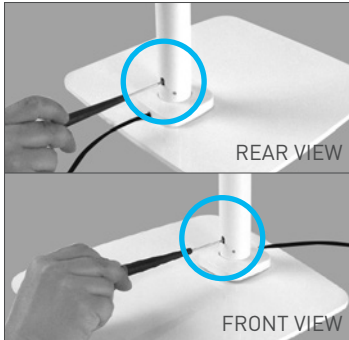

- 6. Set degree of rotation.** The lilitab Counter Basic can be configured to allow 90°, 180° or no rotation. By default it is set to 180°
- To switch from 180° to 90° remove the **lower screw visible through the lower rear facing opening in the tube** using the **Black L Key** provided and insert it into the **threaded opening visible through the lower front opening.**



- 7. Fit screw opening caps.** Once you have adjusted the tension and degree of rotation, insert the **three (3) Screw Opening Caps** to conceal the screw openings.



- 8. Insert the USB cable** through the hole in the back of your head unit (packaged separately).

Refer to your lilitab Head owner's manual for tablet installation instructions.



- 9. You will attach your head unit** using the **four (4) M3x7mm Head Mount Security Screws** and **Silver L Key.**

NOTE: Rotating the neck security cover 90° will make access to the screw openings easier to access.



- 10. Install the neck security cover.** by using the **two (2) M3x10mm Security Cover Screws** and **Silver L Key.**



NOTE: The security cover screws should be oriented such that they are parallel to the long edge of the head unit, as shown in the picture. If they're not, simply rotate the security cover.

BOLT DOWN INSTALLATION

The lilitab Counter Basic can be mounted to any hard surface, see below.

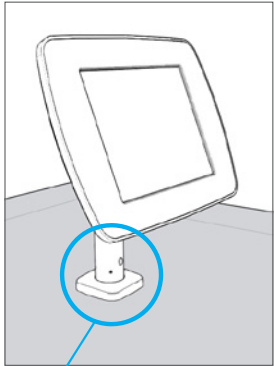

BOLT DOWN

Use two (2) bolts, wood screws or other fastener suitable for your surface's substrate (m6, no.14 or 1/4" diameter). Use the mounting pattern to the right for proper alignment.

Power supply cable can run under or on top of surface.

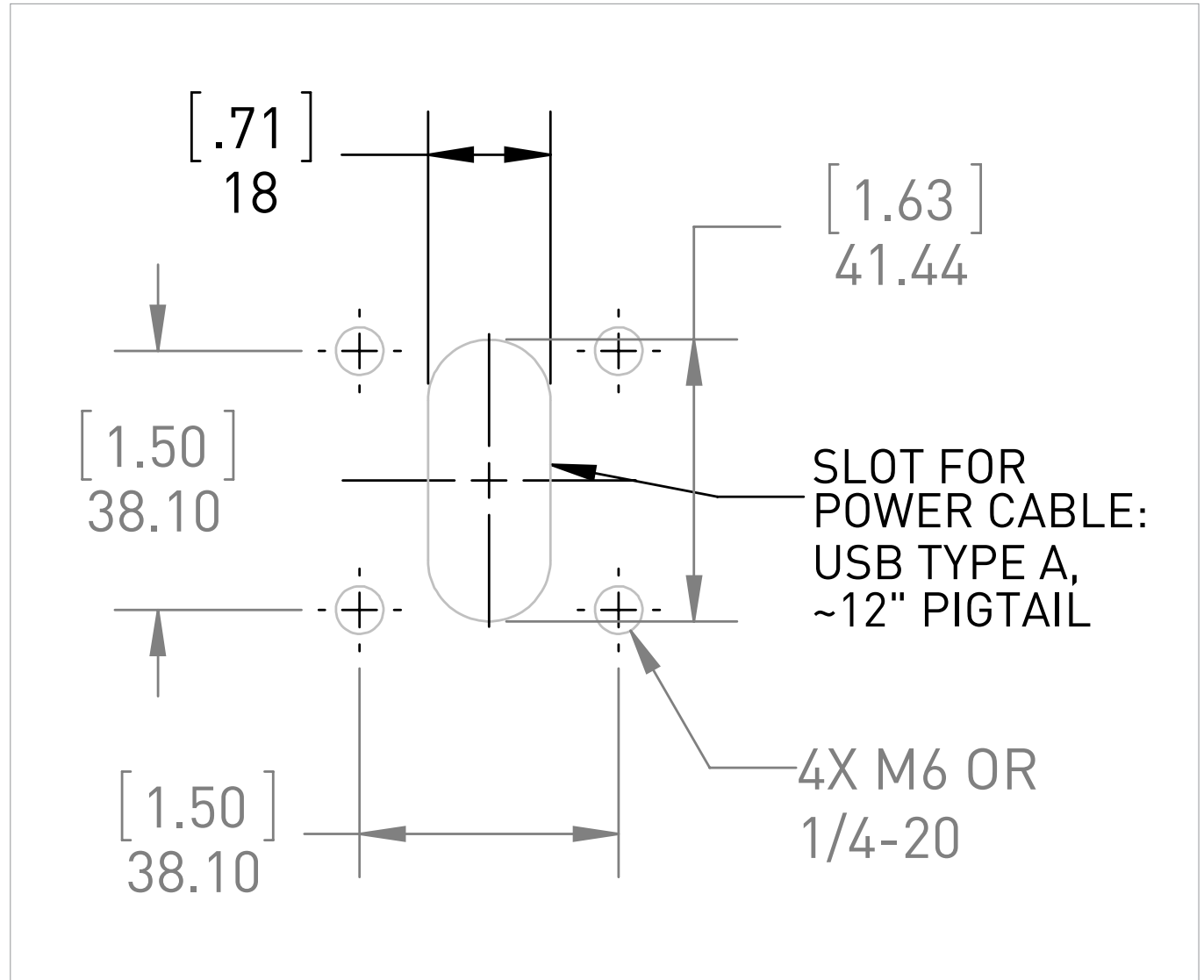

Mounting pattern