



Follow Focus with Hard Stops (HS-1000)

INSTRUCTION MANUAL



All rights reserved.

No part of this document may be reproduced, stored in a retrieval system, or transmitted by any form or by any means, electronic, mechanical, photocopying, recording, or otherwise, except as may be expressly permitted by the applicable copyright statutes or in writing by the Publisher.

INTRODUCTION

Proaim introduces its most durable HS-1000 follow focus allowing you to smoothly and accurately pull focus with cinema and DSLR lenses equipped with gear rings. Integrated into the follow focus are hard stops, letting you set start/end points on DSLR lenses for quick focus racking between two focus points

IN THE BOX

Please inspect the contents of your shipped package to ensure you have received all that is pictured and listed below.



HS-1000 15mm follow focus



Gear Ring Belt



Speed Crank

SET UP

STEP
01

Mount the Gear ring belt over your lens focusing ring. Tighten the gear properly.



**STEP
02**

Mount the HS-1000 follow focus on the rods, align it with the gear ring and tighten the side knobs to secure properly.

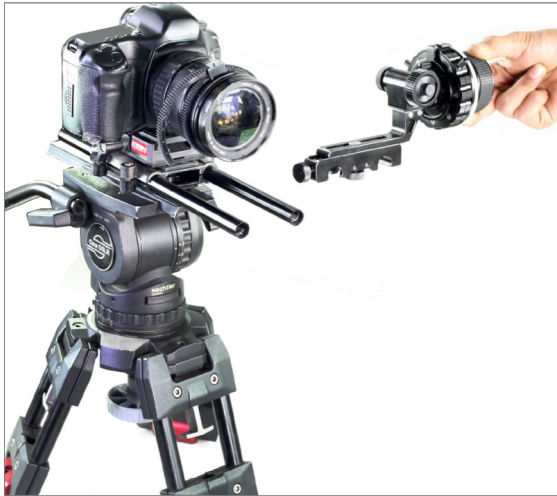

Hard Stop

For quick focus racking

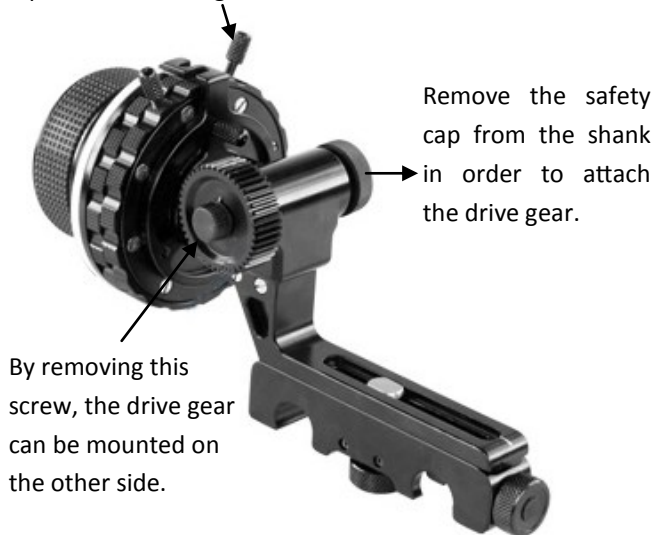

The white marking disc is magnetic and can be easily pulled back and placed onto the rotating knob.

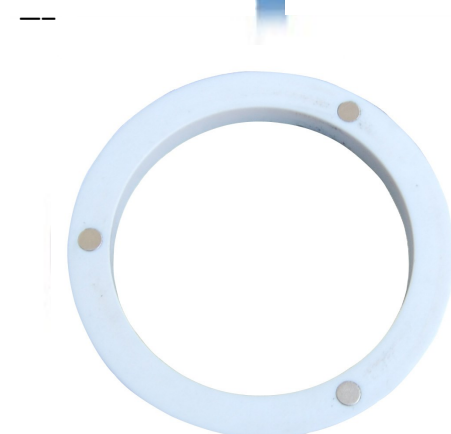

YOUR HS-1000 FOLLOW FOCUS WITH HARD STOPS IS READY TO GO



WARRANTY

We offer a one year warranty for our products from the date of purchase.

We will repair or replace your product, free of charge, in the event of a defect in materials or craftsmanship obtained during normal use or handling based on the user manual. Please note that we will not cover any shipping costs for returning the product to us. If any VAT or import duties are applied to the return, we will also charge these costs to the customer.

The warranty does not include, by the way of example, damage caused by products that we do not supply or from mishandling in transit, accident, misuse, neglect, lack of care of the product, or service by anyone other than our company.

We are not liable for incidental or consequential damages resulting from the use of the unit or occurring due to any breach of this warranty.

Replacement parts of the product will be provided at nominal cost (covering the cost price of the replacement parts only) to the customers after the Warranty Period has expired. We will cover the complete cost of sending replacement parts within the warranty period. After that, Nominal cost of the product & Actual shipping cost will be charged.

Do not send the unit to us without first getting a response and getting the approval to send back the item.

In case of any kind of dissatisfaction, we urge you to **Contact us** immediately and we shall do our Best to help you out. For any other assistance you can reach us via email.

For any other assistance you can reach us via email.