

# PRODUCT DATA SHEET



## PRODUCT - DATA

**SF7801TP/DPS1**  
Drop pin swage stub

### SF7801TP/DPS1

**Technical Data**

Casting material : AISI316 - DIN 1.4408  
Surface treatment : "M.F." (Matte finished)

Note : Standard safety factor for working load is 1/4 of breaking load.

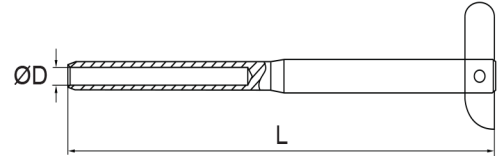

 **SF7801TP/DPS1**  
Drop pin swage stud

SF7801TP/DPS1 SS316	SIZE	ØD (mm)	ØD (inch)	L (mm)	L (inch)	Unit weight (kgs)	Unit weight (lb)
67801TPDK0D00	1/8"	3.6	0.14	95	3.74	0.018	0.04
67801TPDB0D00	3/16"	5.2	0.20	100	3.94	0.024	0.05

CODE: SF7801TP/DPS1

KINZI DATA SHEET

**100%**  
**RECYCLABLE**

[WWW.KINZI.COM](http://WWW.KINZI.COM)