

PRODUCT DATA SHEET



PRODUCT - DATA

SF511
Simplex clip

SF511

Technical Data

Casting material : AISI316 - DIN 1.4408
Production : SF511 - Clip- Forged
Surface treatment : "E.P." (Electro polished)

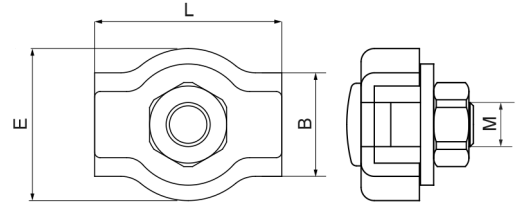

SF511		Metric	SIZE Imperial	B (mm)	B (inch)	E (mm)	E (inch)	L (mm)	L (inch)	M (mm)	Unit weight (kgs)	Unit weight (lb)
SS304	SS316											
4511-0020	6511-0020	2	-	4.0	0.16	8.2	0.32	15.0	0.59	M4	0.01	0.02
4511-0030	6511-0003	3	1/8"	7.0	0.28	11.0	0.43	17.0	0.67	M4	0.01	0.02
4511-0004	6511-0004	4	5/32"	9.2	0.36	13.0	0.51	21.0	0.83	M5	0.01	0.02
4511-0050	6511-0005	5	3/16"	11.0	0.43	15.0	0.59	25.0	0.98	M5	0.01	0.02
4511-0006	6511-0006	6	1/4"	13.0	0.51	18.5	0.73	30.0	1.18	M6	0.03	0.07
4511-0008	6511-0008	8	5/16"	17.5	0.69	25.0	0.98	36.5	1.44	M8	0.05	0.11

CODE: SF511

KINZI DATA SHEET

100%
RECYCLABLE

WWW.KINZI.COM