

# PRODUCT DATA SHEET



## PRODUCT - DATA

**SF414**  
Heavy thimbles

### SF414

**Technical Data**

Forging material : AISI316 - DIN 1.4401  
Production : SF414 - Thimble - Forged  
Surface treatment : "E.P." (Electro polished)

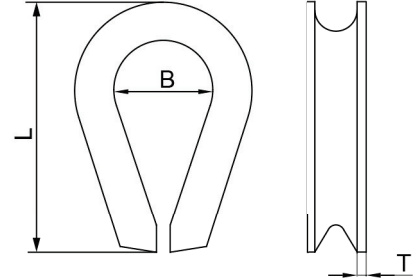

 **SF414**  
Heavy thimbles

SF414		SIZE	B (mm)	B (inch)	L (mm)	L (inch)	T (mm)	T (inch)	DiaØCable (inch)	Unit weight (kgs)	Unit weight (lb)
SS304	SS316										
4404-0316	6404-0316	3/16"	18.0	0.71	43.0	1.69	1.0	0.04	3/16"	0.01	0.02
4414-0401	6414-0401	1/4"	23.3	0.92	56.0	2.20	1.5	0.06	1/4"	0.03	0.07
4414-0615	6414-0615	5/16"	27.3	1.07	63.0	2.48	2.0	0.08	5/16"	0.05	0.11
4414-0803	6414-0803	3/8"	29.0	1.14	73.0	2.87	2.5	0.10	3/8"	0.08	0.18
4414-0201	6414-0201	1/2"	38.0	1.50	92.0	3.62	4.0	0.16	1/2"	0.21	0.46
4414-0805	6414-0805	5/8"	45.0	1.77	106.0	4.17	4.0	0.16	5/8"	0.29	0.64
4414-0403	6414-0403	3/4"	50.8	2.00	125.0	4.92	5.0	0.20	3/4"	0.55	1.21
4414-0708	6414-0708	7/8"	57.0	2.24	139.8	5.50	6.0	0.24	7/8"	0.36	1.89
4414-0001	6414-0001	1"	65.5	2.58	157.5	6.20	6.0	0.24	1"	1.11	2.44

CODE: SF414

KINZI DATA SHEET

**100%**  
**RECYCLABLE**

[WWW.KINZI.COM](http://WWW.KINZI.COM)