

# PRODUCT DATA SHEET



## PRODUCT - DATA

**SF3212**  
Oblong pad

### SF3212

#### Technical Data

Forging material : AISI304 - DIN 1.4301  
 : AISI316 - DIN 1.4401  
 Production : SF3212 - Pad - Welded  
 Surface treatment : "E.P." (Electro polished)

Note : Standard safety factor for working load  
 is 1/4 of breaking load



**M** SF3212  
Metric Oblong pad

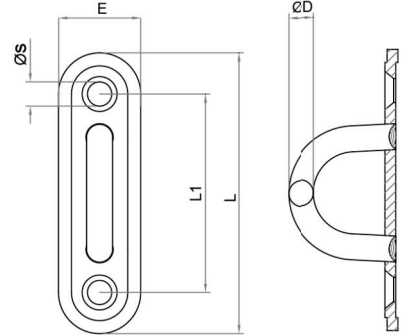

SF3212		SIZE	E (mm)	E (inch)	ØD (mm)	ØD (mm)	L (mm)	L (inch)	L1 (mm)	L1 (inch)	ØS (mm)	ØS (inch)	Unit weight (kgs)	Unit weight (lb)	B.L. (Kgs)	B.L. (lb)
SS304	SS316															
4321-2005	6321-2005	5	16	0.63	5	0.20	54	2.13	38	1.50	5.0	0.20	0.02	0.04	700	1,540
4321-2006	6321-2006	6	19	0.75	6	0.24	65	2.56	46	1.81	5.6	0.22	0.03	0.07	1,000	2,200
4321-2008	6321-2008	8	25	0.98	8	0.31	81	3.19	56	2.20	6.5	0.26	0.07	0.15	1,600	3,520
4321-2009	6321-2009	10	32	1.26	10	0.39	100	3.94	73	2.87	6.5	0.26	0.11	0.24	1,700	3,740

CODE: SF3212

KINZI DATA SHEET

**100%**  
**RECYCLABLE**

**WWW.KINZI.COM**