

# PRODUCT DATA SHEET



## PRODUCT - DATA

**SF321**  
Square pad

### SF321

#### Technical Data

Forging material : AISI304 - DIN 1.4301  
 : AISI316 - DIN 1.4401  
 Production : SF321 - Pad - Welded  
 Surface treatment : "E.P." (Electro polished)

Note : Standard safety factor for working load  
 is 1/4 of breaking load



**M** SF321  
Metric Square pad

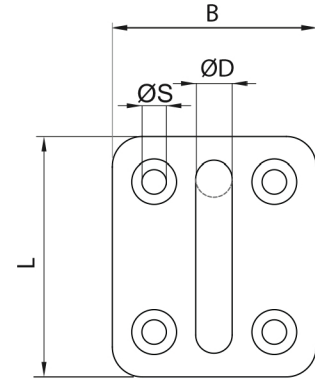

| SF321     |           | SIZE | B<br>(mm) | B<br>(inch) | ØD<br>(mm) | ØD<br>(inch) | L<br>(mm) | L<br>(inch) | ØS<br>(mm) | ØS<br>(inch) | Unit<br>weight<br>(kgs) | Unit<br>weight<br>(lb) | B.L.<br>(kgs) | B.L.<br>(lb) |
|-----------|-----------|------|-----------|-------------|------------|--------------|-----------|-------------|------------|--------------|-------------------------|------------------------|---------------|--------------|
| SS304     | SS316     |      |           |             |            |              |           |             |            |              |                         |                        |               |              |
| 4321-0005 | 6321-0005 | 5    | 30        | 1.18        | 5          | 0.20         | 34        | 1.34        | 4.1        | 0.16         | 0.03                    | 0.07                   | 700           | 1,540        |
| 4321-0006 | 6321-0006 | 6    | 34        | 1.34        | 6          | 0.24         | 40        | 1.57        | 4.1        | 0.16         | 0.05                    | 0.11                   | 1,000         | 2,200        |
| 4321-0008 | 6321-0008 | 8    | 39        | 1.54        | 8          | 0.31         | 50        | 1.97        | 5.3        | 0.21         | 0.08                    | 0.18                   | 1,600         | 3,520        |
| 4321-0010 | 6321-0010 | 10   | 46        | 1.81        | 10         | 0.39         | 60        | 2.36        | 6.3        | 0.25         | 0.11                    | 0.24                   | 2,500         | 5,500        |

CODE: SF321

KINZI DATA SHEET

**100%**  
**RECYCLABLE**

[WWW.KINZI.COM](http://WWW.KINZI.COM)