

PRODUCT DATA SHEET



PRODUCT - DATA

SF2450X

Snaps hook (with eye)

SF2450X

Technical Data

Forging material : AISI316- DIN 1.4408

Production : SF2450X

Surface treatment : "E.P." (Electro polished)

Surface treatment : "E.P." (Electro polished)

Note : Standard safety factor for working load is 1/4 of breaking load

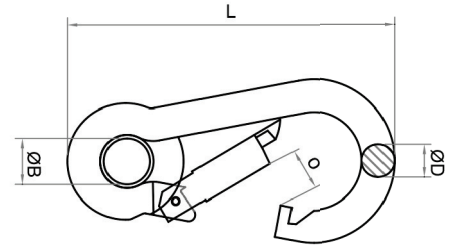

M SF2450X
Metric Snaps hook (with eye)

| SF2450X SS316 | SIZE | ØB (mm) | ØB (inch) | ØD (mm) | ØD (inch) | L (mm) | L (inch) | O (mm) | O (inch) | Unit weight (kgs) | Unit weight (lb) | B.L. (kgs) | B.L. (lb) |
|------------------|------|------------|--------------|------------|--------------|-----------|-------------|-----------|-------------|-------------------------|------------------------|---------------|--------------|
| 2245-0205 | 5 | 7 | 0.28 | 5 | 0.20 | 50 | 1.96 | 7 | 0.27 | 0.02 | 0.04 | 160 | 352 |
| 2245-0206 | 6 | 9 | 0.35 | 6 | 0.24 | 60 | 2.36 | 8 | 0.31 | 0.03 | 0.07 | 300 | 660 |
| 2245-0208 | 8 | 12 | 0.47 | 8 | 0.31 | 80 | 3.14 | 10 | 0.39 | 0.07 | 0.15 | 600 | 1,320 |
| 2245-0210 | 10 | 16 | 0.63 | 10 | 0.39 | 100 | 3.93 | 13 | 0.51 | 0.14 | 0.31 | 800 | 1,760 |

CODE: SF2450X

KINZI DATA SHEET

100%
RECYCLABLE

WWW.KINZI.COM