

# PRODUCT DATA SHEET



## PRODUCT - DATA

**SAH/APL**  
Angled hinge

### SAH/APL

**Technical Data**

Casting material : AISI316 - DIN 1.4408  
Surface treatment : "M.F." (Matte finished)



**Metric** SAH/APL  
Angled hinge

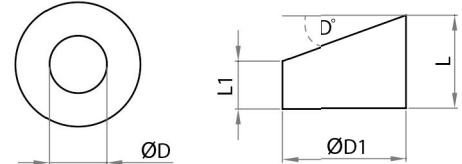

SAH/APL SS316	SIZE ANGLE (D°)	ØD (mm)	ØD (inch)	ØD1 (mm)	ØD1 (inch)	L (mm)	L (inch)	L1 (mm)	L1 (inch)	Unit weight (kgs)	Unit weight (lb)
6182-0115	20	5.0	0.20	11	0.43	9.0	0.35	5	0.2	0.01	0.02
6182-0136	20	6.0	0.24	13	0.51	9.7	0.38	5	0.2	0.01	0.02
6182-0178	20	8.2	0.32	17	0.67	11.2	0.44	5	0.2	0.01	0.02
6182-5115	25	5.0	0.20	11	0.43	10.0	0.39	5	0.2	0.01	0.02
6182-5136	25	6.0	0.24	13	0.51	11.0	0.43	5	0.2	0.01	0.02
6182-5178	25	8.2	0.32	17	0.67	12.9	0.51	5	0.2	0.01	0.02
6183-0115	30	5.0	0.20	11	0.43	11.3	0.44	5	0.2	0.01	0.02
6183-0136	30	6.0	0.24	13	0.51	12.5	0.49	5	0.2	0.01	0.02
6183-0178	30	8.2	0.32	17	0.67	14.8	0.58	5	0.2	0.01	0.02
6183-5115	35	5.0	0.20	11	0.43	12.7	0.50	5	0.2	0.01	0.02
6183-5136	35	6.0	0.24	13	0.51	14.0	0.55	5	0.2	0.01	0.02
6183-5178	35	8.2	0.32	17	0.67	16.9	0.67	5	0.2	0.01	0.02
6184-0115	40	5.0	0.20	11	0.43	14.2	0.56	5	0.2	0.01	0.02
6184-0136	40	6.0	0.24	13	0.51	15.9	0.63	5	0.2	0.01	0.02
6184-0178	40	8.2	0.32	17	0.67	19.3	0.76	5	0.2	0.02	0.04

CODE: SAH/APL

KINZI DATA SHEET

**100%**  
**RECYCLABLE**

**WWW.KINZI.COM**