

PRODUCT DATA SHEET



PRODUCT - DATA

S9228/HP

Stainless steel hinge (type U)

S9228/HP

Technical Data

Casting material : AISI316 - DIN 1.4408
Surface treatment : "M.P." (Mirror polished)

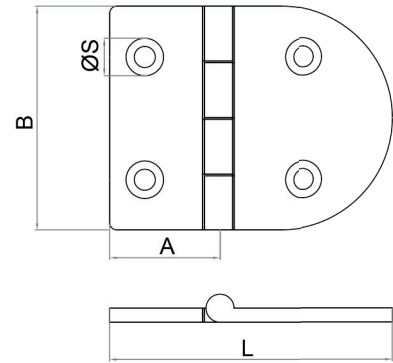

M Metric S9228/HP
Stainless steel hinge (type U)

| S9228/HP SS316 | SIZE | A (mm) | A (inch) | B (mm) | B (inch) | L (mm) | L (inch) | ØS (mm) | ØS (inch) | Unit weight (kgs) | Unit weight (lb) |
|-------------------|------|-----------|-------------|-----------|-------------|-----------|-------------|------------|--------------|-------------------------|------------------------|
| 6922-8644 | 4 | 31.5 | 1.24 | 64 | 2.52 | 81 | 3.19 | 6.3 | 0.25 | 0.15 | 0.33 |

CODE: S9228/HP

KINZI DATA SHEET

100%
RECYCLABLE

WWW.KINZI.COM