

# PRODUCT DATA SHEET



## PRODUCT - DATA

**S9211**  
Cover latch

### S9211

#### Technical Data

Casting material : AISI316 - DIN 1.4408  
Production : S9211 - Body - Cast  
Surface treatment : "M.P." (Mirror polished)



 **S9211**  
Cover latch

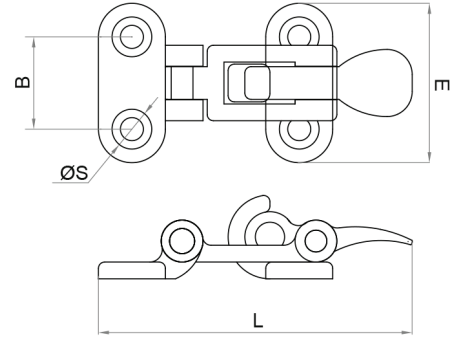

<b>S9211</b>	<b>SIZE</b>	<b>B</b>	<b>B</b>	<b>E</b>	<b>E</b>	<b>L</b>	<b>L</b>	<b>ØS</b>	<b>ØS</b>	<b>Unit weight</b>	<b>Unit weight</b>
SS316		(mm)	(inch)	(mm)	(inch)	(mm)	(inch)	(mm)	(inch)	(kgs)	(lb)
<b>6921-1303</b>	<b>3"</b>	22	0.87	38	1.5	76	2.99	5	0.2	0.07	0.15

CODE: S9211

KINZI DATA SHEET

**100%**  
**RECYCLABLE**

[WWW.KINZI.COM](http://WWW.KINZI.COM)