

# PRODUCT DATA SHEET



## PRODUCT - DATA

SF7805D/DS2

Hand swage wall mount toggle

### S7805D/DS2

#### Technical Data

Forging material : AISI316 - DIN 1.4401  
 Production : S7805D/DS2  
 Terminal/Toggle - Forged  
 Surface treatment : "E.P." (Electro polished)

Note : Standard safety factor for working load is 1/4 of breaking load.

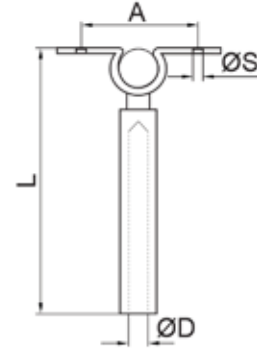

**S7805D/DS2**  
Hand swage wall mount toggle

S7805D/DS2		SIZE	A (mm)	A (inch)	ØD (mm)	ØD (inch)	L (mm)	L (inch)	ØS (mm)	ØS (inch)	Unit weight (kgs)	Unit weight (lb)
SS316												
67805DDS10800		1/8"	32.51	1.28	1/8"	1/8"	75.44	2.97	6.60	0.26	0.03	0.07
67805DDS31600		3/16"	32.51	1.28	3/16"	3/16"	72.39	2.85	6.60	0.26	0.03	0.08

CODE: S7805/DS2

KINZI DATA SHEET

**100%**  
**RECYCLABLE**

WWW.KINZI.COM