

PRODUCT DATA SHEET



PRODUCT - DATA

S582
Eye nut

S582

Technical Data

Casting material : AISI316 - DIN 1.4408
Production : DIN582 - Nut - Cast
Surface treatment : "E.P." (Electro polished)

Note : Standard safety factor for working load
is 1/4 of breaking load

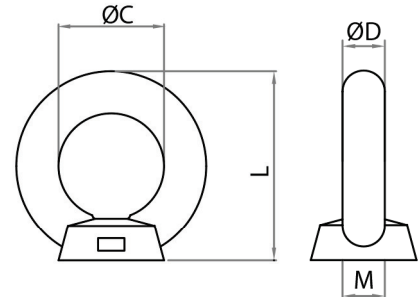

S582 SS316	SIZE	ØC (mm)	ØC (inch)	ØD (mm)	ØD (inch)	L (mm)	L (inch)	M (mm/inch)	Unit weight (kgs)	Unit weight (lb)	B.L. (kgs)	B.L. (lb)
6582-0006	6	15	0.59	6	0.24	27	1.06	M6	0.02	0.04	1,300	2,860
6582-0008	8	20	0.79	8	0.31	36	1.42	M8	0.04	0.09	2,200	4,840
6582-0010	10	25	0.98	10	0.39	45	1.77	M10	0.08	0.18	2,600	5,720
6582-0012	12	30	1.18	12	0.47	53	2.09	M12	0.13	0.29	4,900	10,780
6582-0016	16	35	1.38	14	0.55	63	2.48	M16	0.21	0.46	7,000	15,400
6582-0020	20	40	1.57	16	0.63	72	2.83	M20	0.31	0.68	10,000	22,000
6582-0024	24	50	1.97	20	0.79	90	3.54	M24	0.60	1.32	18,000	39,600
6582-0030	30	60	2.36	24	0.94	108	4.25	M30	1.03	2.27	22,000	48,400
6582-0036	36	70	2.76	28	1.10	126	4.96	M36	1.79	3.94	34,000	74,800
6582-0104	1/4"	15	0.59	6	0.24	27	1.06	1/4"	0.02	0.04	1,300	2,860
6582-0516	5/16"	20	0.79	8	0.31	36	1.42	5/16"	0.04	0.09	2,200	4,840
6582-0308	3/8"	25	0.98	10	0.39	45	1.77	3/8"	0.08	0.18	2,600	5,720
6582-0102	1/2"	30	1.18	12	0.47	53	2.09	1/2"	0.13	0.29	4,900	10,780
6582-0508	5/8"	35	1.38	14	0.55	63	2.48	5/8"	0.20	0.44	7,000	15,400
6582-0304	3/4"	40	1.57	16	0.63	72	2.83	3/4"	0.30	0.66	10,000	22,000
6582-0001	1"	50	1.97	20	0.79	90	3.54	1"	0.60	1.32	18,000	39,600

CODE: S582

KINZI DATA SHEET

100%
RECYCLABLE

WWW.KINZI.COM