

# PRODUCT DATA SHEET



## S380LK

### Technical Data

Casting material : AISI316 - DIN 1.4408  
Forging material : AISI316 - DIN 1.4401  
Production : S380LK  
Shackle - Cast  
Pin - Forged  
Surface treatment : "E.P." (Electro polished)

Note : Standard safety factor for working load  
is 1/4 of breaking load



**S380LK**  
Twist shackle with locking pin)

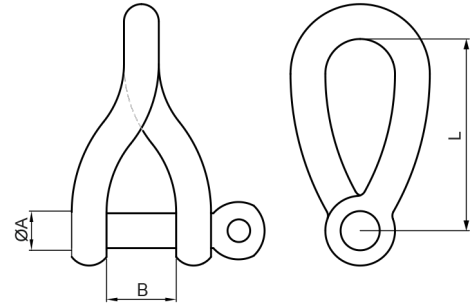

S380LK SS316	SIZE	ØA (mm)	ØA (inch)	B (mm)	B (inch)	L (mm)	L (inch)	Unit weight (kgs)	Unit weight (lb)	B.L. (kgs)	B.L. (lb)
6380-5006	6	6	0.24	12	0.47	36	1.42	0.03	0.07	1,600	3,520
6380-5008	8	8	0.31	16	0.63	44	1.73	0.07	0.15	2,800	6,160

CODE: S380LK

KINZI DATA SHEET

**100%**  
**RECYCLABLE**

**WWW.KINZI.COM**