

PRODUCT DATA SHEET



PRODUCT - DATA

S370CP, SF370CP

Anchor shackle (collared pin)

S370CP, SF370CP

Technical Data

Casting material : AISI316 - DIN 1.4408
 Forging material : AISI316 - DIN 1.4401
 Production : S370CP
 Shackle - Cast
 Pin - See chart
 SF370CP
 Shackle/Pin - Forged
 Surface treatment : "E.P." (Electro polished)

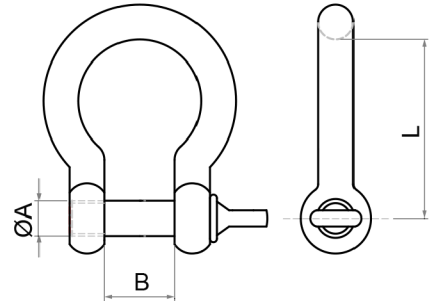

Note : Standard safety factor for working load is 1/4 of breaking load

Metric S370CP, SF370CP
Anchor shackle (collared pin)

S370CP SS316	SIZE	ØA (mm)	ØA (inch)	B (mm)	B (inch)	L (mm)	L (inch)	PIN	Unit weight (kgs)	Unit weight (lb)	B.L. (kgs)	B.L. (lb)
6370-3003	3	3	0.12	8	0.31	16.5	0.65	Forged	0.01	0.02	400	880
6370-3004	4	4	0.16	8	0.31	20.0	0.79	Forged	0.01	0.02	550	1,210
6370-3005	5	5	0.20	10	0.39	25.5	1.00	Forged	0.02	0.04	1,200	2,640
6370-3006	6	6	0.24	12	0.47	30.0	1.18	Forged	0.03	0.07	1,700	3,740
6370-3008	8	8	0.31	16	0.63	41.0	1.61	Forged	0.07	0.15	2,500	5,500
6370-3010	10	10	0.39	20	0.79	51.0	2.01	Forged	0.13	0.29	4,500	9,900
6370-3012	12	12	0.47	24	0.94	61.0	2.40	Forged	0.23	0.51	6,000	13,200
6370-3013	13	13	0.51	26	1.02	66.5	2.62	Forged	0.29	0.64	6,500	14,300
6370-3014	14	14	0.55	28	1.10	70.0	2.76	Cast	0.36	0.79	7,000	15,400
6370-3016	16	16	0.63	32	1.26	82.0	3.23	Forged	0.54	1.19	10,000	22,000
6370-3019	19	19	0.75	38	1.50	97.0	3.82	Forged	0.92	2.02	15,000	33,000
6370-3022	22	22	0.87	44	1.73	110.0	4.33	Cast	1.36	2.99	19,000	41,800
6370-3025	25	25	0.98	50	1.97	125.0	4.92	Forged	2.02	4.44	23,000	50,600
6370-3028	28	28	1.10	56	2.20	140.0	5.51	Cast	2.77	6.09	26,000	57,200
6370-3032	32	32	1.26	64	2.52	160.0	6.30	Cast	4.19	9.22	38,000	83,600

SF370CP SS316	SIZE	ØA (mm)	ØA (inch)	B (mm)	B (inch)	L (mm)	L (inch)	Unit weight (kgs)	Unit weight (lb)	B.L. (kgs)	B.L. (lb)
F 2370-0404	4	4	0.16	8	0.31	17.00	0.67	0.01	0.02	900	1,980
F 2370-0405	5	5	0.20	10	0.39	21.25	0.84	0.02	0.04	1,600	3,520
F 2370-0406	6	6	0.24	12	0.47	25.50	1.00	0.03	0.07	2,000	4,400
F 2370-0408	8	8	0.31	16	0.63	34.00	1.34	0.06	0.13	3,500	7,700
F 2370-0410	10	10	0.39	20	0.79	42.50	1.67	0.12	0.26	5,500	12,100
F 2370-0412	12	12	0.47	24	0.94	51.00	2.01	0.22	0.48	7,500	16,500
F 2370-0413	13	13	0.51	26	1.02	55.75	2.19	0.29	0.64	9,000	19,800
F 2370-0416	16	16	0.63	32	1.26	68.00	2.68	0.50	1.10	14,000	30,800

CODE: S370CP, SF370CP

KINZI DATA SHEET

100%
RECYCLABLE

WWW.KINZI.COM