

PRODUCT DATA SHEET



PRODUCT - DATA

S360CP, SF360CP
D-shackle (collared pin)

S360CP, SF360CP

Technical Data

Casting material : AISI304 - DIN 1.4308/
AISI316 - DIN 1.4408
Forging material : AISI304 - DIN 1.4301/
AISI316 - DIN 1.4401
Production : S360CP
Shackle - Cast
Pin - See chart
SF360CP
Shackle - Forged
Pin - Forged
Surface treatment : "E.P." (Electro polished)



M Metric **S360CP, SF360CP**
D-shackle (collared pin)

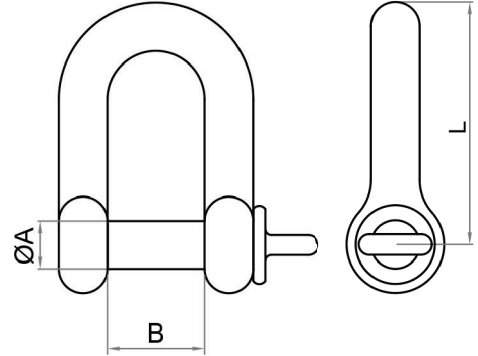

Note : Standard safety factor for working load
is 1/4 of breaking load

S360CP		SIZE	ØA (mm)	ØA (inch)	B (mm)	B (inch)	L (mm)	L (inch)	Pin	Unit weight (kgs)	Unit weight (lb)	B.L. (kgs)	B.L. (lb)
SS304	SS316												
--	6360-0423	3	3	0.12	8	0.31	12	0.47	Forged	0.01	0.02	400	880
4360-0424	6360-0424	4	4	0.16	8	0.31	16	0.63	Forged	0.01	0.02	550	1,210
4360-4405	6360-4405	5	5	0.20	10	0.39	20	0.79	Forged	0.01	0.02	1,000	2,200
4360-2006	6360-2006	6	6	0.24	12	0.47	24	0.94	Forged	0.02	0.04	1,700	3,740
4360-2007	6360-2007	7	7	0.28	14	0.55	28	1.10	Forged	0.04	0.09	2,000	4,400
4360-5208	6360-5208	8	8	0.31	16	0.63	32	1.26	Forged	0.06	0.13	2,800	6,160
4360-5209	6360-5209	9	9	0.35	18	0.71	36	1.42	Forged	0.08	0.18	3,500	7,700
4360-0410	6360-0410	10	10	0.39	20	0.79	40	1.57	Forged	0.11	0.24	4,500	9,900
4360-0412	6360-0412	12	12	0.47	24	0.94	48	1.89	Forged	0.20	0.44	6,000	13,200
4360-0413	6360-0413	13	13	0.51	26	1.02	52	2.05	Forged	0.25	0.55	6,500	14,300
4360-0414	6360-0414	14	14	0.55	28	1.10	56	2.20	Cast	0.30	0.66	7,000	15,400
4360-0416	6360-0416	16	16	0.63	32	1.26	64	2.52	Forged	0.47	1.03	10,000	22,000
4360-0419	6360-0419	19	19	0.75	38	1.50	76	2.99	Forged	0.76	1.67	15,000	33,000
4360-0422	6360-0422	22	22	0.87	44	1.73	88	3.46	Cast	1.13	2.49	19,000	41,800
4360-0425	6360-0425	25	25	0.98	50	1.97	100	3.94	Forged	1.71	3.76	23,000	50,600
4360-0428	6360-0428	28	28	1.10	56	2.20	112	4.41	Cast	2.27	4.99	26,000	57,200
4360-0432	6360-0432	32	32	1.26	64	2.52	128	5.04	Cast	3.50	7.70	38,000	83,600

SF360CP		SIZE	ØA (mm)	ØA (inch)	B (mm)	B (inch)	L (mm)	L (inch)	Unit weight (kgs)	Unit weight (lb)	B.L. (kgs)	B.L. (lb)
SS316												
2360-0404		4	4	0.16	8	0.31	16	0.63	0.01	0.02	900	1,980
2360-0405		5	5	0.20	10	0.39	20	0.79	0.01	0.02	1,600	3,520
2360-0406		6	6	0.24	12	0.47	24	0.94	0.02	0.04	2,000	4,400
2360-0408		8	8	0.31	16	0.63	32	1.26	0.06	0.13	3,500	7,700
2360-0410		10	10	0.39	20	0.79	40	1.57	0.13	0.29	5,500	12,100
2360-0412		12	12	0.47	24	0.94	48	1.89	0.20	0.44	7,500	16,500
2360-0416		16	16	0.63	32	1.26	64	2.52	0.48	1.06	14,000	30,800

100%
RECYCLABLE

WWW.KINZI.COM

CODE: S360CP, SF360CP

KINZI DATA SHEET