

PRODUCT DATA SHEET



PRODUCT - DATA

S360
D-shackle

S360

Technical Data

Casting material : AISI304 - DIN 1.4308/
AISI316 - DIN 1.4408
Forging material : AISI304 - DIN 1.4301/
AISI316 - DIN 1.4401
Production : S360
Shackle - Cast
Pin - Forged
Surface treatment : "E.P." (Electro polished)

Note : Standard safety factor for working load
is 1/4 of breaking load



M Metric **S360**
D-shackle

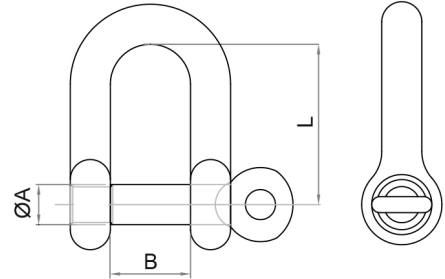

S360		SIZE	ØA (mm)	ØA (inch)	B (mm)	B (inch)	L (mm)	L (inch)	Unit weight (kgs)	Unit weight (lb)	B.L. (kgs)	B.L. (lb)
SS304	SS316											
4360-0004	6360-0004	4	4	0.16	8	0.31	16	0.63	0.01	0.02	550	1,210
4360-0005	6360-0005	5	5	0.20	10	0.39	20	0.79	0.01	0.02	1,000	2,200
4360-0006	6360-0006	6	6	0.24	12	0.47	24	0.94	0.02	0.04	1,700	3,740
4360-0007	6360-0007	7	7	0.28	14	0.55	28	1.10	0.04	0.09	2,000	4,400
4360-0008	6360-0008	8	8	0.31	16	0.63	32	1.26	0.06	0.13	2,800	6,160
4360-0009	6360-0009	9	9	0.35	18	0.71	36	1.42	0.08	0.18	3,500	7,700
4360-0010	6360-0010	10	10	0.39	20	0.79	40	1.57	0.11	0.24	4,500	9,900

CODE: S360

KINZI DATA SHEET

100%
RECYCLABLE

WWW.KINZI.COM