

PRODUCT DATA SHEET



PRODUCT - DATA

S323H
Grab hook (eye end)

S323H

Technical Data

Casting material : AISI316 - DIN 1.4408
Production : S323H - Hook - Cast
Surface treatment : "E.P." (Electro polished)

Note : Standard safety factor for working load is 1/4 of breaking load



 **S323H**
Grab hook (eye end)

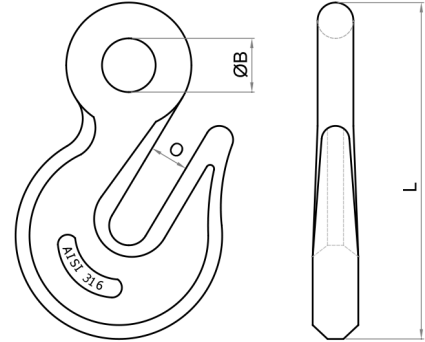

S323H SS316	SIZE	ØB (mm)	ØB (inch)	L (mm)	L (inch)	O (mm)	O (inch)	Unit weight (kgs)	Unit weight (lb)	B.L. (kgs)	B.L. (lb)
6323-2104	1/4"	13.0	0.51	77.6	3.06	8.7	0.34	0.12	0.26	2,900	6,380
6323-2516	5/16"	14.5	0.57	90.0	3.54	11.1	0.44	0.22	0.48	3,700	8,140
6323-2308	3/8"	17.0	0.67	103.6	4.08	12.7	0.50	0.34	0.75	5,800	12,760
6323-2102	1/2"	22.5	0.89	136.2	5.36	16.6	0.65	0.75	1.65	7,000	15,400
6323-2508	5/8"	27.0	1.06	169.1	6.66	19.8	0.78	1.46	3.21	13,000	28,600

CODE: S323H

KINZI DATA SHEET

100%
RECYCLABLE

WWW.KINZI.COM