

# PRODUCT DATA SHEET



## PRODUCT - DATA

S3121\_B3

Turnbuckle with fork & swage stud B3

### S3121\_B3

#### Technical Data

Threaded Fork : Casting material  
 : AISI316, EN 1.4408  
 Swage Terminal : Forging material  
 : AISI316, EN 1.4401  
 Nut : Casting material  
 : AISI316, EN 1.4408  
 Surface treatment : "M.F." (Matte finished)  
 MBL : Minimum Breaking Load  
 before cable assembly.  
 Limit Tension : Recommended maximum  
 load for a tension member.  
 All other applications should  
 consider 1/4 of MBL\*.  
 TAP : 19.1

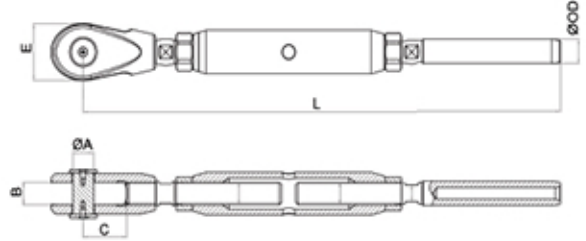

S3121\_B3

Turnbuckle with fork & swage stud B3

S3121_B3 SS316	SIZE M (mm)	Ø Cable (mm)	ØA (mm)	ØA (inch)	B (mm)	B (inch)	C (mm)	C (inch)	E (mm)	E (inch)	L (mm)	L (inch)	ØOD (mm)	ØOD (inch)	Unit weight (kgs)	Unit weight (lb)	Limit Tension (kN)	MBL (kN)
6312-1350	M20	10	20	0.79	20	0.79	42	1.65	50	1.97	462	18.19	21.4	0.84	2.47	5.43	64	126
6312-1337	M22	12	22	0.87	22	0.87	48	1.89	52	2.05	531	20.91	21.4	0.84	3.28	7.22	79	155
6312-1338	M24	14	25	0.98	24	0.94	55	2.17	58	2.28	590	23.23	25.0	0.98	4.42	9.72	92	181
6312-1339	M27	16	27	1.06	26	1.02	60	2.36	64	2.52	652	25.67	28.1	1.11	6.12	13.46	120	236
6312-1340	M33	19	33	1.30	30	1.18	70	2.76	78	3.07	782	30.79	34.5	1.36	10.88	23.94	181	357
6312-1341	M33	20	33	1.30	30	1.18	70	2.76	78	3.07	794	31.26	34.5	1.36	11.15	24.53	181	357
6312-1342	M36	22	36	1.42	34	1.34	75	2.95	85	3.35	885	34.84	40.4	1.59	14.36	31.59	213	420
6312-1343	M39	24	39	1.54	36	1.42	80	3.15	92	3.62	945	37.20	46.0	1.81	18.64	41.01	255	502
6312-1344	M45	28	45	1.77	42	1.65	90	3.54	105	4.13	1,110	43.70	50.0	1.97	30.42	66.92	342	672
6312-1345	M52	30	52	2.05	50	1.97	100	3.94	128	5.04	1,234	48.58	58.0	2.28	46.00	101.20	460	905
6312-1346	M56	34	56	2.20	50	1.97	110	4.33	136	5.35	1,341	52.80	65.0	2.56	56.50	124.30	531	1,044
6312-1347	M60	36	60	2.36	55	2.17	115	4.53	148	5.83	1,436	56.54	65.0	2.56	69.00	151.80	618	1,216

CODE: S3121\_B3

KINZI DATA SHEET

100%  
RECYCLABLE

WWW.KINZI.COM