

# PRODUCT DATA SHEET



## PRODUCT - DATA

**S306 (Standard)**  
Eye bolt (SUS type)

### S306 (Standard)

#### Technical Data

Casting material : AISI304 - DIN 1.4308/  
AISI316 - DIN 1.4408  
Forging material : AISI304 - DIN 1.4301/  
AISI316 - DIN 1.4401  
Production : S306 (Standard)  
Thread - Forged  
Bolt - Cast  
Surface treatment : "E.P." (Electro polished)

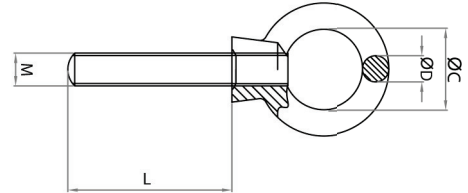

**M** Metric **I** Imperial **S306 (Standard)**  
**Eye bolt (SUS type)**

Note : Standard safety factor for working load is 1/4 of breaking load

S306 (Standard)		SIZE	ØC (mm)	ØC (inch)	ØD (mm)	ØD (inch)	L (mm)	L (inch)	M (mm/inch)	Unit weight (kgs)	Unit weight (lb)	B.L. (kgs)	B.L. (lb)
SS304	SS316												
4306-0006	6306-0006	6	16.0	0.63	5.0	0.20	13.0	0.51	M6	0.02	0.03	1,100	2,420
4306-0008	6306-0008	8	20.0	0.79	6.2	0.24	14.0	0.55	M8	0.03	0.07	1,800	3,960
4306-0010	6306-0010	10	24.5	0.96	8.0	0.31	18.0	0.71	M10	0.06	0.13	2,600	5,720
4306-0012	6306-0012	12	30.0	1.18	10.0	0.39	21.5	0.85	M12	0.11	0.24	3,500	7,700
4306-0016	6306-0016	16	35.0	1.38	12.5	0.49	26.5	1.04	M16	0.20	0.44	8,000	17,600
4306-0020	6306-0020	20	39.5	1.56	15.5	0.61	29.5	1.16	M20	0.37	0.80	10,500	23,100
4306-0024	6306-0024	24	50.0	1.97	20.0	0.79	36.0	1.42	M24	0.76	1.67	14,550	32,010
4306-0104	6306-0104	1/4"	16.0	0.63	5.0	0.20	13.0	0.51	1/4"	0.02	0.03	1,100	2,420
4306-0516	6306-0516	5/16"	20.0	0.79	6.2	0.24	14.0	0.55	5/16"	0.03	0.06	1,800	3,960
4306-0308	6306-0308	3/8"	24.5	0.96	8.0	0.31	18.0	0.71	3/8"	0.06	0.13	2,600	5,720
4306-0102	6306-0102	1/2"	30.0	1.18	10	0.39	21.5	0.85	1/2"	0.11	0.25	3,400	7,480
4306-0508	6306-0508	5/8"	35.0	1.38	12.5	0.49	26.5	1.04	5/8"	0.20	0.45	8,000	17,600
4306-0304	6306-0304	3/4"	39.5	1.56	15.5	0.61	29.5	1.16	3/4"	0.37	0.81	10,500	23,100
4306-0100	6306-0100	1"	50.0	1.97	20.0	0.79	35.0	1.38	1"	0.75	1.64	13,000	28,600

CODE: S306 (Standard)

KINZI DATA SHEET

**100%**  
**RECYCLABLE**

**WWW.KINZI.COM**