

PRODUCT DATA SHEET



PRODUCT - DATA

S2711BB

Oversize anchor shackle (nut and cotter pin)

S2711BB

Technical Data

Casting material : AISI316 - DIN 1.4408
 Production : S2711BB
 Shackle - Cast
 Pin- Cast
 Surface treatment : "E.P." (Electro polished)

Note : Standard safety factor for working load is 1/4 of breaking load



 **S2711BB**
 Oversize anchor shackle
 (nut and cotter pin)

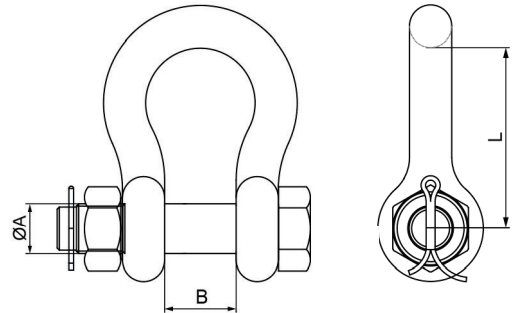

S2711BB SS316	SIZE	ØA (mm)	ØA (inch)	B (mm)	B (inch)	L (mm)	L (inch)	Unit weight (kgs)	Unit weight (lb)	B.L. (kgs)	B.L. (lb)
6271-1973	3/16"	6.35	0.25	9.52	0.37	25.4	1.00	0.02	0.04	1,500	3,300
6271-8516	1/4"	7.93	0.31	11.90	0.47	31.0	1.22	0.05	0.11	2,200	4,840
6271-8308	5/16"	9.52	0.37	13.50	0.53	36.5	1.44	0.09	0.20	3,000	6,600
6271-8716	3/8"	11.11	0.44	15.90	0.63	42.0	1.65	0.15	0.33	4,300	10,560
6271-8102	7/16"	12.70	0.50	20.60	0.81	49.2	1.94	0.24	0.53	7,000	15,400
6271-8508	1/2"	15.87	0.62	20.60	0.81	55.6	2.19	0.37	0.81	8,700	19,140
6271-8304	5/8"	19.05	0.75	27.00	1.06	68.3	2.69	0.69	1.52	12,000	26,400
6271-8708	3/4"	22.22	0.87	30.20	1.19	84.1	3.31	1.16	2.55	16,000	35,200
6271-8001	7/8"	25.40	1.00	38.10	1.50	100.0	3.94	1.73	3.81	19,000	41,800
6271-8118	1"	28.57	1.12	41.30	1.63	112.7	4.44	2.49	5.48	28,000	61,600

CODE: S2711BB

KINZI DATA SHEET

100%
RECYCLABLE

WWW.KINZI.COM