

PRODUCT DATA SHEET



PRODUCT - DATA

S2711

Oversize anchor shackle

S2711

Technical Data

Casting material : AISI316 - DIN 1.4408
 Production : S2711
 Shackle - Cast
 Pin - Cast
 Surface treatment : "E.P." (Electro polished)

Note : Standard safety factor for working load is 1/4 of breaking load



 **S2711**
Oversize anchor shackle

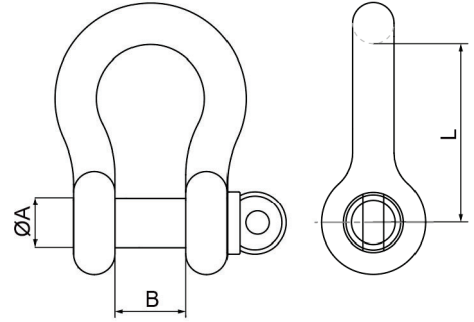

S2711 SS316	SIZE	ØA (mm)	ØA (inch)	B (mm)	B (inch)	L (mm)	L (inch)	Unit weight (kgs)	Unit weight (lb)	B.L. (kgs)	B.L. (lb)
6271-3614	3/16"	6.25	0.25	9.52	0.37	25.4	1.00	0.02	0.04	1,500	3,300
6271-1456	1/4"	7.80	0.31	11.90	0.47	31.0	1.22	0.04	0.09	2,200	4,840
6271-5638	5/16"	9.40	0.37	13.50	0.53	36.5	1.44	0.07	0.15	3,000	6,600
6271-3876	3/8"	11.00	0.43	15.90	0.63	42.0	1.65	0.13	0.29	4,800	10,560
6271-7612	7/16"	12.50	0.49	20.60	0.81	49.2	1.94	0.20	0.44	7,000	15,400
6271-1258	1/2"	15.70	0.62	20.60	0.81	55.6	2.19	0.29	0.64	8,700	19,140
6271-5834	5/8"	19.00	0.75	27.00	1.06	68.3	2.69	0.56	1.23	12,000	26,400
6271-3478	3/4"	22.20	0.87	30.20	1.19	84.1	3.31	0.95	2.09	16,000	35,200
6271-7801	7/8"	25.40	1.00	38.10	1.50	100.0	3.94	1.49	3.28	19,000	41,800
6271-0118	1"	28.50	1.12	41.30	1.63	112.7	4.44	2.16	4.75	28,000	61,600

CODE: S2711

KINZI DATA SHEET

100%
RECYCLABLE

WWW.KINZI.COM