

# PRODUCT DATA SHEET



## PRODUCT - DATA

### S251

Eye snaps (swivel end)

### S251

#### Technical Data

Casting material : AISI304 - DIN 1.4308/  
 AISI316 - DIN 1.4408  
 Production : S251 - Snap - Cast  
 Surface treatment : "E.P." (Electro polished)

Note : Standard safety factor for working load  
 is 1/4 of breaking load



**M** Metric **S251**  
 Eye snaps (swivel end)

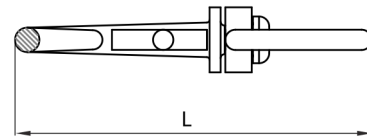
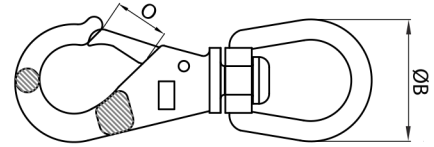

S251		SIZE	ØB (mm)	ØB (inch)	L (mm)	L (inch)	O (mm)	O (inch)	Unit weight (kgs)	Unit weight (lb)	B.L. (kgs)	B.L. (lb)
SS304	SS316											
4251-0000	6251-0000	0	16.5	0.65	69.0	2.72	10.0	0.39	0.04	0.09	200	440
4251-0001	6251-0001	1	19.5	0.77	85.0	3.35	13.0	0.51	0.06	0.13	170	374
4251-0002	6251-0002	2	20.5	0.81	99.0	3.90	15.5	0.61	0.10	0.22	250	550
4251-0003	6251-0003	3	19.5	0.77	117.5	4.63	20.5	0.81	0.15	0.33	340	748

CODE: S251

KINZI DATA SHEET

**100%**  
**RECYCLABLE**

[WWW.KINZI.COM](http://WWW.KINZI.COM)