

PRODUCT DATA SHEET



PRODUCT - DATA

S2471
Spring snaps (hook end)

S2471

Technical Data

Casting material : AISI304 - DIN 1.4308/
AISI316 - DIN 1.4408
Production : S2471 - Snap - Cast
Surface treatment : "E.P." (Electro polished)

Note : Standard safety factor for working load is 1/4 of breaking load

Insert a chain and then tap with a hammer.

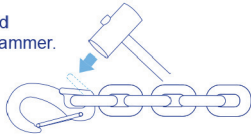

M Metric **S2471**
Spring snap (hook end)

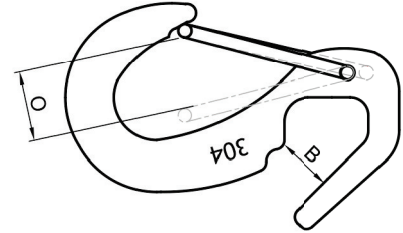
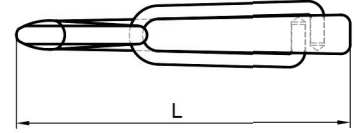

S2471		SIZE	B (mm)	B (inch)	L (mm)	L (inch)	O (mm)	O (inch)	Unit weight (kgs)	Unit weight (lb)	B.L. (kgs)	B.L. (lb)
SS304												
4247-1050		50	8.5	0.33	50	1.97	12.8	0.50	0.02	0.04	250	550
4247-1065		65	8.7	0.34	65	2.56	16.6	0.65	0.05	0.11	350	770
4247-1090		90	11.5	0.45	90	3.54	22.8	0.90	0.12	0.26	700	1,540

CODE: S2471

KINZI DATA SHEET

100%
RECYCLABLE

WWW.KINZI.COM