

PRODUCT DATA SHEET



PRODUCT - DATA

S2464
Snap shackle

S2464

Technical Data

Casting material : AISI316 - DIN 1.4408
 Forging material : AISI316 - DIN 1.4401
 Production : S2464 - Shackle - Cast
 Surface treatment : "E.P." (Electro polished)

Note : Standard safety factor for working load
 is 1/4 of breaking load



M S2464
Metric Snap shackle

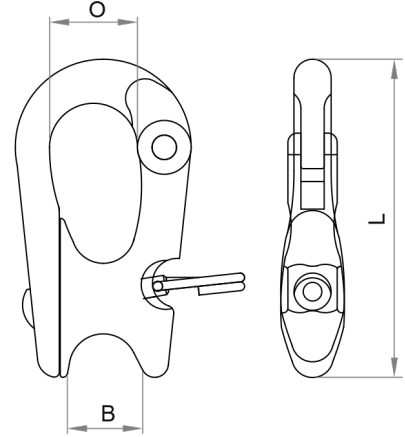

S2464 SS316	SIZE	B (mm)	B (inch)	L (mm)	L (inch)	O (mm)	O (inch)	Unit weight (kgs)	Unit weight (lb)	B.L. (kgs)	B.L. (lb)
6246-4052	52	12	0.47	52	2.05	10	0.39	0.05	0.11	830	1,826
6246-6066	66	15	0.59	66	2.60	14	0.55	0.09	0.20	1,850	4,070

CODE: S2464

KINZI DATA SHEET

100%
RECYCLABLE

WWW.KINZI.COM