

# PRODUCT DATA SHEET



## PRODUCT - DATA

**S2344**  
Closed end thimbles

### S2344

**Technical Data**

Forging material : AISI304 - DIN 1.4308  
Production : S2344 - Thimble - Cast  
Surface treatment : "E.P." (Electro polished)

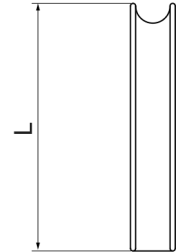
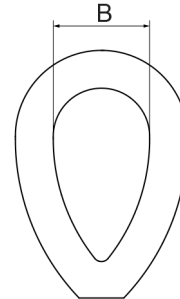

**M** Metric **S2344**  
Closed end thimbles

<b>S2344</b>		SIZE	B (mm)	B (inch)	L (mm)	L (inch)	ØCable (mm)	Unit weight (kgs)	Unit weight (lb)
SS304	SS316								
4234-4002	6234-4002	2	8	0.31	21.0	0.83	2	0.01	0.02
4234-4003XS	6234-4003XS	3xs	10	0.39	23.0	0.91	3	0.01	0.02
4234-4003	6234-4003	3	10	0.39	26.0	1.02	3	0.01	0.02
4234-4004	6234-4004	4	12	0.47	32.0	1.26	4	0.02	0.04
4234-4006	6234-4006	6	16	0.63	43.0	1.69	6	0.04	0.09
4234-4008	6234-4008	8	24	0.94	58.5	2.30	8	0.05	0.11
4234-4010	6234-4010	10	28	1.10	72.0	2.83	10	0.11	0.24
4234-4012	6234-4012	12	35	1.38	86.0	3.39	12	0.18	0.40
4234-4014	6234-4014	14	39	1.54	100.8	3.97	14	0.27	0.59
4234-4016	6234-4016	16	45	1.77	110.0	4.33	16	0.30	0.66
4234-4019	6234-4019	19	54	2.13	124.0	4.88	19	0.46	1.01
4234-4022	6234-4022	22	60	2.36	130.0	5.12	22	0.60	1.32
4234-4025	6234-4025	25	70	2.76	148.0	5.83	25	0.92	2.02

CODE: S2344

KINZI DATA SHEET

**100%**  
**RECYCLABLE**

[WWW.KINZI.COM](http://WWW.KINZI.COM)