

# PRODUCT DATA SHEET



## PRODUCT - DATA

### S211-E2 Double snatch block (eye top)

### S211-E2

#### Technical Data

Casting material : AISI 304 - DIN 1.4308  
 Forging material : AISI 304 - DIN 1.4301  
 Rod : AISI 304 - DIN 1.4301  
 Production : S211-E2  
     Swivel eye - Cast  
     Sheave - Cast  
     Block - Forged  
     Eye end - Rod  
 Surface treatment : "E.P." (Electro polished)

Note : Standard safety factor for working load  
 is 1/4 of breaking load.

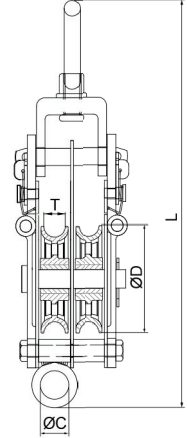
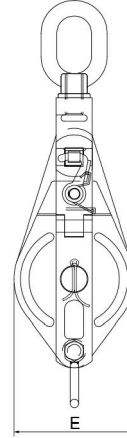

**S211-E2**  
Double snatch block (eye top)

S211-E2 SS304	SIZE	ØC (mm)	ØC (inch)	ØD (mm)	ØD (inch)	E (mm)	E (inch)	L (mm)	L (inch)	T (mm)	T (inch)	Unit weight (kgs)	Unit weight (lb)	B.L. (kgs)	B.L. (lb)
4211-2075	75	20	0.79	75	2.95	83	3.27	290	11.42	15	0.59	2.08	4.57	3,500	7,700

CODE: S211-E2

KINZI DATA SHEET

**100%**  
**RECYCLABLE**

[WWW.KINZI.COM](http://WWW.KINZI.COM)