

PRODUCT DATA SHEET



PRODUCT - DATA

S210-H2

Double heavy block (hook top)

S210-H2

Technical Data

Casting material : AISI 304 - DIN 1.4308
 Forging material : AISI 304 - DIN 1.4301
 Rod : AISI 304 - DIN 1.4301
 Production : S210-H2
 Hook - Cast
 Sheave - Cast
 Block - Cast
 Eye end - Rod
 Surface treatment : "E.P." (Electro polished)

Note : Standard safety factor for working load is 1/4 of breaking load.

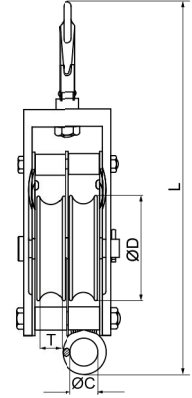
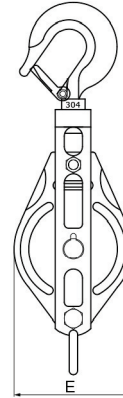

S210-H2
Double heavy block (hook top)

S210-H2		SIZE	ØC (mm)	ØC (inch)	ØD (mm)	ØD (inch)	E (mm)	E (inch)	L (mm)	L (inch)	T (mm)	T (inch)	Unit weight (kgs)	Unit weight (lb)	B.L. (kgs)	B.L. (lb)
SS304																
4210-2275	75	20	0.79	75	2.95	83	3.27	280	11.02	15	0.59	1.68	3.70	2,300	5,060	
4210-2210	100	35	1.38	100	3.93	113	4.45	340	13.39	18	0.70	2.93	6.45	2,300	5,060	
4210-2212	125	35	1.38	125	4.92	139	5.47	395	15.55	20	0.79	3.90	8.58	3,950	8,690	

CODE: S210-H2

KINZI DATA SHEET

100%
RECYCLABLE

WWW.KINZI.COM