

# PRODUCT DATA SHEET



## PRODUCT - DATA

### S0182I

Swivel (jaw and jaw with internal hexagon pin)

### S0182I

#### Technical Data

Casting material : AISI316 - DIN 1.4408  
 Forging material : AISI316 - DIN 1.4401  
 Production : S0182I  
 Swivel - Cast  
 Pin - See Chart  
 Surface treatment : "E.P." (Electro polished)

Note : Standard safety factor for working load is 1/4 of breaking load

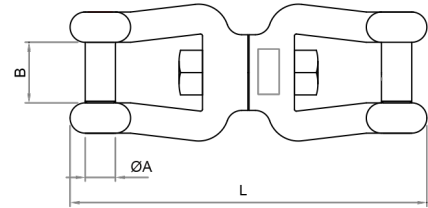

**M** Metric **S0182I**  
 Swivel (jaw and jaw with internal hexagon pin)

S0182I SS316	SIZE	ØA (mm)	ØA (inch)	B (mm)	B (inch)	L (mm)	L (inch)	Pin	Unit weight (kgs)	Unit weight (lb)	B.L. (kgs)	B.L. (lb)
6018-2106	6	6	0.24	12	0.47	66	2.60	Forged	0.06	0.13	1,200	2,640
6018-2108	8	8	0.31	16	0.63	94	3.70	Forged	0.16	0.35	1,900	4,180
6018-2110	10	10	0.39	20	0.79	118	4.65	Cast	0.31	0.68	3,500	7,700
6018-2113	13	13	0.51	26	1.02	152	5.98	Cast	0.66	1.45	5,000	11,000
6018-2116	16	16	0.63	32	1.26	188	7.40	Cast	1.13	2.49	8,500	18,700
6018-2119	19	19	0.75	38	1.50	223	8.78	Cast	1.84	4.05	10,000	22,000

CODE: S0182I

KINZI DATA SHEET

**100%**  
**RECYCLABLE**

[WWW.KINZI.COM](http://WWW.KINZI.COM)