

PRODUCT DATA SHEET



PRODUCT - DATA

S01811

Swivel (eye and jaw with internal hexagon pin)

S01811

Technical Data

Casting material : AISI304 - DIN 1.4308/
 AISI316 - DIN 1.4408
 Production : S01811
 Pin - See Chart
 Swivel - Cast
 Surface treatment : "E.P." (Electro polished)

Note : Standard safety factor for working load is 1/4 of breaking load



S01811
 Swivel (eye and jaw with internal hexagon pin)

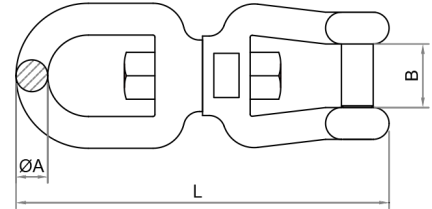

S01811 SS316	SIZE	ØA (mm)	ØA (inch)	B (mm)	B (inch)	L (mm)	L (inch)	Unit weight (kgs)	Unit weight (lb)	B.L. (kgs)	B.L. (lb)
6018-1106	6	6	0.24	12	0.47	66	2.60	0.06	0.13	1,200	2,640
6018-1108	8	8	0.31	16	0.63	94	3.70	0.15	0.33	1,900	4,180
6018-1310	10	10	0.39	20	0.79	118	4.65	0.28	0.62	3,500	7,700
6018-1113	13	13	0.51	26	1.02	152	5.98	0.62	1.36	5,000	11,000
6018-1116	16	16	0.63	32	1.26	188	7.40	1.04	2.29	8,500	18,700
6018-1119	19	19	0.75	38	1.50	223	8.78	1.68	3.70	10,000	22,000

CODE: S01811

KINZI DATA SHEET

100%
RECYCLABLE

WWW.KINZI.COM