

# PRODUCT DATA SHEET



## PRODUCT - DATA

**S0181**  
Swivel (eye and jaw)

### S0181

#### Technical Data

Casting material : AISI304 - DIN 1.4308/  
AISI316 - DIN 1.4408  
Production : S0181  
Pin - Forged  
Swivel - Cast  
Surface treatment : "E.P." (Electro polished)

Note : Standard safety factor for working load  
is 1/4 of breaking load

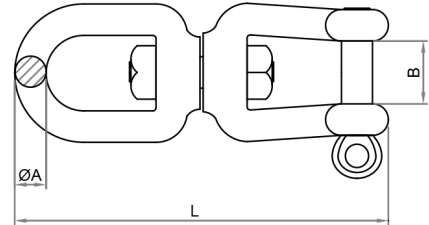

**M** S0181  
Metric Swivel (eye and jaw)

S0181		SIZE	ØA (mm)	ØA (inch)	B (mm)	B (inch)	L (mm)	L (inch)	Unit weight (kgs)	Unit weight (lb)	B.L. (kgs)	B.L. (lb)
SS304	SS316											
-	<b>6018-1005</b>	<b>5</b>	5	0.2	13	0.51	59.7	2.35	0.03	0.07	650	1,430
4018-1006	<b>6018-1006</b>	<b>6</b>	6	0.24	12	0.47	66.0	2.60	0.06	0.13	1,200	2,640
4018-1008	<b>6018-1008</b>	<b>8</b>	8	0.31	16	0.63	94.0	3.70	0.15	0.33	1,900	4,180
4018-1010	<b>6018-1010</b>	<b>10</b>	10	0.39	20	0.79	118.0	4.65	0.29	0.64	3,500	7,700
4018-1013	<b>6018-1013</b>	<b>13</b>	13	0.51	26	1.02	152.0	5.98	0.64	1.41	5,000	11,000
4018-1016	<b>6018-1016</b>	<b>16</b>	16	0.63	32	1.26	188.0	7.40	1.09	2.40	8,500	18,700
4018-1019	<b>6018-1019</b>	<b>19</b>	19	0.75	38	1.50	223.0	8.78	1.79	3.94	10,000	22,000

CODE: S0181

KINZI DATA SHEET

**100%**  
**RECYCLABLE**

**WWW.KINZI.COM**