

PRODUCT DATA SHEET



PRODUCT - DATA

S018 Swivel (eye and eye)

S018

Technical Data

Casting material : AISI304 - DIN 1.4308/
 AISI316 - DIN 1.4408
 Production : S018 - Swivel - Cast
 Surface treatment : "E.P" (Electro polished)

Note : Standard safety factor for working load
 is 1/4 of breaking load

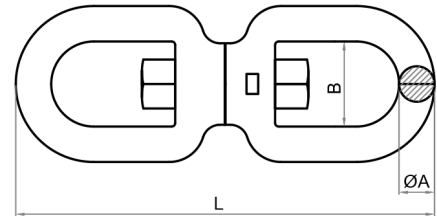

M S018
Metric Swivel (eye and eye)

S018		SIZE	ØA (mm)	ØA (inch)	B (mm)	B (inch)	L (mm)	L (inch)	Unit weight (kgs)	Unit weight (lb)	B.L. (kgs)	B.L. (lb)
SS304	SS316											
4018-0004	6018-0004	4	4	0.16	11.0	0.43	50	1.97	0.02	0.04	450	990
4018-0005	6018-0005	5	5	0.20	13.0	0.51	59	2.32	0.03	0.07	650	1,430
4018-0006	6018-0006	6	6	0.24	14.7	0.58	66	2.60	0.06	0.13	1,200	2,640
4018-0008	6018-0008	8	8	0.31	20.5	0.81	94	3.70	0.13	0.30	1,900	4,180
4018-0009	6018-0009	9	9	0.35	22.0	0.87	102	4.02	0.17	0.38	3,000	6,600
4018-0010	6018-0010	10	10	0.39	24.0	0.94	118	4.65	0.25	0.56	3,500	7,700
4018-0013	6018-0013	13	13	0.51	31.0	1.22	152	5.98	0.57	1.26	5,000	11,000
4018-0016	6018-0016	16	16	0.63	38.0	1.50	188	7.40	0.98	2.16	8,500	18,700
4018-0019	6018-0019	19	19	0.75	42.0	1.65	223	8.78	1.57	3.46	10,000	22,000
4018-0022	6018-0022	22	22	0.87	47.0	1.85	240	9.45	2.27	4.99	11,500	25,300
4018-0025	6018-0025	25	25	0.98	63.0	2.48	294	11.57	3.86	8.49	13,000	28,600

CODE: S018

KINZI DATA SHEET

100%
RECYCLABLE

WWW.KINZI.COM