

Product Introduction

GVM On-camera light is a professional video light with ultra-thin ABS body, which is light and simple, this series have two models: GVM-10S and RGB-10S. The GVM-10S equipped with 240 high color rendering CRI 95+ LED beads to help you restore true colors, you can adjust the color temperature from 3200K to 5600K. The RGB-10S equipped with 192 high color rendering SMD beads to help you restore true colors, you can adjust the brightness / color temperature / hue / color saturation, and the color temperature can adjust from 3200K to 5600K. A variety of convenient power supply methods: can be powered by the DC adapter when shooting indoors; or used the NPF mount battery when outdoor shooting, portable and easy to carry. Use step-less adjustment to control the brightness / color temperature, which brings great convenience to your shooting.

Main Features

- Ultra Heat Dissipation
- High Color Rendering Index, CRI95+
- Brightness Adjustment
- Color Temperature Adjustment
- Dual Power System
- Convenient Light Set-Up and Stabilization system

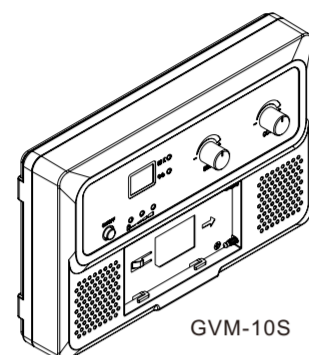

GVM-10S

- Ultra Heat Dissipation
- High Color Rendering Index
- Brightness Adjustment
- Color Temperature Adjustment
- Hue Adjustment System
- Color Saturation Adjustment System
- Mobile APP control adjustment function
- Dual Power System
- Convenient Light Set-Up and Stabilization system

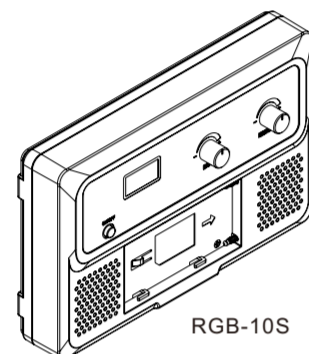

RGB-10S

1

Function introduction

- 1 Power Switch
- 2 Electric quantity display light
- 3 Digital display
- 4 Brightness display light
- 5 Color temperature display light
- 6 Brightness adjustment knob
- 7 Color temperature adjustment knob
- 8 Battery plate
- 9 DC Adapter Interface

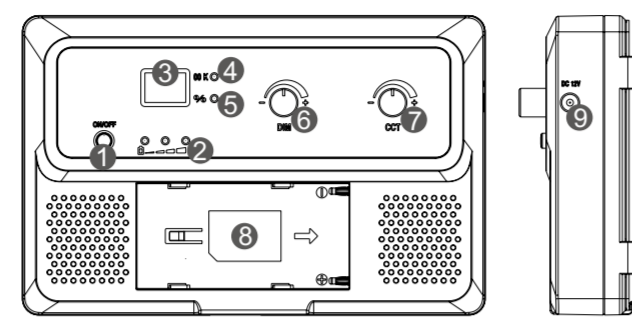

GVM-10S

- 1 Power Switch
- 2 LCD Digital display
- 3 brightness adjustment wheel
- 4 Hue / Color saturation / color temperature switch button and WIFI reset button
- 5 Battery plate
- 6 DC Adapter Interface

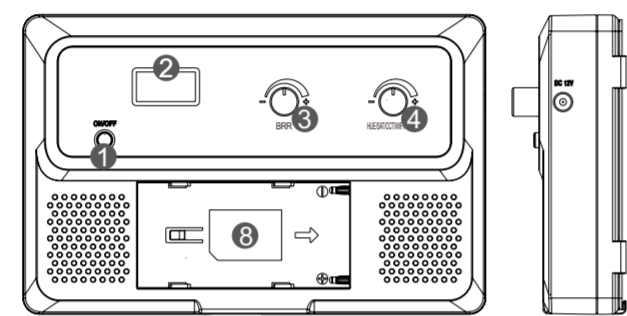

RGB-10S

2

Accessories

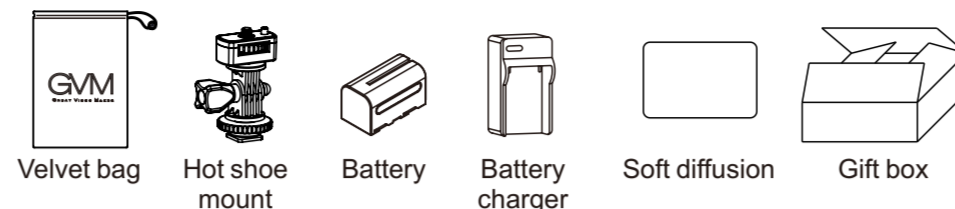

Using The Light

- 1 Align the screw of the hot shoe mount with the bracket mounting hole of the light, and then turn the knob on the hot shoe mount to the right to fix the light on the hot shoe mount.
- 2 The hot shoe mount can be attached to the camera by snapping the shoe mount into the camera's boot and turning the knob under the hot shoe mount to the left.

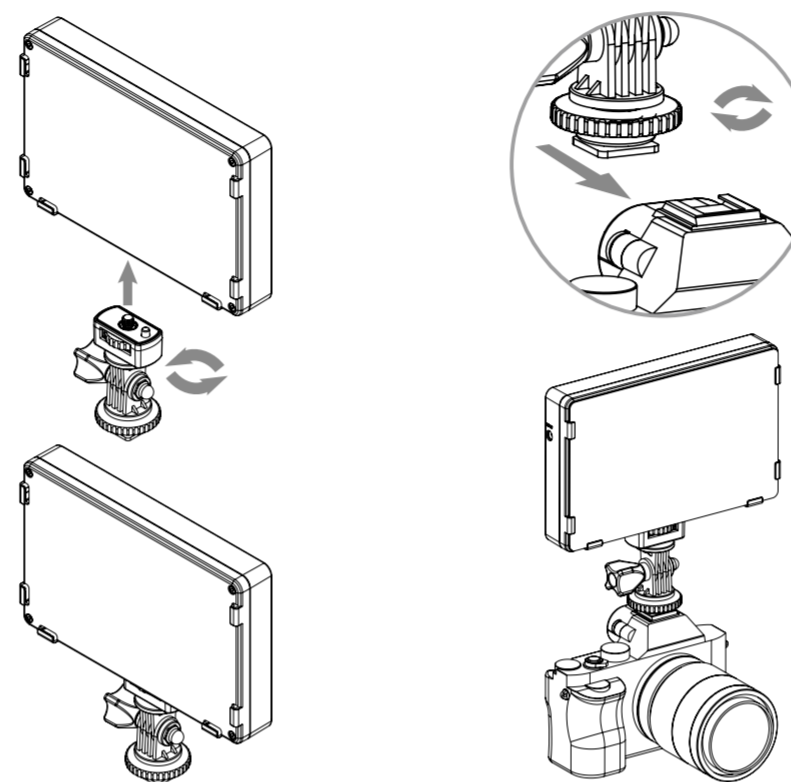

3

- 3 Insert the soft diffusion from top to bottom.
- 4 Insert the DC Adapter or battery, open the power switch.

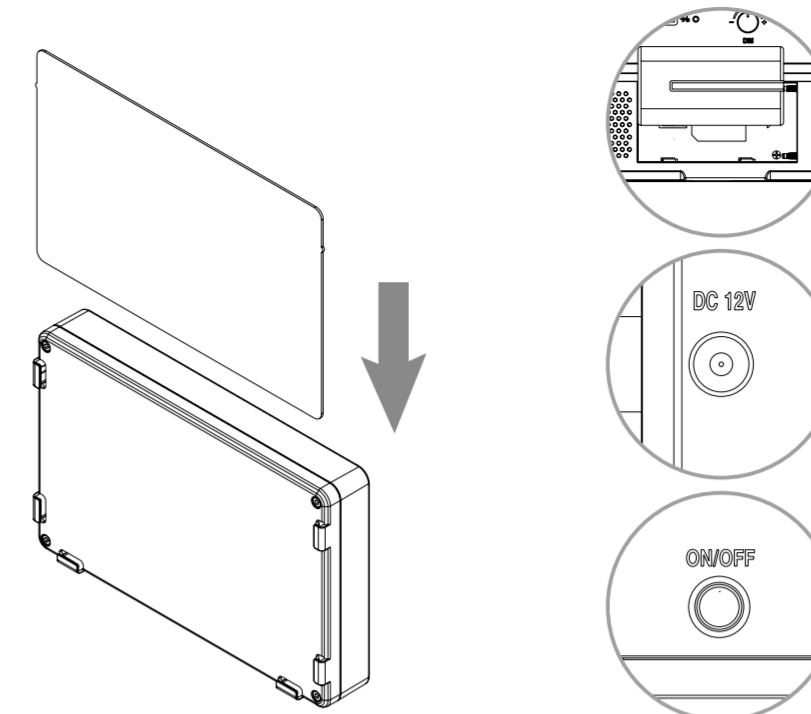

- 6 **GVM-10S**
Press the power switch to rotate the brightness / color temperature knob to quickly control the brightness and color temperature, the digital display shows the corresponding parameters at the same time, and the indicator light at the bottom left shows the battery power.

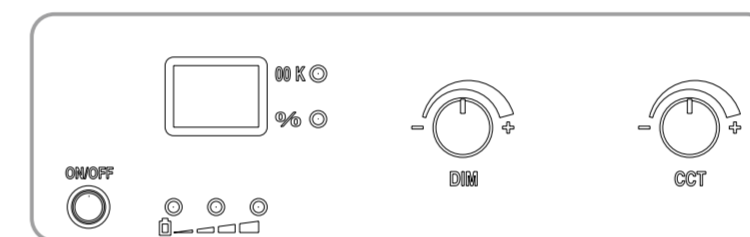

4

GVM

Great Video Maker



For IOS

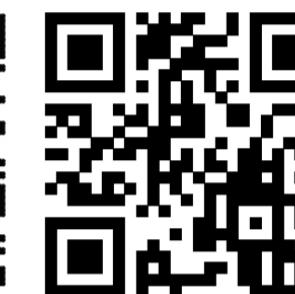

Scan the code to download the APP

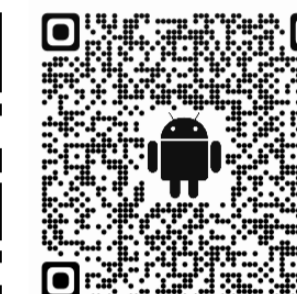

For Android

Add: 338 N Canal St, #20, South San Francisco, CA94080, USA
Web: www.gvmlid.com
Email: support@gvmlid.com

- 6 **RGB-10S**
Brightness, color temperature, hue, color saturation and WIFI reset password operation:

Brightness: rotate the left wheel to adjust the brightness between 1~100%.
Hue: Press the right wheel to switch the HUE mode, rotate the right wheel to adjust the hue between 0~360°.
Color Saturation: Press the right wheel to switch the SAT mode, rotate the right wheel to adjust the color saturation between 0~100%.
Color Temperature: Press the right wheel to switch the CCT mode, rotate the right wheel to adjust the color saturation between 3200K~5600K.
WIFI Password Reset: long press the right wheel about 3 seconds to reset the WIFI password to be factory set.

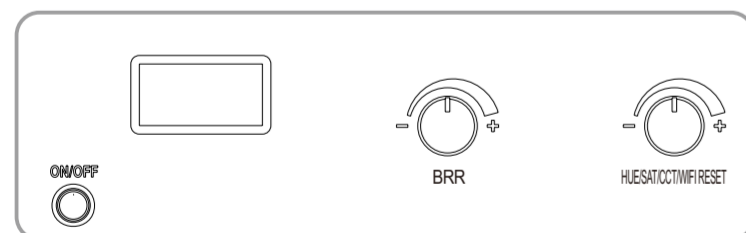

Specification

Model	LED Bead	CRI	LED angle	Voltage	Color Temperature	Power Consumption	Size
GVM-10S	240	95+	45°	DC12V	3200K~5600K	10W	170×110×32mm
RGB-10S	192	95+	120°	DC12V	3200K~5600K	10W	170×110×32mm

Attention

1. Do not look at the working light directly.
2. Do not cover the working light, or it will avoid the product cooling to damage it.
3. Do not place the Light at flammable items such as alcohol, gasoline or near volatile solvent.
4. Do not place any liquid on the Light interior or fall into the Light.
5. Power off when you finish using the Light in case of a fire.
6. Carefully to move the Light in the case of dropping it down.

5

APP Intelligent Control System

The light equipped with mobile APP control function, can be controlled by your smart mobile device (above of Android 4.0 or IOS 9.0), to searched and download the GVM Easily APP in major APP stores (such as Apple store / Google Play. etc.).

- 1 Open the light.
- 2 Click on the installed APP.

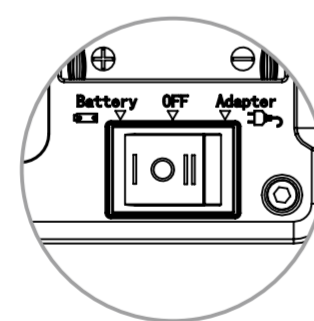

GVM Easily

- 3 Register your account and password first
- 4 Select the light or equipment you purchased.

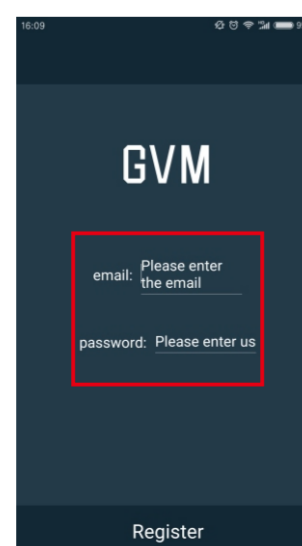

6

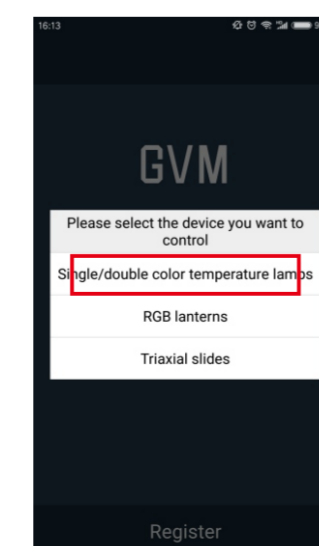

- 5 Click on the menu at the top right.
- 6 Click the Settings button.

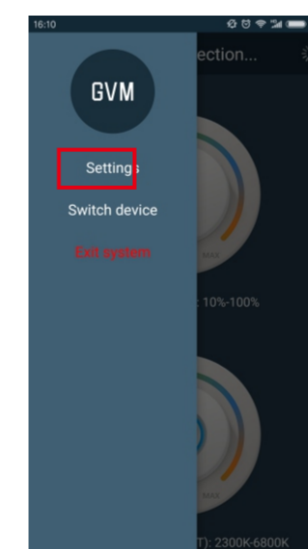
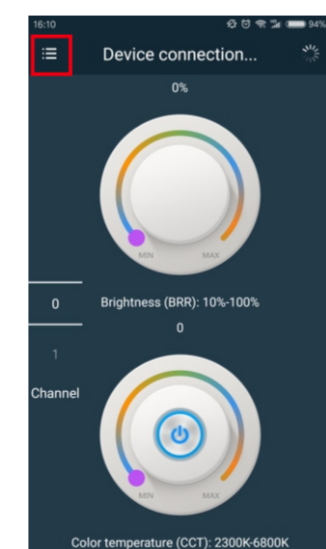

- 7 Click to switch WIFI.
- 8 To find and click the WIFI (GVM_LED), feed in the initial password (gvm_admin) to connect the WIFI.

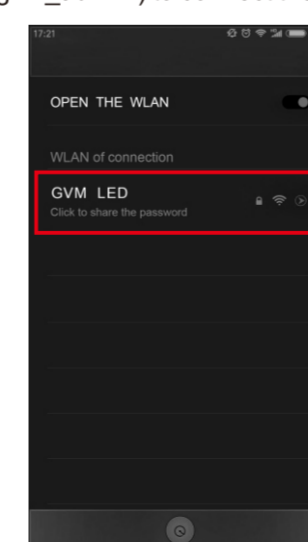
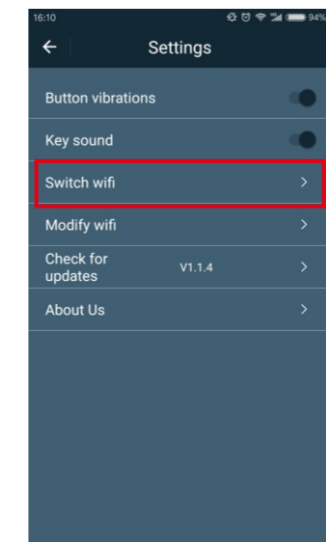

7

- 9 WIFI's name and password can be modified. (Note: only one GVM-LED signal can be displayed without modifying the name)
- 10 By changing the name one by one, you can decompose different WIFI hotspots and control multiple lights.

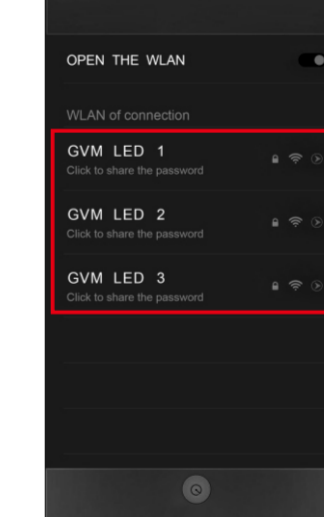
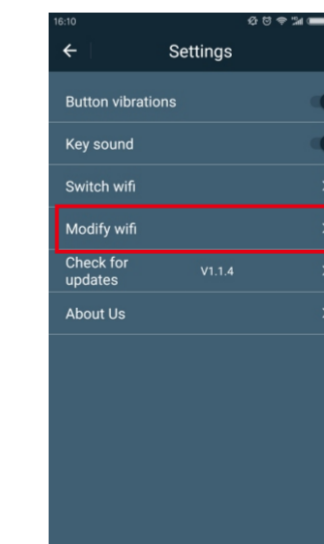

- 11 Returning to the operator menu, the lights can be controlled (adjust color temperature / brightness / open or close lights, etc.).



8

GVM
Great Video Maker

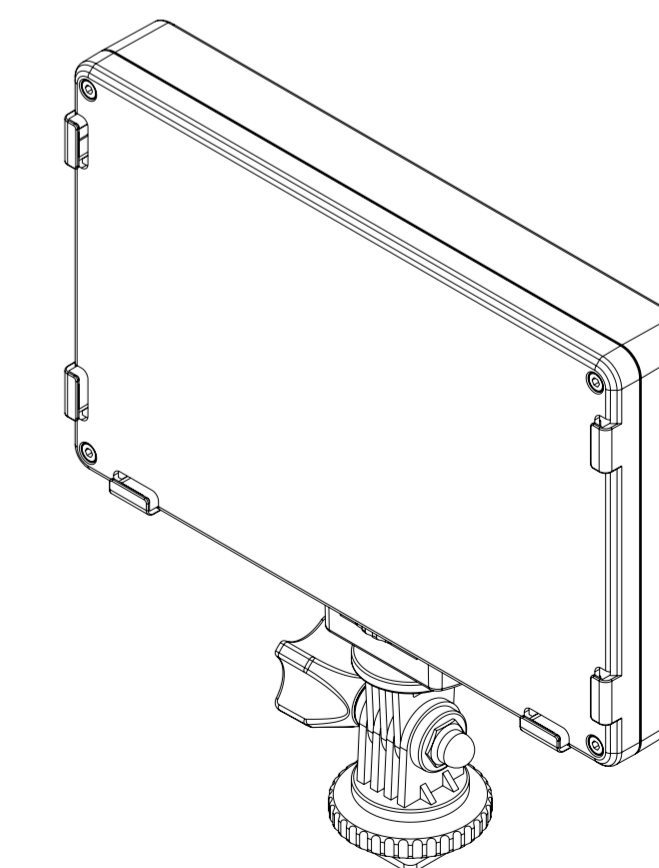

GVM-10S
RGB-10S
Product Manual

5

6

7

8