

Wall Flashing Kit Installation Instructions

Before You Begin

- Make sure you use proper PPE; steel-toed footwear, work gloves, hearing protection, and eye protection.
- Ensure your tools are in good working condition.
- Read & understand all instructions before beginning.

What you will need

- Marking tools
- Rivet gun
- Drill

What is included

- Wall Flashing Components (fig. 1):
 - 2X Headers (CWF-HDR-R0)
 - 4X Flanges (CWF-STD-FLG-R0)
 - 4X Sides (CWF-STD-SIDE-R0)
- Hardware:
 - 1 pack of rivets
 - 1 pack of self-tapping screws

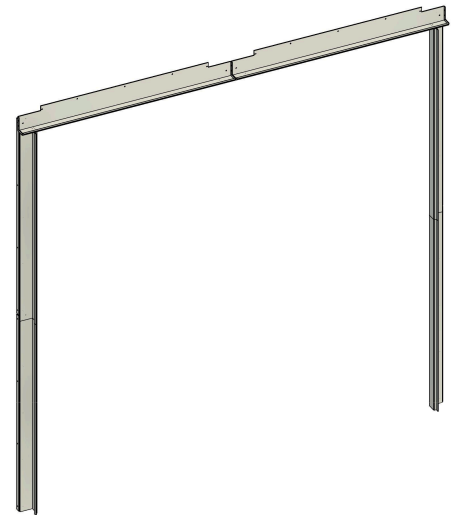
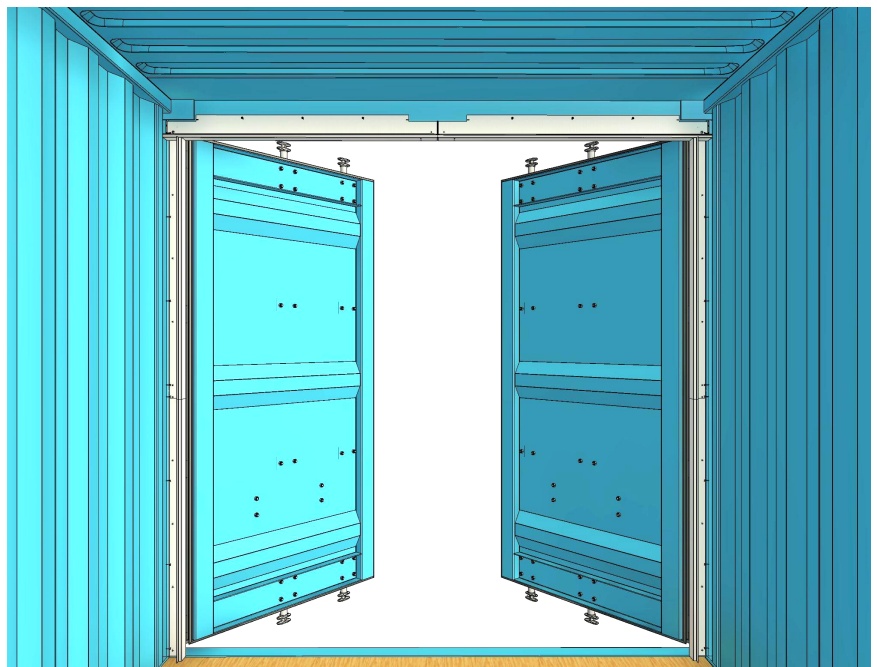

Figure 1 - Wall Flashing Kit

Installation

Before starting the process of installation please take note that:

- This product is designed to fit most containers. If your container is abnormal, pieces may need to be trimmed/adjusted to fit as intended.
- Proper installation is necessary for the best performance of this product
- Since this product is symmetrical, instruction images show the installation on only one side of the container. Repeat each step on the other side of the container.



Step 1

Place your header on the container tubing and align the cutout with the corner casting. Get as close to the weld around the corner casting while remaining flush to the tubing. The notch in the cutout should line up with the underside of the casting (fig. 2.1). Fasten the headers to the container tubing using self-tapping screws (fig. 2.2).

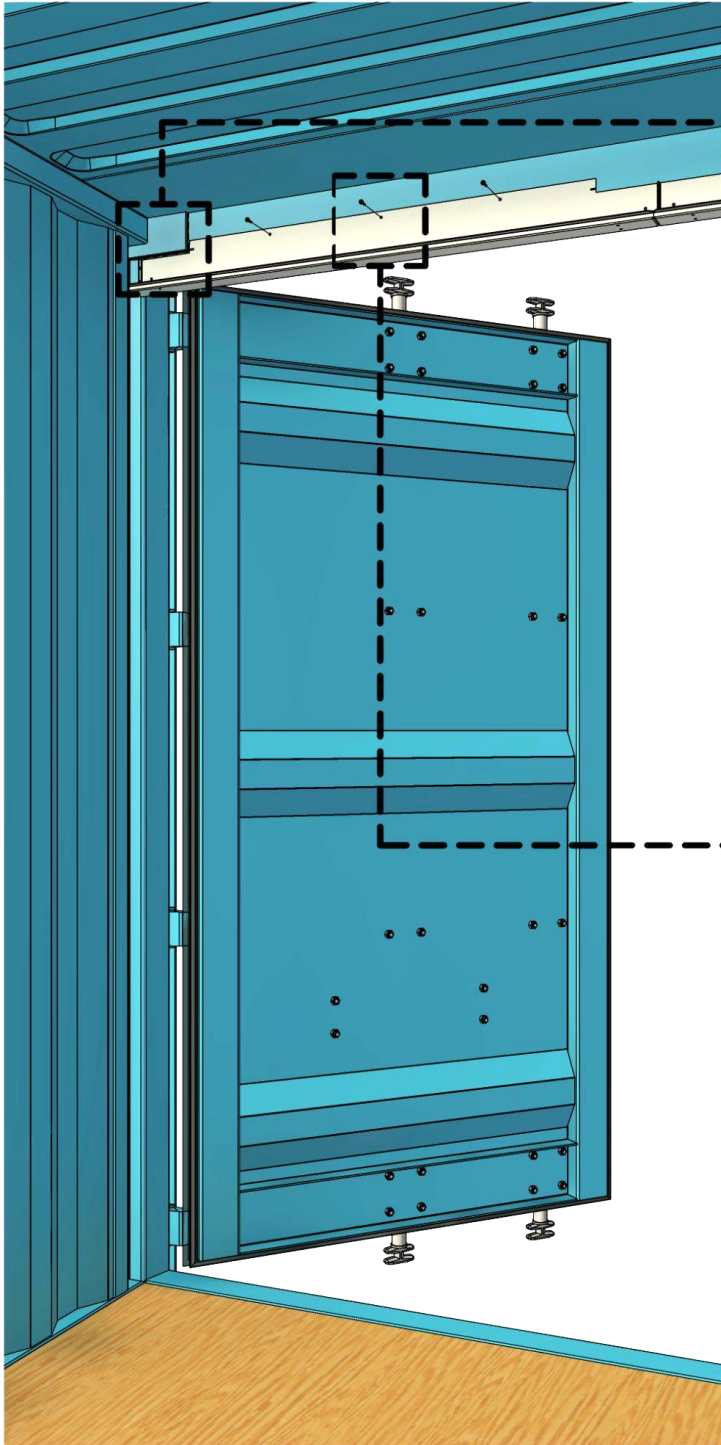

Figure 2 - Header

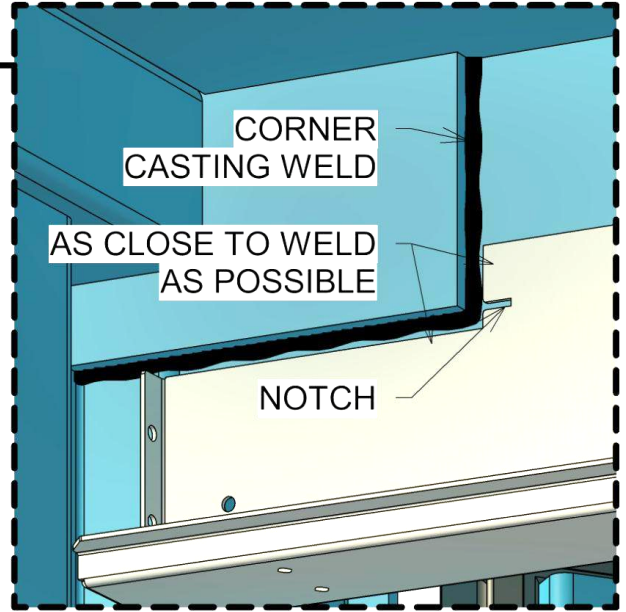

Figure 2.1 - Header Placement

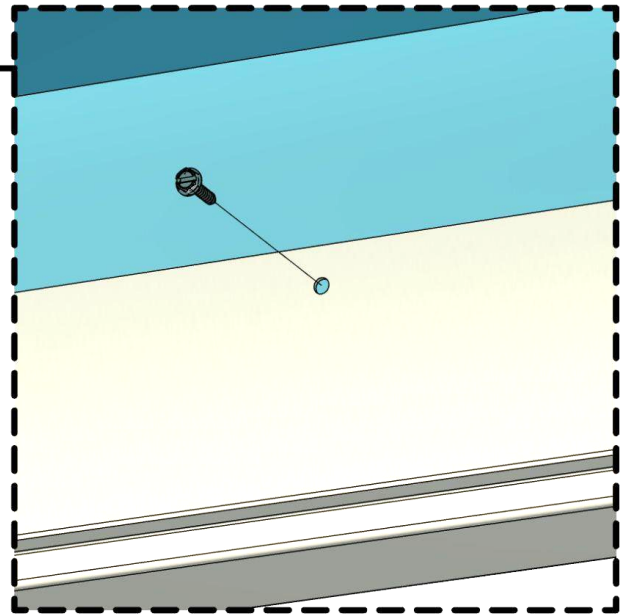

Figure 2.2 - Header Fastener

Step 2

Align the hole on the end of your first flange with the hole on the end of your header then fasten them together with a rivet (fig. 3.1). Place the second flange making sure to keep the flange face flush with the side wall container tubing (see dotted line in fig. 3.2). Fasten both flanges to the side wall tubing with self-tapping screws (fig. 3.2).



Figure 3 - Flanges

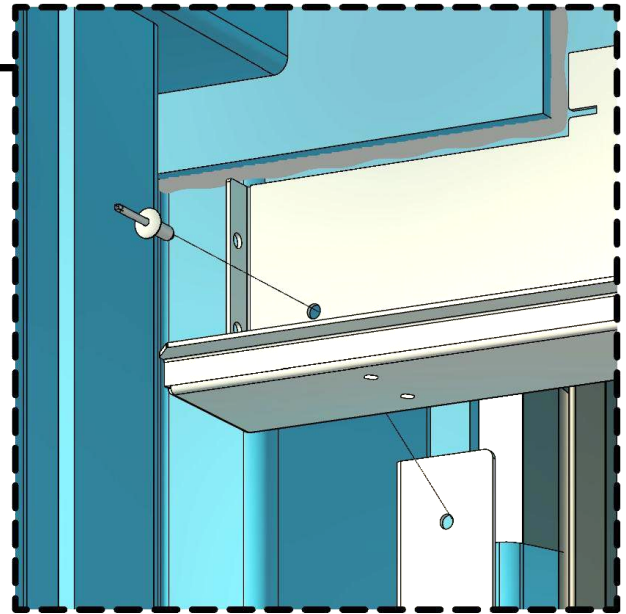

Figure 3.1 - Flange/Header Connection

TOP-DOWN VIEW

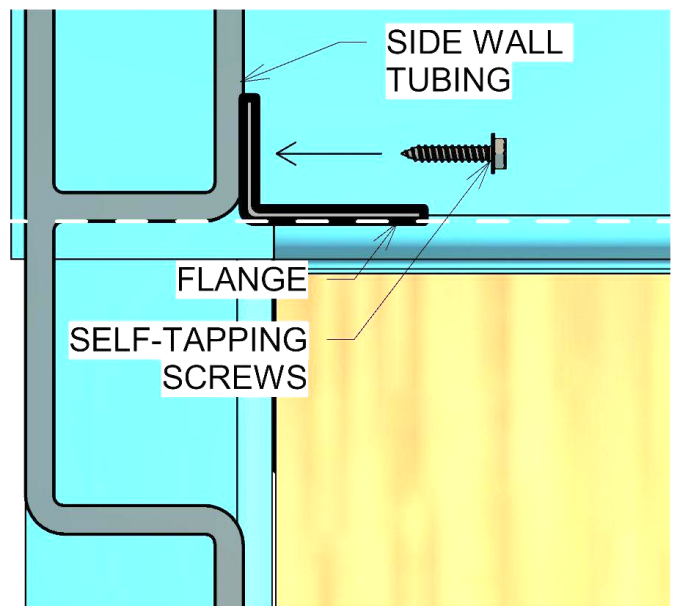

Figure 3.2 - Flange Fastener Plan View

Step 3

Place your side pieces against your flanges and adjust to match the thickness of your wall (fig. 4.1). Fasten the side pieces to your flanges using rivets from the door side (fig. 4.1 & 4.2).

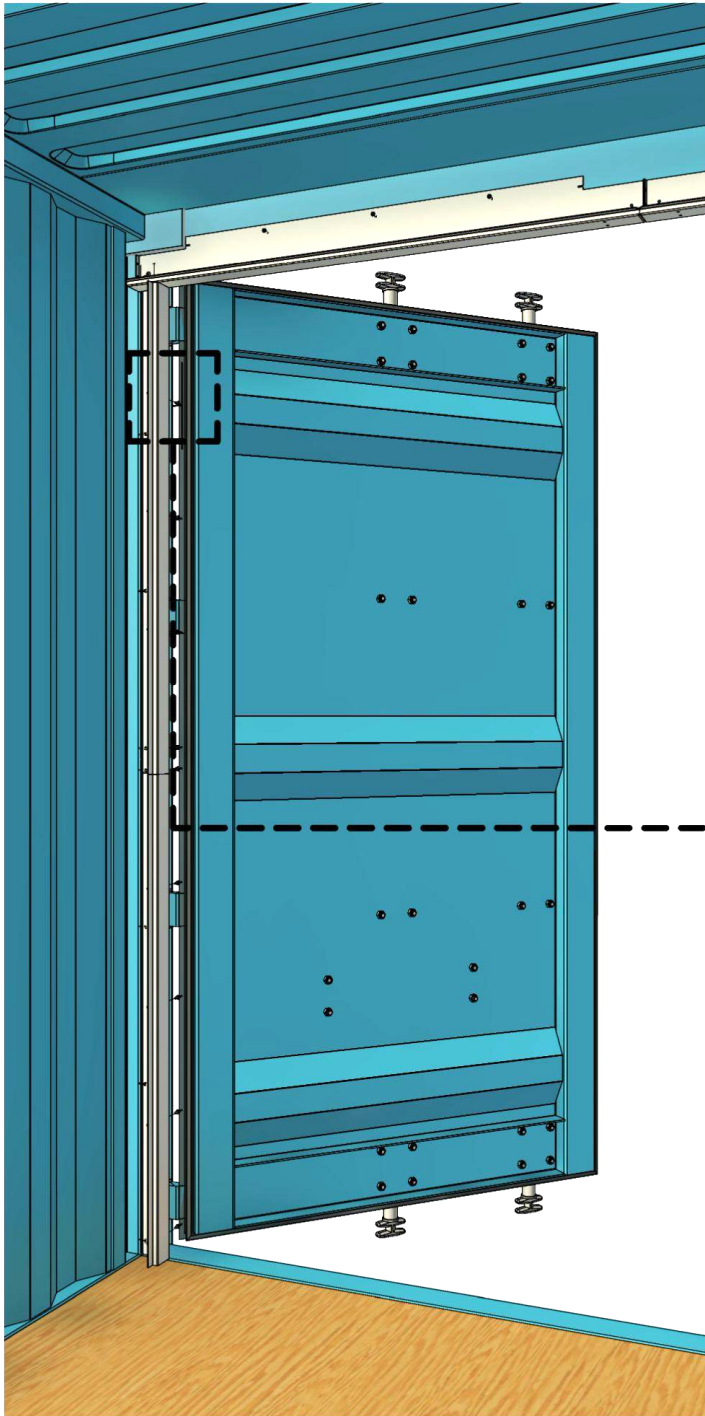

Figure 4 - Sides

TOP-DOWN VIEW

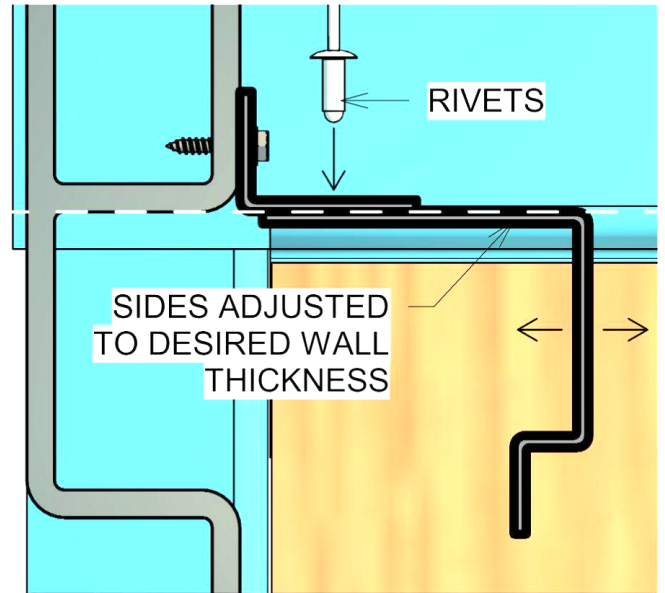

Figure 4.1 - Side/Flange Alignment Plan View

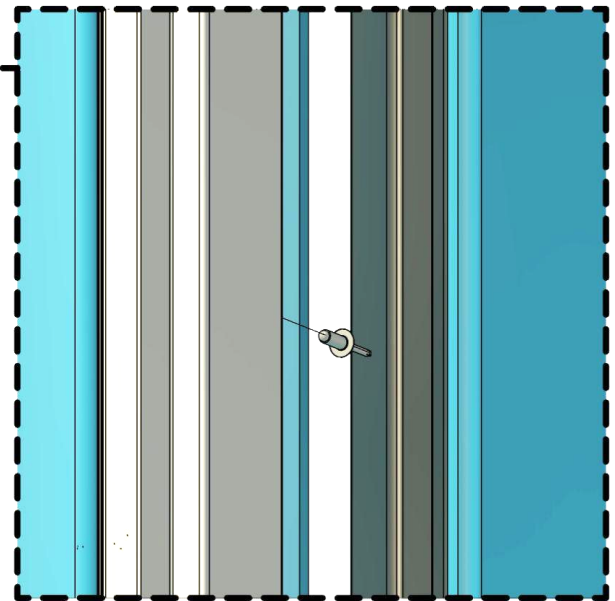

Figure 4.2 - Side Fastener

Additional Information

An in-depth installation video can be viewed by scanning the code below with your phone's camera.



Visit [containermodificationworld.com](https://www.containermodificationworld.com) for more resources and product catalogs.