

40' Steel Stud Bracket Installation Instructions

Before You Begin

- Make sure you use proper PPE; steel-toed footwear, work gloves, eye protection.
- Ensure your tools are in good working condition.
- Read & understand all instructions before beginning.

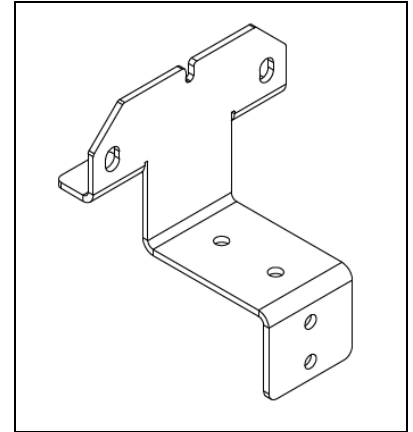

What you will need

- Screw Driver
- Drill

What is included

- 40 Composite SSB
- Pack of No.8 ½ screws

Assembly

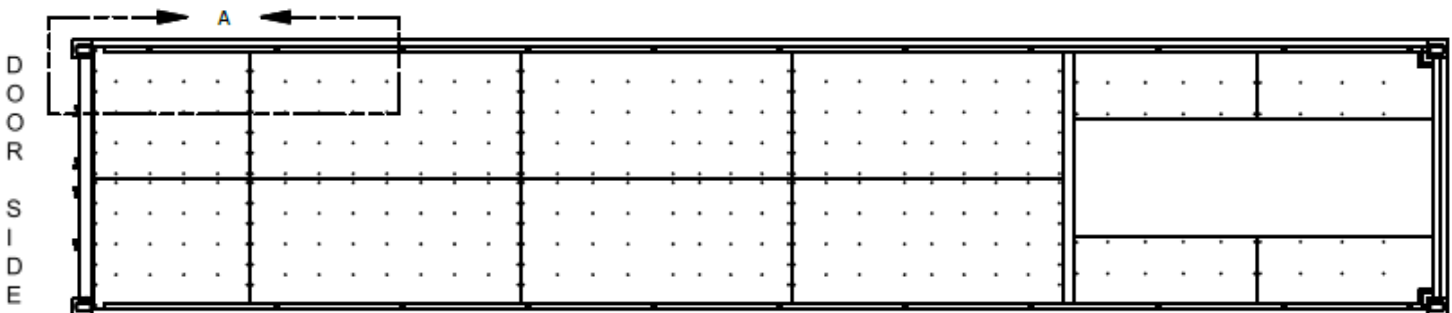

Figure 3 - Steel Stud Bracket Position Top View

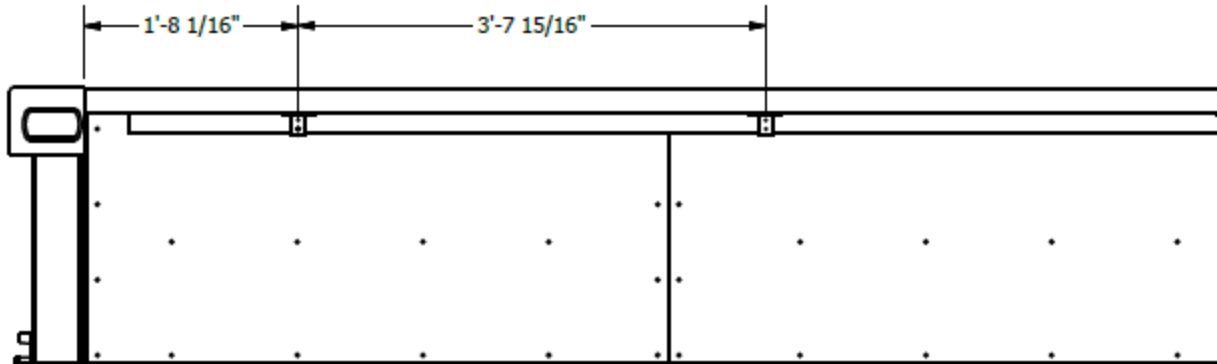

Figure 3.1 - Steel Stud Bracket Position Detail View A

Step 1

Install the “Steel Stud Bracket” to the tubing using No.8 ½” in screw as shown (fig 3). Install the 1st SSB at the 2nd corrugation from the doors and then every 4th corrugation (fig 3.1). Using the No.8 ½” screws and screwdriver/drill, fasten the top track with SSB as shown in the figure. Screw into holes (fig. 4). Install 11 brackets spaced evenly along both sides of the container.

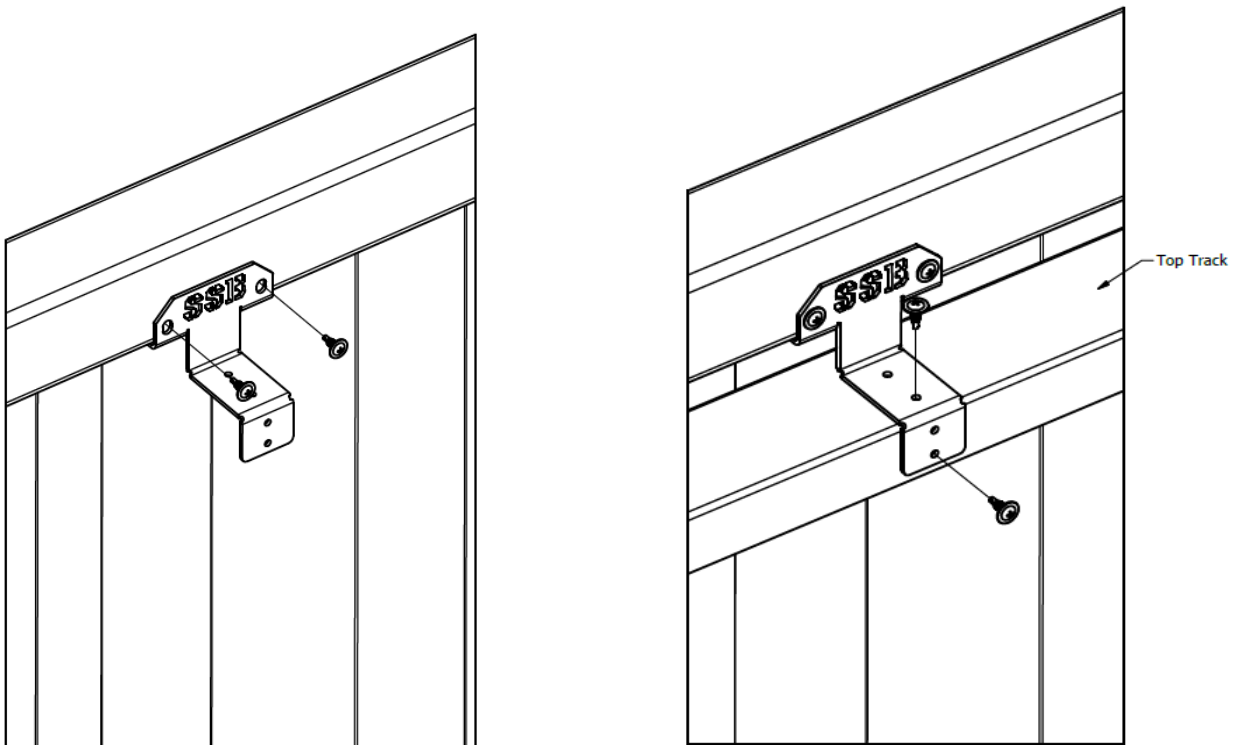
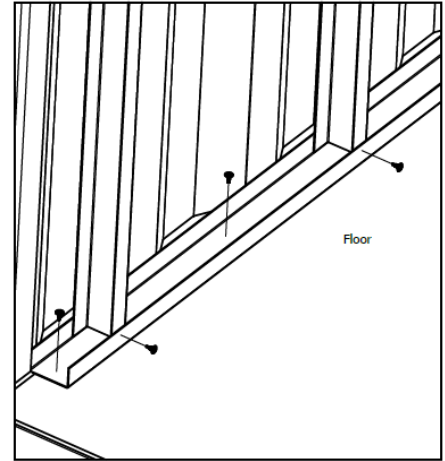

Figure 4 - Steel Stud Bracket & Top Track Installation

Step 2

Install the bottom track to the flooring using No.8 1/2" Screws. (fig. 5)



Step 3

Install the stud every 2nd corrugation starting at the 1st corrugation from the container door side. The center to center distance between each stud should be 22 inches (fig. 6).

Figure 5 - Bottom Track Installation

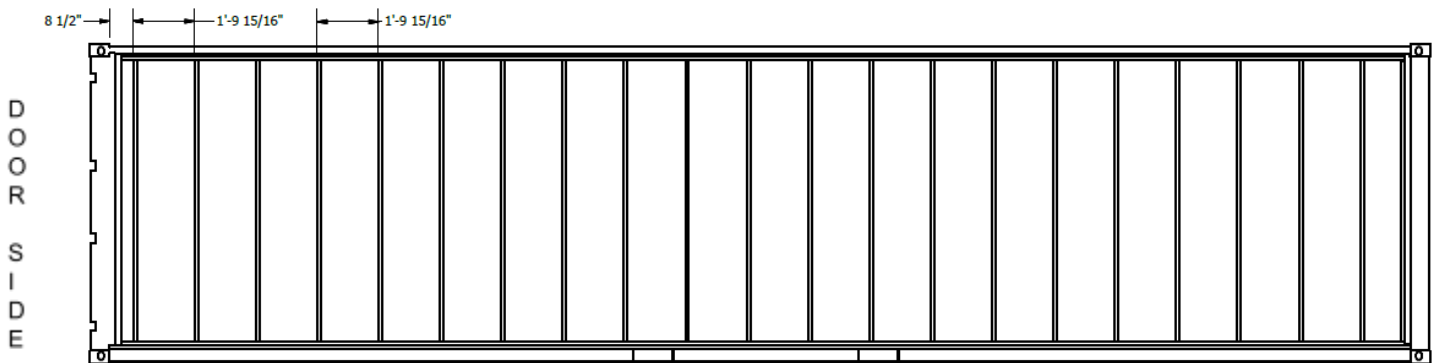

Figure 6 - Side Wall Stud Position