



5KZFP11



KitchenAid







English

FOOD PROCESSOR ACCESSORY KIT INSTRUCTIONS

TABLE OF CONTENTS

This Food Processor Accessory Kit model 5KZFP11 is intended for use with Cook Processor models 5KCF0103 and 5KCF0104 only.

FOOD PROCESSOR SAFETY

- Important safeguards 4
- Electrical equipment waste disposal 6

PARTS AND FEATURES

- Parts and accessories 7
- Food Processor Accessory Kit accessories 8
- Compatible Cook Processor accessories 9

ASSEMBLING THE FOOD PROCESSOR ACCESSORY KIT

- Before first use 10
- Attaching the work bowl 10
- Attaching the work bowl cover 11
- Installing the adjustable slicing disc 11
- Installing the reversible shredding disc 12
- Installing the multipurpose blade, dough blade, or egg whip 12

USING THE FOOD PROCESSOR ACCESSORY KIT

- Using the 2-in-1 feed tube 13
- Processing foods 14
- Food processing tips 15
- Removing processed foods 16

CARE AND CLEANING

- Cleaning the Food Processor Accessory Kit 17

TROUBLESHOOTING 18

For more information, visit our website at:
KitchenAid.com.au

FOOD PROCESSOR SAFETY

Your safety and the safety of others are very important.

We have provided many important safety messages in this manual and on your appliance. Always read and obey all safety messages.



This is the safety alert symbol.

This symbol alerts you to potential hazards that can kill or hurt you and others.

All safety messages will follow the safety alert symbol and either the word "DANGER" or "WARNING." These words mean:



You can be killed or seriously injured if you don't immediately follow instructions.



You can be killed or seriously injured if you don't follow instructions.

All safety messages will tell you what the potential hazard is, tell you how to reduce the chance of injury, and tell you what can happen if the instructions are not followed.

IMPORTANT SAFEGUARDS

When using electrical appliances, basic safety precautions should always be followed, including the following:

1. Read all instructions.
2. To protect against risk of electrical shock, do not put Food Processor in water or other liquid.
3. Be careful if hot liquid is poured into the food processor. Steam can be ejected suddenly.
4. Close supervision is necessary when any appliance is used by or near children.
5. This appliance shall not be used by children. Keep the appliance and its cord out of reach of children.
6. Children shall not play with the appliance.
7. Appliances can be used by persons with reduced physical, sensory or mental capabilities or lack of experience and knowledge if they have been given supervision or instruction concerning use of the appliance in a safe way and if they understand the hazards involved.



FOOD PROCESSOR SAFETY

8. Always disconnect the appliance from the outlet when not in use, before putting on or taking off parts, and before cleaning.
9. Avoid contacting moving parts.
10. Care shall be taken when handling sharp cutting blades, emptying the bowl, and during cleaning.
11. Switch off the appliance and disconnect from supply before changing accessories or approaching parts that move in use.
12. Do not operate any appliance with a damaged cord or plug, or after the appliance malfunctions, or is dropped or damaged in any manner. Return appliance to the nearest Authorized Service Facility for examination, repair, or electrical or mechanical adjustment.
13. The use of attachments not recommended or sold by KitchenAid may cause fire, electric shock, or injury.
14. Do not use outdoors.
15. Do not let cord hang over edge of table or counter.
16. Keep hands and utensils away from moving blades or discs while processing food to reduce the risk of severe injury to persons or damage to the Food Processor. A scraper may be used but must be used only when the Food Processor is not running.
17. Blades are sharp. Handle carefully.
18. To reduce the risk of injury, never place cutting blade or discs on base without first putting bowl properly in place.
19. Be certain cover is securely locked in place before operating appliance.
20. Never feed food by hand. Always use the food pusher.
21. Do not attempt to defeat the cover interlock mechanism.
22. This product is designed for household use only.

SAVE THESE INSTRUCTIONS



FOOD PROCESSOR SAFETY

Electrical equipment waste disposal

Disposal of packing material

The packing material is 100% recyclable and is marked with the recycle symbol . The various parts of the packing must therefore be disposed of responsibly and in full compliance with local authority regulations governing waste disposal.

Scrapping the product

- This appliance is marked in compliance with European Directive 2012/19/EU, Waste Electrical and Electronic Equipment (WEEE).
- By ensuring this product is disposed of correctly, you will help prevent potential negative consequences for the environment and human health, which could otherwise be caused by inappropriate waste handling of this product.

- The symbol  on the product or on the accompanying documentation indicates that it should not be treated as domestic waste but must be taken to an appropriate collection centre for the recycling of electrical and electronic equipment.

For more detailed information about treatment, recovery and recycling of this product, please contact your local city office, your household waste disposal service or the shop where you purchased the product.





PARTS AND FEATURES

Parts and accessories

This Food Processor Accessory Kit model 5KZFP11 is intended for use with Cook Processor models 5KCF0103 and 5KCF0104 only.

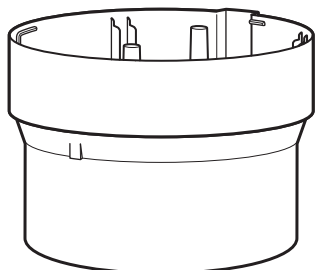
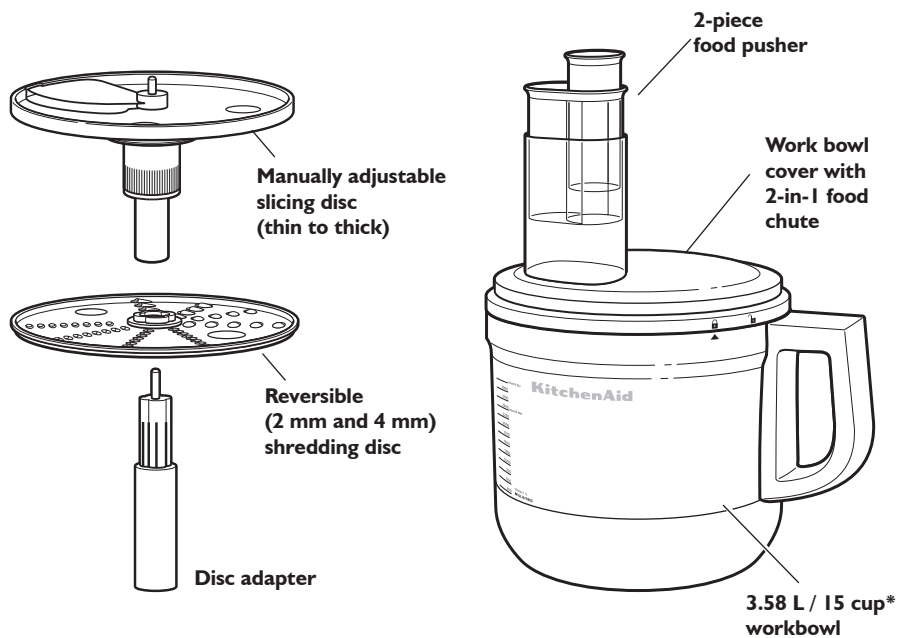

Accessory Storage Case

* Max. capacity for dry ingredients.
Max. capacity for liquid ingredients = 2.5 L



PARTS AND FEATURES

Food Processor Accessory Kit accessories

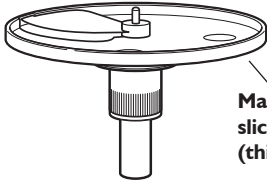



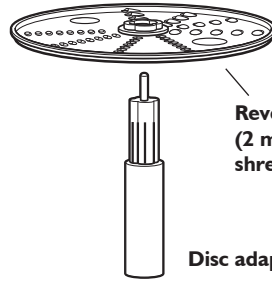

Manually adjustable slicing disc (thin to thick)

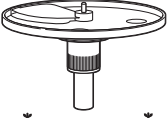
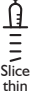

Reversible (2 mm and 4 mm) shredding disc

Disc adapter

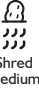
Refer to the guide below for recommended speeds and quantities when using the Food Processor Accessory Kit discs.

Accessory	Food	Speed	Max. Quantity	Operating Time
  Slice thin  Slice thick	Fruit (soft)	8	1.0 kg	40 sec.
	Potatoes	8	1.0 kg	40 sec.
	Tomatoes	8	1.0 kg	30 sec.
	Vegetables (soft)	8	1.0 kg	40 sec.
	Fruit (hard)	8	1.5 kg	30 sec.
	Vegetables (hard)	8	1.0 kg	40 sec.
  Shred medium  Shred fine	Potatoes	9	1.0 kg	34 sec..
	Vegetables (soft)	9	0.5 kg	60 sec.
	Cabbage	9	0.5 kg	60 sec.
	Cheese (cheddar)	9	0.5 kg	10 sec.
	Fruit (hard)	9	1.5 kg	40 sec.
	Vegetables (hard)	9	0.5 kg	60 sec.

PARTS AND FEATURES

Compatible Cook Processor accessories*

Many of the accessories included with the Cook Processor may also be used with the Food Processor Accessory Kit. Refer to the guide below for recommended speeds and quantities for compatible accessories included with the Cook Processor (sold separately).

IMPORTANT: To avoid splashing or excess vibration, always follow recommended speeds shown on the Egg Whip.

English

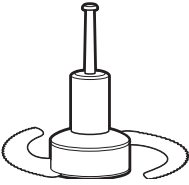
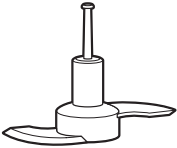
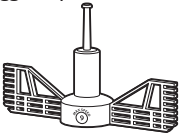
Accessory	Food	Speed	Max. Quantity	Operating Time
	Pureed soups	10	2.5 L	Up to 1 min. for puree†
	Meat (boneless)	10	1.0 kg	Up to 1 min. for puree†
	Fish (boneless)	10	1.0 kg	Up to 1 min. for puree†
	Vegetables	10	1.0 kg	2 min.†
	Compote	10	500 g	30 sec.
	Nuts (almonds, pecans, walnuts, peanuts)	10	700 g	30 sec.
	Bread dough	2	1.2 kg	2–4 min.
	Pastry	5	1.2 kg	2–3.5 min.
	Brioche bread	5	1.2 kg	2–3.5 min.
	Cake batter	6	1.5 L	2 min.
	Crepe batter	8	1.5 L	2 min.
	Egg whites	7–9	8 eggs	5–10 min.
	Mayonnaise, whipped cream	7–9	1.3 L	5–8 min.
	Crèmes, sauces	4–6	1.2 L	5–10 min.

†Cut into 2 cm pieces



ASSEMBLING THE FOOD PROCESSOR ACCESSORY KIT

Before first use

Before using your Food Processor Accessory Kit for the first time, wash all parts and accessories either by hand or in the top rack of the dishwasher (see “Cleaning the Food Processor” section).

NOTE: Your Food Processor is shipped with the accessory storage tray and work bowl cover installed on the work bowl. Remove storage tray before use.

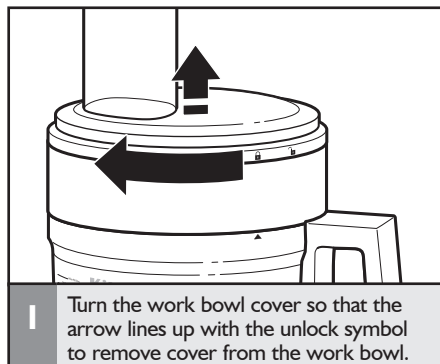

Attaching the work bowl to the Cook Processor (sold separately)

IMPORTANT: Place the Cook Processor on a dry, level countertop with the controls facing forward. Do not plug in the Cook Processor until it is completely assembled.

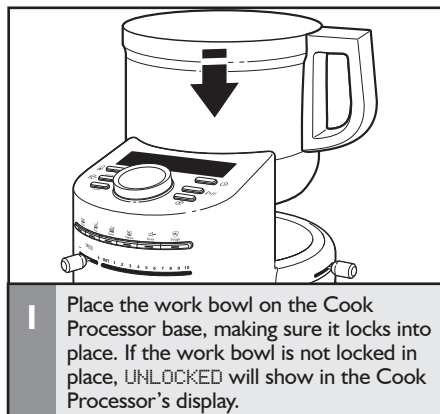



ASSEMBLING THE FOOD PROCESSOR ACCESSORY KIT

Installing the adjustable slicing disc

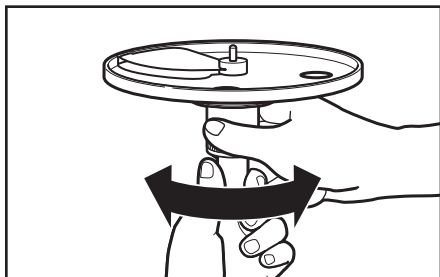

1 Adjust the slicing thickness by holding the drive adapter in one hand and turning the adjustment collar with the other until the desired thickness is set.

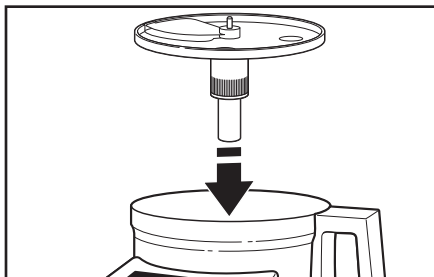

2 Hold the slicing disc by the finger grips and lower it onto the drive shaft. You may need to turn the disc until it drops down into place onto the shaft.

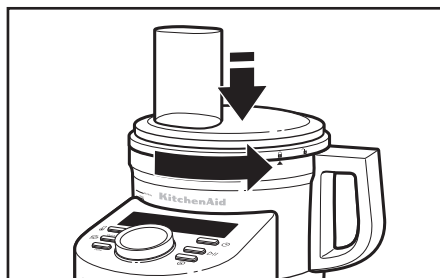

3 Install the work bowl cover, being sure it locks into place.

Installing the reversible shredding disc

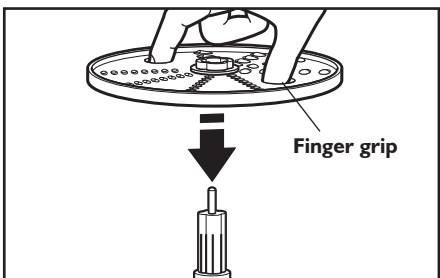

1 Hold the reversible shredding disc by the 2 finger grips with the desired shredding side facing UP. Insert the disc adapter into the hole in the bottom of the disc.

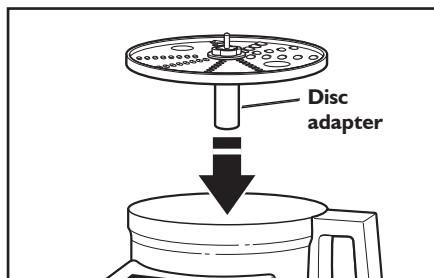

2 With the work bowl installed, slide the disc adapter onto the drive shaft. Then install the work bowl cover, being sure it locks into place.

TIP: You may need to turn the disc/adapter until it drops down into place.





ASSEMBLING THE FOOD PROCESSOR ACCESSORY KIT

Multipurpose blade, dough blade or egg whip

IMPORTANT: The multipurpose blade, dough blade and egg whip are included with the Cook Processor (sold separately) and may be used with the Food Processor Accessory Kit.

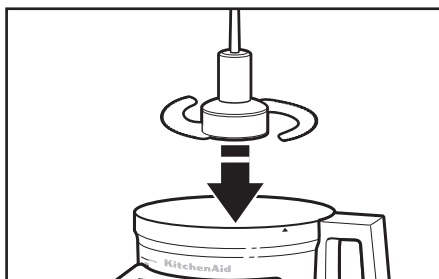

- 1** Place the blade on the power shaft. Rotate the blade so it falls into place on the power shaft.

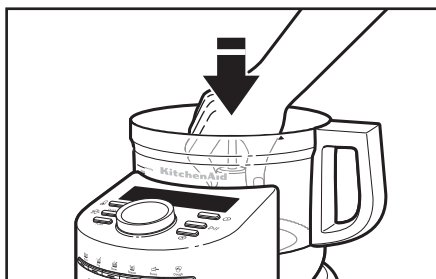

- 2** Push to lock: Press down firmly on the multipurpose blade until it is down as far as it will go.

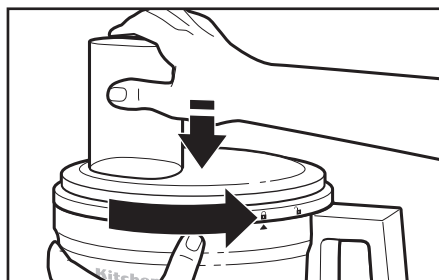

- 3** Install the work bowl cover, being sure it locks into place.

Attaching the work bowl cover

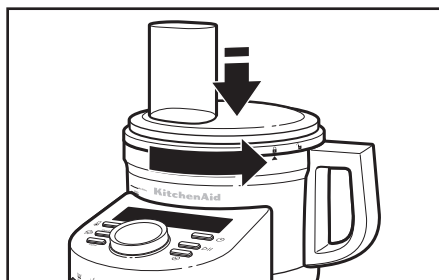

- 1** Place the work bowl cover on the work bowl, aligning the arrow with the unlock symbol. Rotate the cover counterclockwise until it locks into place.

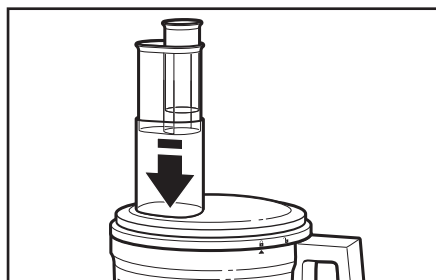

- 2** Fit the food pusher into the 2-in-1 feed tube. See "Using the 2-in-1 Feed Tube" for details on working with different sized foods.

NOTE: Your Food Processor Accessory Kit will not operate unless the work bowl and work bowl cover are properly locked on the base. If the lid is not properly installed, **LID OPEN** will appear in the display.





USING THE FOOD PROCESSOR ACCESSORY KIT

Using the 2-in-1 feed tube

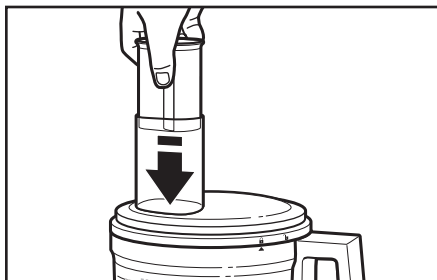

1 Use the entire feed tube and the large food pusher to process large items.

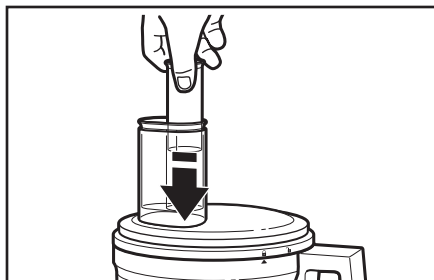

2 Place the large food pusher in the feed tube to process smaller items using the small pusher.

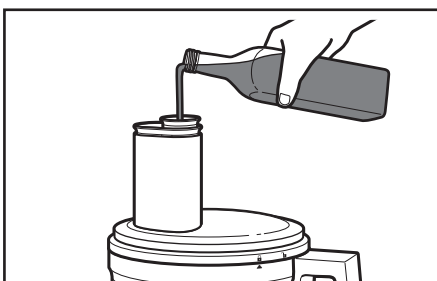

3 Use the drizzle hole in the small food pusher to slowly drizzle oil or other liquid ingredients into the work bowl. The drizzle hole flow rate is ideal for making mayonnaise.

USING THE FOOD PROCESSOR ACCESSORY KIT

Processing Foods

⚠ WARNING



Rotating Blade Hazard
Always use food pusher.
Keep fingers out of openings.
Keep away from children.
Failure to do so can result in amputation or cuts.

Before operating the Food Processor Accessory Kit, be sure the work bowl, blades, and work bowl cover are properly assembled on the Cook Processor base.



This line on the work bowl indicates the maximum level of liquid that can be processed in the work bowl.

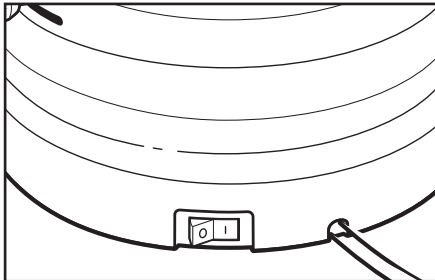

1 Turn on the Cook Processor by setting the main power switch to I (ON).

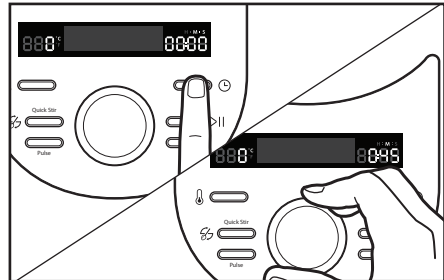

2 Press (Time) and use the dial to set the desired processing time, if desired.

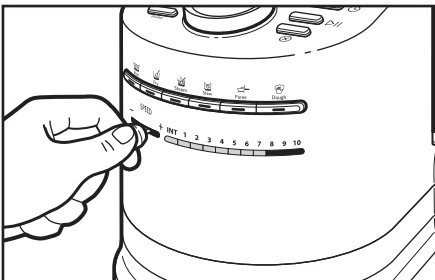

3 Select the recommended processing speed. Press and hold to change speeds more quickly.

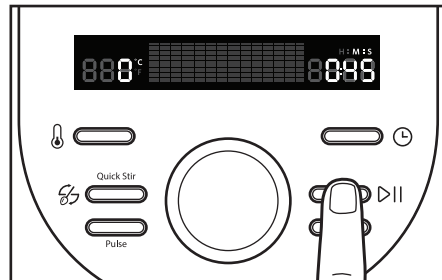

4 Press the (Start) button to turn on the motor and begin the timer countdown (if set).



USING THE FOOD PROCESSOR ACCESSORY KIT

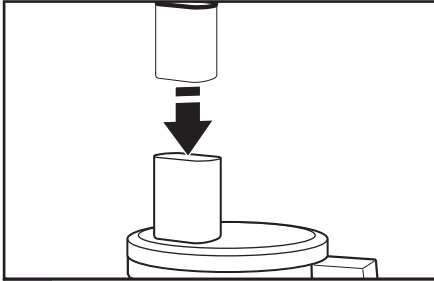

- 5** Feed ingredients into the feed chute using steady pressure. Always use the food pusher to push ingredients.

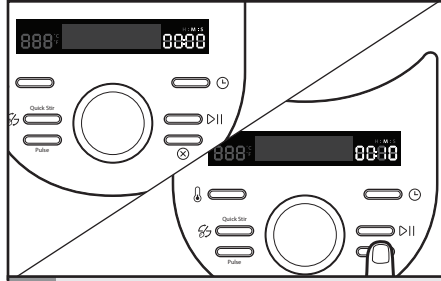

- 6** When the timer reaches 00:00, a tone will sound and the motor will stop. Or press ⊗ (cancel) to stop the motor at any time.

English

Food Processing Tips

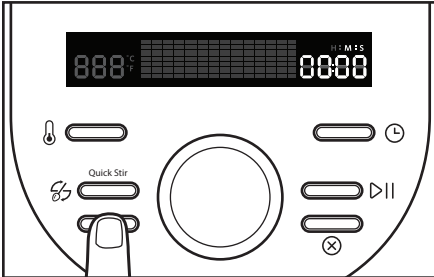

The pulse control allows precise control of the duration of processing. It's great for jobs which require a light touch. Just press and hold the PULSE Button to start processing at high speed, and release it to stop.

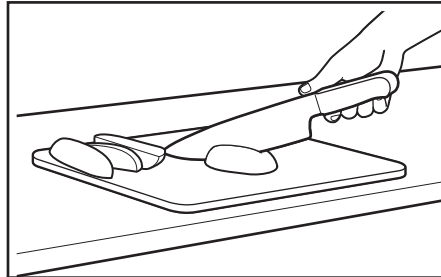

Cut larger foods such as potatoes or cabbage into pieces that will fit easily into the food chute, approximately 4x6 cm.



USING THE FOOD PROCESSOR ACCESSORY KIT

Removing processed foods

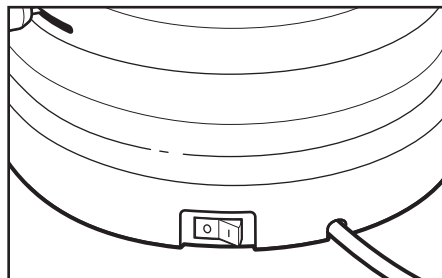

- 1** Set the Cook Processor power switch to O (Off).

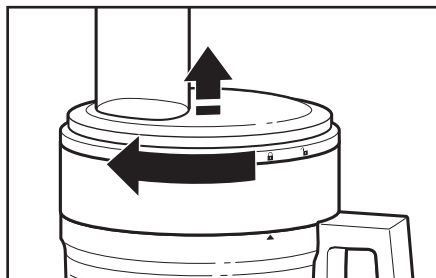

- 2** Turn the work bowl cover so that the arrow points to UNLOCK and remove.

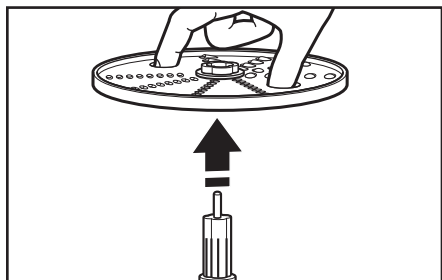

- 3** If using a disc, remove it before removing the bowl. Holding the disc by the 2 finger grips, lift it straight up, then remove the adapter.

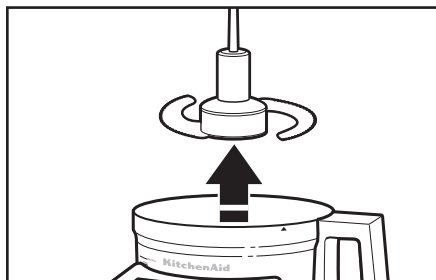

- 4** If using a Cook Processor accessory, lift straight up to remove.

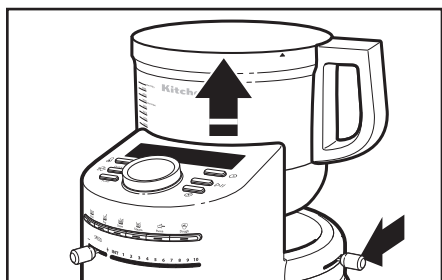

- 5** Press the release lever on the Cook Processor base to unlock the work bowl from the base. Lift to remove.



- 6** Remove food from the bowl with a spatula.





CARE AND CLEANING

Cleaning the Food Processor Accessory Kit

IMPORTANT: These BPA-free bowls require special handling. If you choose to use a dishwasher instead of hand washing, please follow these guidelines.

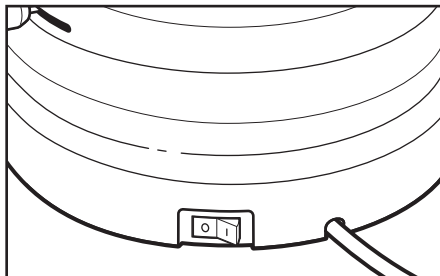

1 Set the Cook Processor power switch to O (Off) and unplug the Cook Processor before cleaning. Refer to the Instructions provided with your Cook Processor for instructions on cleaning the Cook Processor base.

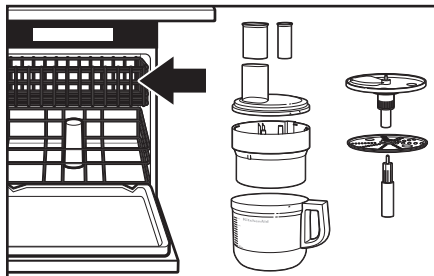

2 All parts are top rack dishwasher safe. Avoid laying the work bowl on its side (see below). Thoroughly dry all parts after washing. Use gentle dishwashing cycles such as normal. Avoid high temperature cycles.

NOTE: If washing the Food Processor Accessory Kit parts by hand, avoid the use of abrasive cleansers or scouring pads. They may scratch or cloud the work bowl and cover.

Storing the Food Processor Accessory Kit

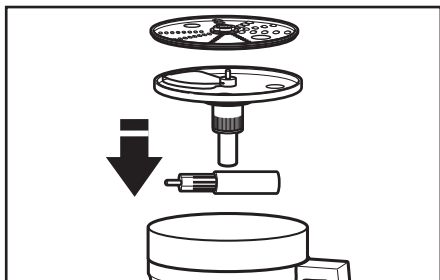

1 Store discs and adapter in storage case as shown. You may need to rotate the adjustable slicing disc until it drops down onto the drive shaft in the bowl.

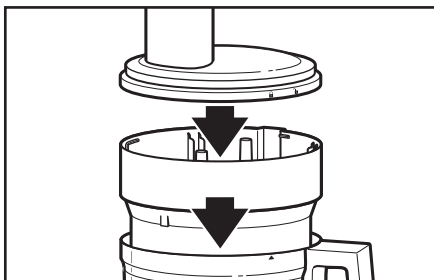

2 Nest the accessory storage tray in the bowl, and install bowl cover.





TROUBLESHOOTING

If your Food Processor Accessory Kit should malfunction or fail to operate, check the following:

- **Display shows UNLOCKED:**
Bowl is not locked into the base correctly. Check the bowl to be sure it is locked into place.
- **Display shows LID OPEN:**
Lid is not locked in place.

Food Processor Accessory Kit doesn't run:

- Make sure that the bowl is fully seated on the Cook Processor base and the lid is properly aligned and locked in place
- Be sure the large food pusher is inserted in the feed tube.
- When using the large feed tube opening, make sure that food is not above the Max. Fill line on the feed tube.
- Have you selected a speed?
- Is the Cook Processor plugged in?
- Is the fuse in the circuit to the Cook Processor in working order? If you have a circuit breaker box, be sure the circuit is closed.
- Unplug the Cook Processor, then plug it back into the outlet.
- If the Cook Processor is not at room temperature, wait until it reaches room temperature and retry.

Food Processor Accessory Kit not shredding or slicing properly:

- Make sure the raised-blade side of the disc is positioned face up on the common adapter.
- If using the adjustable slicing blade, make sure it is set to the correct thickness.
- Make sure ingredients are suitable for slicing or shredding.

If the work bowl cover won't close when using the disc:

- Make sure the disc is installed correctly, with the raised nub on top, and is positioned properly on the drive adapter.

If the problem is not due to one of the above items, see the "Warranty and Service" section.

For information on warranty, please visit kitchenaid.com.au
or kitchenaid.co.nz





English





KitchenAid

© 2016. All rights reserved.
Specifications subject to change without notice.

W10832406A

05/16

